

United States Department of the Interior
National Park Service

National Register of Historic Places Continuation Sheet

Portland Police Block (Boundary Decrease)

Name of Property

Multnomah Co., OR

County and State

85001185

NR Reference Number

Amendment:

Portland Police Block

209 SW Oak Street

Multnomah County, Portland, Oregon

NR# 85001185

The purpose of this continuation sheet is to reduce the boundary of the Portland Police Block nomination by removing the southwestern quarter of the city block, thereby restricting the boundary to the footprint of the 1912 Portland Police Headquarters building and a 1955 addition. The southwestern quarter of the block, which was formerly occupied by a 1944 addition to the 1912 building, is now a vacant lot. The vacant lot does not contribute to the historic and architectural significance of the Portland Police Block. The continuation sheet also provides updated information on the 1955 addition.

The amendments to the Portland Police Block nomination are summarized below:

SECTIONS 1, 2, 5 and 6

Sections 1, 2, 5 and 6 are resubmitted with updated information.

SECTION 7

Section 7 describes the portion of the block that is being deleted from the nomination.

SECTION 8

Section 8 provides background and justification for excluding the vacant lot.

SECTION 10

Section 10 provides locational data for the portion of the block being deleted from the boundary, including a narrative description, acreage, longitude/latitude references and boundary justification.

OTHER DOCUMENTATION

Tax lot map, boundary decrease map, photo key map, and current photographs illustrating the boundary decrease are included in this documentation.

National Register of Historic Places
Date Listed 4-3-2020 Boundary Decrease
NRIS No. RS100004313
Oregon SHPO

United States Department of the Interior
National Park Service

**National Register of Historic Places
Continuation Sheet**

| |
|---|
| Portland Police Block (Boundary Decrease) |
| Name of Property |
| Multnomah Co., OR |
| County and State |
| 85001185 |
| NR Reference Number |

State Agency Certification:

I hereby certify that this additional documentation ___ move ___ removal ___ name change meets the documentation standards for registering properties in the National Register of Historic Places and meets the procedural and professional requirements set forth in 36 CFR Part 60.

Clementine Cuman

2.11.2020

Signature of Certifying Official/Title: Deputy State Historic Preservation Officer

Date of Action

Oregon State Historic Preservation Office
State or Federal agency/bureau or Tribal Government

National Park Service Certification

- I hereby certify that this property is:
- entered in the National Register
 - determined eligible for the National Register
 - determined not eligible for the National Register
 - removed from the National Register
 - additional documentation accepted
 - other (explain:) _____

Signature of the Keeper

Date of Action

United States Department of the Interior
National Park Service

National Register of Historic Places Registration Form

This form is for use in nominating or requesting determinations for individual properties and districts. See instructions in National Register Bulletin, *How to Complete the National Register of Historic Places Registration Form*. If any item does not apply to the property being documented, enter "N/A" for "not applicable." For functions, architectural classification, materials, and areas of significance, enter only categories and subcategories from the instructions. **Place additional certification comments, entries, and narrative items on continuation sheets if needed (NPS Form 10-900a).**

1. Name of Property

historic name Portland Police Block (Boundary Decrease)

other names/site number Portland Police Headquarters

Name of Multiple Property Listing N/A

(Enter "N/A" if property is not part of a multiple property listing)

2. Location

street & number 209 SW Oak Street not for publication

city or town Portland vicinity

state Oregon code OR county Multnomah code 051 zip code 97204

3. State/Federal Agency Certification

As the designated authority under the National Historic Preservation Act, as amended,

I hereby certify that this ___ nomination ___ request for determination of eligibility meets the documentation standards for registering properties in the National Register of Historic Places and meets the procedural and professional requirements set forth in 36 CFR Part 60.

In my opinion, the property ___ meets ___ does not meet the National Register Criteria. I recommend that this property be considered significant at the following level(s) of significance: ___ **national** ___ **statewide** ___ **local**

Applicable National Register Criteria: ___ **A** ___ **B** ___ **C** ___ **D**

Signature of certifying official/Title: Deputy State Historic Preservation Officer Date

Oregon State Historic Preservation Office
State or Federal agency/bureau or Tribal Government

In my opinion, the property ___ meets ___ does not meet the National Register criteria.

Signature of commenting official Date

Title State or Federal agency/bureau or Tribal Government

4. National Park Service Certification

I hereby certify that this property is:

___ entered in the National Register ___ determined eligible for the National Register

___ determined not eligible for the National Register ___ removed from the National Register

___ other (explain:) _____

Signature of the Keeper Date of Action

Portland Police Block (Boundary Decrease)
Name of Property

Multnomah Co., OR
County and State

5. Classification

Ownership of Property
(Check as many boxes as apply.)

Category of Property
(Check only **one** box.)

Number of Resources within Property
(Do not include previously listed resources in the count.)

- private
- public - Local
- public - State
- public - Federal

- building(s)
- district
- site
- structure
- object

| Contributing | Noncontributing | |
|--------------|-----------------|--------------|
| | | buildings |
| | | site |
| | | structure |
| | | object |
| | | Total |

Number of contributing resources previously listed in the National Register

1

6. Function or Use

Historic Functions
(Enter categories from instructions.)

GOVERNMENT/correctional facility

Current Functions
(Enter categories from instructions.)

TRANSPORTATION/road-related
DOMESTIC/multiple dwelling

7. Description

Architectural Classification
(Enter categories from instructions.)

NO STYLE

Materials
(Enter categories from instructions.)

foundation: CONCRETE
walls: CONCRETE; BRICK; STUCCO

roof: SYNTHETICS
other: _____

Portland Police Block (Boundary Decrease)

Name of Property

Multnomah Co., OR

County and State

Narrative Description

(Describe the historic and current physical appearance and condition of the property. Describe contributing and noncontributing resources if applicable. Begin with a **summary paragraph** that briefly describes the general characteristics of the property, such as its location, type, style, method of construction, setting, size, and significant features. Indicate whether the property has historic integrity).

Summary Paragraph

The 1985 Portland Police Headquarters National Register nomination boundary included the entire block bordered by SW 2nd Avenue, SW 3rd Avenue, SW Pine Street and SW Oak Street in Portland, Oregon. The boundary decrease removes the portion of the block bordered by SW 3rd Avenue and SW Oak Street that is outside the footprint of the 1912 Portland Police Headquarters building and 1955 addition. The portion being removed is the southwestern quarter of the block (10,000 square feet), which is a vacant lot that was formerly occupied by a 1944 addition to the Portland Police Headquarters. The 1944 addition was demolished in 2006 and the southwestern quarter of the block is now an unpaved vacant lot surrounded by a metal fence. The 1955 addition was substantially altered in 1998, when it was converted to a parking garage and three stories of apartments added atop the existing structure, leaving portions of the building's metal window frames as the only original exterior materials that remain visible. The 1955 addition remains within the boundary of the Portland Police Block as a noncontributing addition to the 1912 Portland Police Headquarters building.

Narrative Description

The 1985 National Register nomination boundary included the entire block bordered by SW 2nd Avenue, SW 3rd Avenue, SW Pine Street and SW Oak Street in Portland, Oregon. The boundary decrease removes the portion of the block bordered by SW 3rd Avenue and SW Oak Street that is outside the footprint of the 1912 Portland Police Headquarters and 1955 addition. The portion being removed is the southwestern quarter of the block (10,000 square feet), which is a vacant lot that was formerly occupied by a 1944 addition to the Portland Police Headquarters. The northern half of the block (20,000 square feet), which is occupied by a 1955 addition to the Portland Police Headquarters building that has been substantially altered, will remain in the boundary. Both the 1944 and 1955 additions were described in the 1985 National Register nomination as "non-historic additions to the 1912 structure."¹

Southwestern Quarter of Block – Vacant Lot

The vacant lot at the southwestern quarter of the block was formerly occupied by an addition to the Portland Police Headquarters that was designed by architects Jones and Marsh and constructed in 1944.² The reinforced concrete addition featured unclad concrete walls and metal casement windows. The northern 36 feet of this addition were demolished approximately a decade after it was constructed to make way for the 1955 addition, leaving the 1944 addition with a 100' x 100' footprint.³

The 1985 National Register nomination includes several photos depicting the 1944 addition, including:

- Photo 5: view of 1944 addition prior to its partial demolition
- Photo 14: view looking east
- Photo 15: view looking southeast

¹ National Register of Historic Places, Portland Police Block, Portland, Multnomah County, Oregon, National Register # 85001185, Section 7, Page 4.

² *Ibid.*, Section 7, Page 3.

³ *Ibid.*

Portland Police Block (Boundary Decrease)

Name of Property

Multnomah Co., OR

County and State

Based on City of Portland records, this 1944 addition was demolished in 2006. The southwestern quarter of the block is now an unpaved vacant lot surrounded by a metal fence. The lot has been partially excavated, with much of it several feet below grade. (See photos 12, 13 and 14 below.)

Because the 1944 building has been demolished, the southwestern quarter of the block does not contribute to the historic and architectural significance of the 1912 Portland Police Headquarters and is excluded from the revised boundary.

Northern Half of Block – 1955 Addition

The lower two floors and basement of the building that occupies the northern half of the block were constructed in 1955 as an addition to the 1912 Portland Police Headquarters. The steel-frame addition, designed by Portland architects Jacobberger and Stanton, featured unclad concrete walls and steel casement windows.⁴ The building was composed of 8 bays on both the east and west elevations, and 14 bays on the north elevation.

The 1985 National Register nomination includes several images depicting the 1955 addition in its original state, including:

- Photo 7: architectural elevations of the 1955 addition
- Photo 8: view looking south of excavation for 1955 addition
- Photo 15: view looking southeast
- Photos 17, 18: views looking west
- Photo 19: view looking south
- Photo 21: view looking north

The 1955 addition was substantially altered in 1998, when it was converted to a parking garage and three stories of apartments added atop the existing structure.⁵ These upper stories are clad in stucco and feature window bays and balconies that extend beyond the footprint of the 1955 building. (See photos 2, 5, 8 and 9 below.) In conjunction with the addition of three stories, extensive modifications were made to the bottom two stories, including:

- The concrete walls were covered in brick cladding and a stone base.
- First-story windows at (1) the corner of SW Pine Street and SW 2nd Avenue (four bays), (2) SW Pine Street and SW 3rd Avenue (four bays) and (3) the center of the north elevation (2 bays) were replaced with larger fixed metal windows that extend downward to the top of the stone base. (See photos 6, 7 and 8 below.)
- Glazing and muntins were removed from the remaining first-floor windows and all second-floor windows. Metal fencing has been installed behind the original metal frames at these locations. (See photo 4 below.)
- Metal canopies were added at the corners above the enlarged windows. These canopies extend southward to also cover new wall openings on the east and west elevations. (See photo 6 below.)
- East and west elevations:
 - A metal canopy was installed above the entry at the southernmost bay. (See photos 3 and 9 below.)
 - Counting northward, the fifth and sixth ground-floor windows were removed and replaced with a rectangular wall opening providing car access to the garage. (See photos 2 and 10 below.)
- North elevation:
 - The building's main entry in the middle two bays was reconfigured with installation of larger windows, paired doors, and transom with a metal canopy above. (See photo 7 below.)

⁴ Ibid.

⁵ City of Portland Permit Records.

Portland Police Block (Boundary Decrease)
Name of Property

Multnomah Co., OR
County and State

When constructed, the 1955 addition connected to the 1912 building at the basement, first and second floors. The aboveground interior connections are no longer present, with access between the two buildings now limited to a single door at the basement level. (See figure 3 below.)

Portland Police Block (Boundary Decrease)
Name of Property

Multnomah Co., OR
County and State

8. Statement of Significance

Applicable National Register Criteria

(Mark "x" in one or more boxes for the criteria qualifying the property for National Register listing.)

- A Property is associated with events that have made a significant contribution to the broad patterns of our history.
- B Property is associated with the lives of persons significant in our past.
- C Property embodies the distinctive characteristics of a type, period, or method of construction or represents the work of a master, or possesses high artistic values, or represents a significant and distinguishable entity whose components lack individual distinction.
- D Property has yielded, or is likely to yield, information important in prehistory or history.

Criteria Considerations

(Mark "x" in all the boxes that apply.)

Property is:

- A Owned by a religious institution or used for religious purposes.
- B removed from its original location.
- C a birthplace or grave.
- D a cemetery.
- E a reconstructed building, object, or structure.
- F a commemorative property.
- G less than 50 years old or achieving significance within the past 50 years.

Areas of Significance

(Enter categories from instructions.)

POLITICS/GOVERNMENT

ARCHITECTURE

Period of Significance

1912

Significant Dates

N/A

Significant Person

(Complete only if Criterion B is marked above.)

N/A

Cultural Affiliation (if applicable)

N/A

Architect/Builder

Jacobberger and Stanton

Period of Significance (justification) N/A

Criteria Considerations (explanation, if necessary) N/A

Portland Police Block (Boundary Decrease)
Name of Property

Multnomah Co., OR
County and State

Statement of Significance Summary Paragraph (Provide a summary paragraph that includes level of significance, applicable criteria, justification for the period of significance, and any applicable criteria considerations).

The 1985 National Register nomination found the Portland Police Block to be significant under Criterion A for its association with the development of the Police Bureau in the City of Portland and under Criterion C for its association with master architect Emil Schacht, who designed the 1912 building. The portion of the block that is outside the footprint of the 1912 Portland Police Headquarters and 1955 addition is a vacant lot that does not contribute to the historic or architectural significance of the Portland Police Headquarters.

Narrative Statement of Significance (Provide at least **one** paragraph for each area of significance.)

The 1985 National Register nomination found the Portland Police Block to be significant under Criterion A “for its association with the development of the Police Bureau in the City of Portland” and under Criterion C for its association with master architect Emil Schacht, who designed the 1912 building.⁶ The nomination concluded that only the 1912 building was historically significant and the 1944 and 1955 additions were non-contributing:

“The Portland Police Block is a complex of three interconnected, functionally-related buildings occupying an entire city block in Portland, Multnomah County, Oregon. Of the three, only one is historic....the 1944 and 1955 additions are non-contributing.”⁷

Southwestern Quarter of Block – Vacant Lot

The 1944 addition that formerly occupied the southwestern quarter of the block was demolished in 2006.⁸ This quarter of the block is now a vacant lot and as such, does not contribute to the historic or architectural significance of the Portland Police Headquarters.

Northern Half of Block – 1955 Addition

The 1955 addition was extensively altered in 1998 in association with its conversion to a parking garage/apartment building. In addition to increasing the addition’s height by three stories, the building was reclad in brick, all window glazing and muntins removed, several window openings enlarged, all entries replaced, and new entries inserted in place of former windows. As a result, the only exterior materials from the original 1955 addition that are visible are the metal window frames, which have been modified through removal of all associated glazing and muntins. On the interior, the 1955 addition no longer connects to the 1912 building, apart from a single door at the basement level.

⁶ National Register of Historic Places, Portland Police Block, Portland, Multnomah County, Oregon, National Register # 85001185, Section 8, Page 1.

⁷ Ibid.

⁸ City of Portland Permit Records.

Portland Police Block (Boundary Decrease)
Name of Property

Multnomah Co., OR
County and State

9. Major Bibliographical References

Bibliography (Cite the books, articles, and other sources used in preparing this form.)

City of Portland Permit Records, 209 SW Oak Street.

Previous documentation on file (NPS):

- preliminary determination of individual listing (36 CFR 67 has been requested)
- previously listed in the National Register
- previously determined eligible by the National Register
- designated a National Historic Landmark
- recorded by Historic American Buildings Survey # _____
- recorded by Historic American Engineering Record # _____
- recorded by Historic American Landscape Survey # _____

Primary location of additional data:

- State Historic Preservation Office
 - Other State agency
 - Federal agency
 - Local government
 - University
 - Other
- Name of repository: _____

Historic Resources Survey Number (if assigned):

Portland Police Block (Boundary Decrease)
Name of Property

Multnomah Co., OR
County and State

10. Geographical Data

Acreeage of Property Less than one

(Do not include previously listed resource acreage; enter "Less than one" if the acreage is .99 or less)

Latitude/Longitude Coordinates

Datum if other than WGS84: N/A
(enter coordinates to 6 decimal places)

| | | | | | |
|---|-------------------------------|----------------------------------|---|---------------------|----------------------|
| 1 | <u>45.521113°</u> Latitude | <u>-122.673436°</u> Longitude | 3 | <u></u> Latitude | <u></u> Longitude |
| 2 | <u></u> Latitude | <u></u> Longitude | 4 | <u></u> Latitude | <u></u> Longitude |

Verbal Boundary Description (Describe the boundaries of the property.)

The portion being deleted from the nomination consists of the southwestern quarter (10,000 square feet) of the block bordered by SW 2nd Avenue, SW 3rd Avenue, SW Pine Street and SW Oak Street. The southwestern quarter comprises Lots 5 and 6 of Block 30, Portland Addition to the City of Portland, Multnomah County, Oregon.

Boundary Justification (Explain why the boundaries were selected.)

The portion being deleted from the 1985 National Register nomination is a vacant lot that was formerly occupied by a 1944 addition to the Portland Police Headquarters that has been demolished. The vacant lot does not contribute to the historic significance of the Portland Police Headquarters.

11. Form Prepared By

name/title Matthew M. Davis, Principal date 2/26/2019
organization Architectural Resources Group telephone 971-256-5320
street & number 720 SW Washington Street, Suite 300 email m.davis@arg-pnw.com
city or town Portland state OR zip code 97205

Additional Documentation

Submit the following items with the completed form:

- **Regional Location Map**
- **Local Location Map**
- **Tax Lot Map**
- **Site Plan**
- **Floor Plans (As Applicable)**
- **Photo Location Map**

Photographs:

Submit clear and descriptive photographs. The size of each image must be 3000x2000 pixels, at 300 ppi (pixels per inch) or larger. Key all photographs to the sketch map. Each photograph must be numbered and that number must correspond to the photograph number on the photo log.

Portland Police Block (Boundary Decrease)
Name of Property

Multnomah Co., OR
County and State

For simplicity, the name of the photographer, photo date, etc. may be listed once on the photograph log and doesn't need to be labeled on every photograph.

Photo Log

Name of Property: Portland Police Block (Boundary Decrease)
City or Vicinity: Portland
County: Multnomah **State:** Oregon
Photographer: Matthew Davis, Architectural Resources Group
Date Photographed: February 21, 2019

Description of Photograph(s) and number, include description of view indicating direction of camera:

- Photo 1 of 14:** OR_MultnomahCounty_PortlandPoliceBlock(BoundaryDecrease)_0001
Portland Police Headquarters, South (Front) and East Elevations, Looking Northwest
- Photo 2 of 14:** OR_MultnomahCounty_PortlandPoliceBlock(BoundaryDecrease)_0002
East Elevation, Looking West
- Photo 3 of 14:** OR_MultnomahCounty_PortlandPoliceBlock(BoundaryDecrease)_0003
Entry at Southernmost Bay of East Elevation, Looking West
- Photo 4 of 14:** OR_MultnomahCounty_PortlandPoliceBlock(BoundaryDecrease)_0004
Detail of Second-story Window, East Elevation, Looking West
- Photo 5 of 14:** OR_MultnomahCounty_PortlandPoliceBlock(BoundaryDecrease)_0005
East and North Elevations, Looking Southwest
- Photo 6 of 14:** OR_MultnomahCounty_PortlandPoliceBlock(BoundaryDecrease)_0006
Enlarged Windows at Northeast Corner, Looking Southwest
- Photo 7 of 14:** OR_MultnomahCounty_PortlandPoliceBlock(BoundaryDecrease)_0007
Entry at North Elevation, Looking South
- Photo 8 of 14:** OR_MultnomahCounty_PortlandPoliceBlock(BoundaryDecrease)_0008
North and West Elevations, Looking Southeast
- Photo 9 of 14:** OR_MultnomahCounty_PortlandPoliceBlock(BoundaryDecrease)_0009
West Elevation, Looking East
- Photo 10 of 14:** OR_MultnomahCounty_PortlandPoliceBlock(BoundaryDecrease)_0010
Non-original Entry, West Elevation, Looking East
- Photo 11 of 14:** OR_MultnomahCounty_PortlandPoliceBlock(BoundaryDecrease)_0011
West and South Elevations, Looking Northeast
- Photo 12 of 14:** OR_MultnomahCounty_PortlandPoliceBlock(BoundaryDecrease)_0012
1955/1998 Addition (Left) and Portland Police Headquarters (Right), Looking Northeast

Portland Police Block (Boundary Decrease)
Name of Property

Multnomah Co., OR
County and State

Photo 13 of 14: OR_MultnomahCounty_PortlandPoliceBlock(BoundaryDecrease)_0013
Vacant Lot at Southwest Corner of Block, Looking East

Photo 14 of 14: OR_MultnomahCounty_PortlandPoliceBlock(BoundaryDecrease)_0014
Vacant Lot at Southwest Corner of Block, Looking North

Paperwork Reduction Act Statement: This information is being collected for applications to the National Register of Historic Places to nominate properties for listing or determine eligibility for listing, to list properties, and to amend existing listings. Response to this request is required to obtain a benefit in accordance with the National Historic Preservation Act, as amended (16 U.S.C.460 et seq.).

Estimated Burden Statement: Public reporting burden for this form is estimated to average 100 hours per response including time for reviewing instructions, gathering and maintaining data, and completing and reviewing the form. Direct comments regarding this burden estimate or any aspect of this form to the Office of Planning and Performance Management, U.S. Dept. of the Interior, 1849 C. Street, NW, Washington, DC.

Portland Police Block (Boundary Decrease)
Name of Property

Multnomah Co., OR
County and State

Photo Location Map

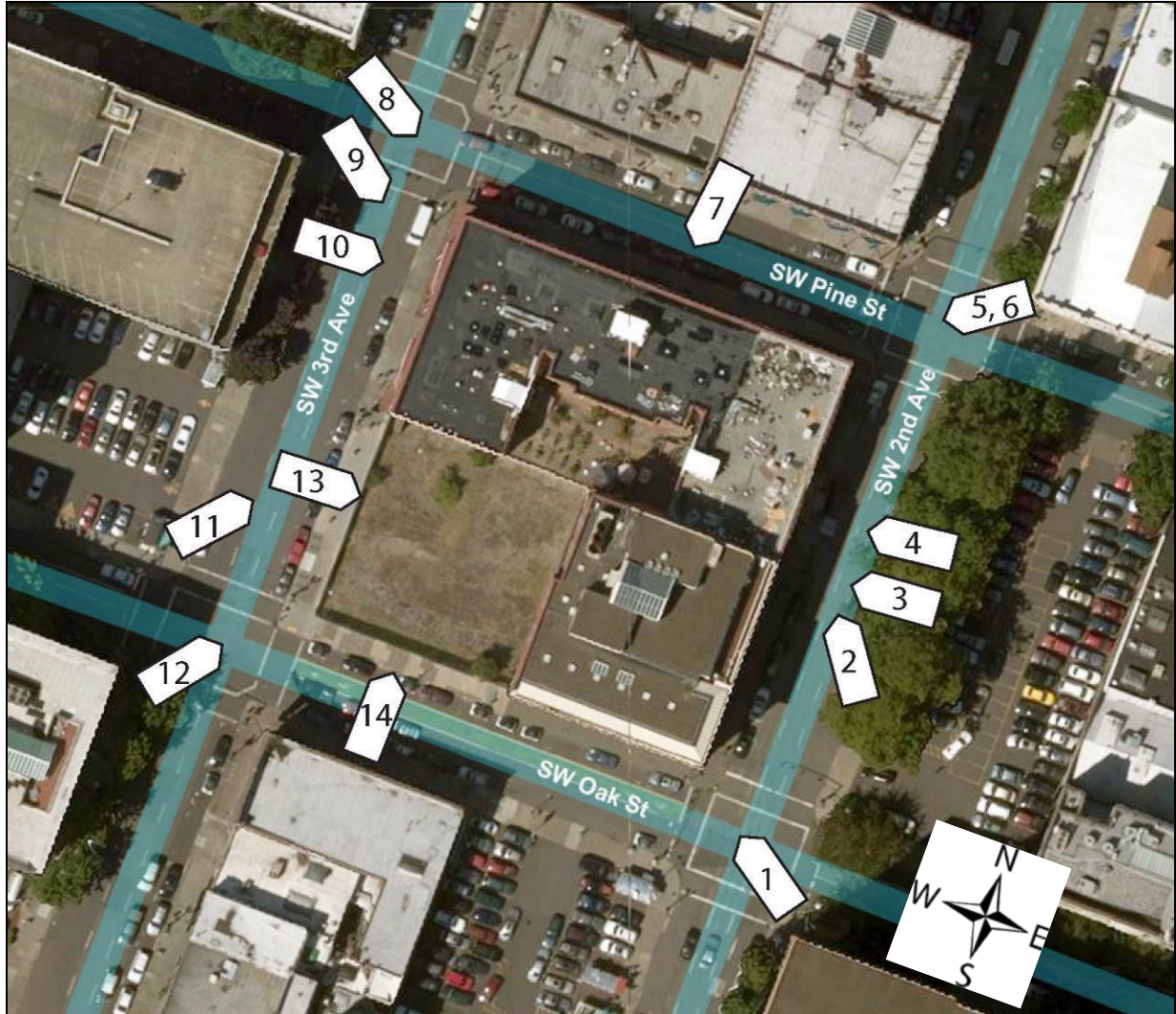

United States Department of the Interior
National Park Service

National Register of Historic Places Continuation Sheet

| |
|--|
| Portland Police Block (Boundary Reduction) |
| Name of Property |
| Multnomah Co., OR |
| County and State |
| N/A |
| Name of multiple listing (if applicable) |

Section number Additional Documentation Page 13

List of Figures

(Resize, compact, and paste images of maps and historic documents in this section. Place captions, with figure numbers above each image. Orient maps so that north is at the top of the page, all document should be inserted with the top toward the top of the page.

Figure 1: Tax Lot Map

Figure 2: Boundary Decrease Map

Figure 3: Basement Floor Plan, 1955 Addition (1996)

United States Department of the Interior
National Park Service

National Register of Historic Places Continuation Sheet

| |
|--|
| Portland Police Block (Boundary Reduction) |
| Name of Property |
| Multnomah Co., OR |
| County and State |
| N/A |
| Name of multiple listing (if applicable) |

Section number Additional Documentation Page 14

Figure 1: Tax Lot Map

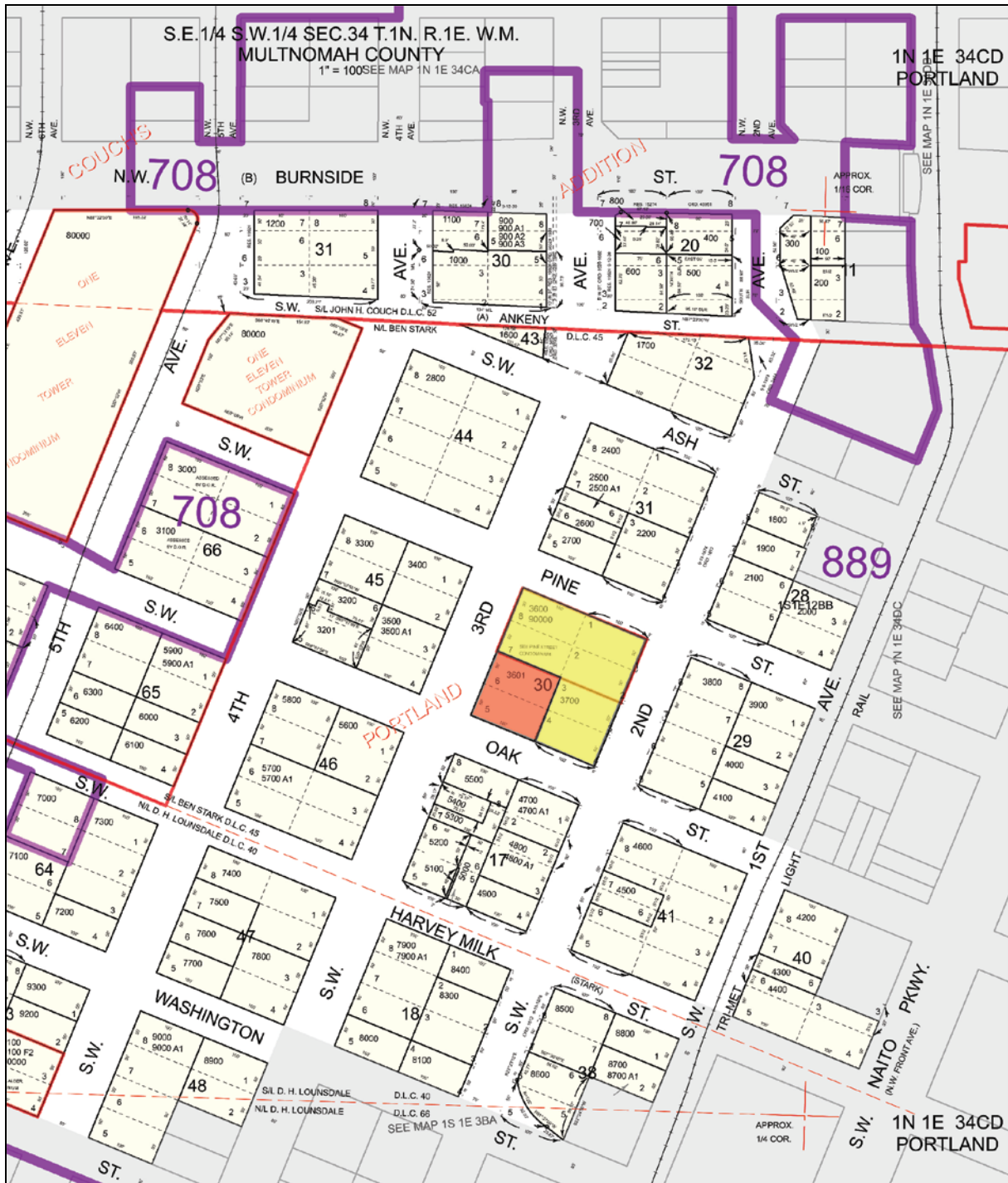

United States Department of the Interior
National Park Service

National Register of Historic Places Continuation Sheet

Section number Additional Documentation

Page 15

| |
|--|
| Portland Police Block (Boundary Reduction) |
| Name of Property |
| Multnomah Co., OR |
| County and State |
| N/A |
| Name of multiple listing (if applicable) |

Figure 2: Boundary Decrease Map



United States Department of the Interior
National Park Service

National Register of Historic Places Continuation Sheet

Section number Additional Documentation Page 16

| |
|--|
| Portland Police Block (Boundary Reduction) |
| Name of Property |
| Multnomah Co., OR |
| County and State |
| N/A |
| Name of multiple listing (if applicable) |

Figure 3: Basement Floor Plan, 1955 Addition (William Wilson Architects, 1996). Following the 1998 conversion of the 1955 addition to a parking garage/apartment building, the lone remaining internal connection between the 1955 addition and the 1912 Portland Police Headquarters is a single basement door near the middle of the wall separating the two buildings (identified with a red arrow).

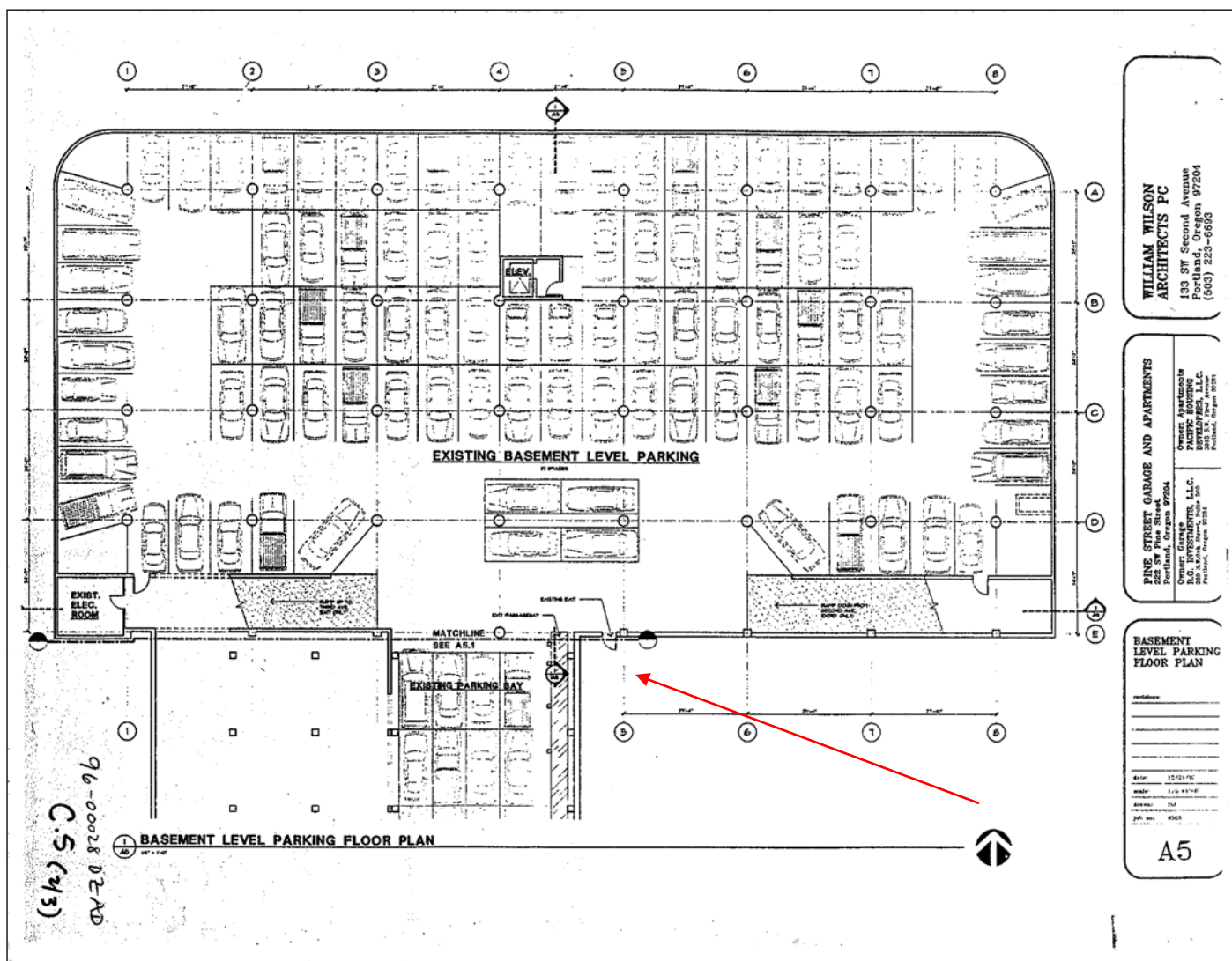

Portland Police Block (Boundary Reduction)
Multnomah County: OR



Photo 1 of 14: OR_MultnomahCounty_PortlandPoliceBlock(BoundaryDecrease)_0001
Portland Police Headquarters, South (Front) and East Elevations, Looking Northwest



Photo 2 of 14: OR_MultnomahCounty_PortlandPoliceBlock(BoundaryDecrease)_0002
East Elevation, Looking West

**Portland Police Block (Boundary Reduction)
Multnomah County: OR**



Photo 3 of 14: OR_MultnomahCounty_PortlandPoliceBlock(BoundaryDecrease)_0003
Entry at Southernmost Bay of East Elevation, Looking West



Photo 4 of 14: OR_MultnomahCounty_PortlandPoliceBlock(BoundaryDecrease)_0004
Detail of Second-story Window, East Elevation, Looking West

Portland Police Block (Boundary Reduction)
Multnomah County: OR



Photo 5 of 14: OR_MultnomahCounty_PortlandPoliceBlock(BoundaryDecrease)_0005
East and North Elevations, Looking Southwest



Photo 6 of 14: OR_MultnomahCounty_PortlandPoliceBlock(BoundaryDecrease)_0006
Enlarged Windows at Northeast Corner, Looking Southwest

**Portland Police Block (Boundary Reduction)
Multnomah County: OR**



Photo 7 of 14: OR_MultnomahCounty_PortlandPoliceBlock(BoundaryDecrease)_0007
Entry at North Elevation, Looking South



Photo 8 of 14: OR_MultnomahCounty_PortlandPoliceBlock(BoundaryDecrease)_0008
North and West Elevations, Looking Southeast

Portland Police Block (Boundary Reduction)
Multnomah County: OR



Photo 9 of 14: OR_MultnomahCounty_PortlandPoliceBlock(BoundaryDecrease)_0009
West Elevation, Looking East



Photo 10 of 14: OR_MultnomahCounty_PortlandPoliceBlock(BoundaryDecrease)_0010
Non-original Entry, West Elevation, Looking East

**Portland Police Block (Boundary Reduction)
Multnomah County: OR**



Photo 11 of 14: OR_MultnomahCounty_PortlandPoliceBlock(BoundaryDecrease)_0011
West and South Elevations, Looking Northeast



Photo 12 of 14: OR_MultnomahCounty_PortlandPoliceBlock(BoundaryDecrease)_0012
1955/1998 Addition (Left) and Portland Police Headquarters (Right), Looking Northeast

Portland Police Block (Boundary Reduction)
Multnomah County: OR



Photo 13 of 14: OR_MultnomahCounty_PortlandPoliceBlock(BoundaryDecrease)_0013
Vacant Lot at Southwest Corner of Block, Looking East



Photo 14 of 14: OR_MultnomahCounty_PortlandPoliceBlock(BoundaryDecrease)_0014
Vacant Lot at Southwest Corner of Block, Looking North