

CURR. HIST. STATUS:

RANKING: Primary
NEIGHBORHOOD: DNTN
TYPE: Building

OREGON CULTURAL RESOURCE INVENTORY
CITY OF EUGENE

FINAN. STATUS:

HISTORIC NAME: SMEEDE HOTEL
COMMON NAME: SMEEDE HOTEL BLDG.
ADDRESS: 0767 WILLAMETTE ST
EARLY AD: 0
OWNER: USP Co. etal
ADDR: 767 Willamette # 206
Eugene, OR. 97401
T/R/S# 17 3 31 NE 1/4 NE 1/4
MAP NO.: 17033111 TAXLOT: 9200
ADD: Skinners Donation BLK: 8 LOT: 6
ZONING: Historic District

DATE OF CONSTRUCTION: 1884
ORIGINAL USE: Hotel-Motel
PRESENT USE: Retail Store
DATE:
ARCH./BLDR.: George Park
ARCH./STYLE: Italianate
000
INTEGRITY: Virtually intact
THEME: 5 000
PROP. GROUP: WILLA /TH/004
#STORIES: 3.0 BASEMENT (Y/N/?): Y

PLAN SHAPE: rect.

FOUNDATION MATERIAL: rubble stone

ROOF FORM & MATERIALS: built-up/flat

WALL CONSTRUCTION: brk.

STRUCTURAL FRAME: brk.

PRIMARY WINDOW TYPE: 2/2 d.h. wd.

EXT. SURFACING MATERIALS: brk./stucco

DECORATIVE FEATURES: 5 bay facade w/windows w/arched heads (elliptic arch

OTHER: heads on side elevations)

CONDITION: Excellent

MOVED: N DATE MOVED:

EXT. ALTERATIONS/ADDITIONS(DATED): Ext. stuccoed, cast iron corn. pilaster, metal cornice & bracketed pediment(1892); btwn 1895 & 1902 rear addit.
NOTEWORTHY LANDSCAPE FEATURES: orig. name of hotel, Baker's Hotel, imbedded in sidewalk

ASSOCIATED STRUCTURES:

KNOWN ARCHAEOLOGICAL FEATURES:

GEOG. LOC. & IMMED. SETTING: E. side of Willamette btwn. 7th & 8th in center of Comm. area, flat

PHYSICAL DESCRIPTION: This 3 story Italianate style building is listed on the National Register and has been designated a City Landmark (see related files). It is located mid-block, in a commercial area near the center of downtown. The building is in excellent condition and is virtually intact. The building has a rectangular plan with a rubble stone foundation and brick walls. The roof is a built up and flat, while the primary window type is two over two double hung wood. The exterior surface is brick and stucco.

SOURCES: Related National Register and City Landmark files.

ROLL NO.: 20
NEGATIVE NO.: 021
SLIDE ROLL#: 000
SLIDE NO.: 000000

RECORDED BY: C. Taylor
RESEARCHED BY:
DATE RECORDED: 07/15/1990
FIELD INVENTORY NO.: 00000
STATE INVENTORY NO.: 2414

SHPO 2380

OREGON CULTURAL RESOURCE INVENTORY
CITY OF EUGENE

HISTORIC NAME: SMEEDE HOTEL T/R/S# 17 3 31 NE 1/4 NE 1/4
ADDRESS: 0767 WILLAMETTE ST TAXLOT: 9200

STATEMENT OF SIGNIFICANCE

Smeede Hotel
767 Willamette Street

The Smeede Hotel, constructed in 1884-85, is the oldest known surviving brick hotel in Lane County. George H. Park a local builder-contractor, supervised the construction of the hotel for Charles Baker, a local businessman. Baker sold the hotel prior to its completion to Stephen Smeede for \$12,000. Smeede retained the Baker Hotel name until 1892, when he remodeled the exterior and changed the name to Hotel Eugene.

The hotel came to be associated with the ultimate in social life and culture in early Eugene. Upper-class visitors and wealthy citizens were attracted to the hotel's sumptuous furnishings and facilities as well as to its exotic and expensive menus. Presidential candidate William Jennings Bryan stayed at the Smeede while campaigning in Oregon, and in 1902 the hotel hosted a banquet for H.B. Miller, Consul to Niu Chwang, China.

By the end of the 19th century, Eugene's Willamette Street was a bustling commercial center, offering the most sophisticated buildings in the County. Over the years, most of these structures have been demolished. The Smeede Hotel represents one of the few remaining links between old Willamette Street and modern Eugene.

(Sources: National Historic Register Nomination and City Landmark files)

OREGON CULTURAL RESOURCE INVENTORY
CITY OF EUGENE

HISTORIC NAME: SMEEDE HOTEL
ADDRESS: 0767 WILLAMETTE

T/R/S# 17 3 31 NE 1/4 NE 1/4
ST TAXLOT: 9200



ROLL NO: 20
NEGATIVE NO.: 021

SLIDE ROLL NO: 016
SLIDE NO. 000008

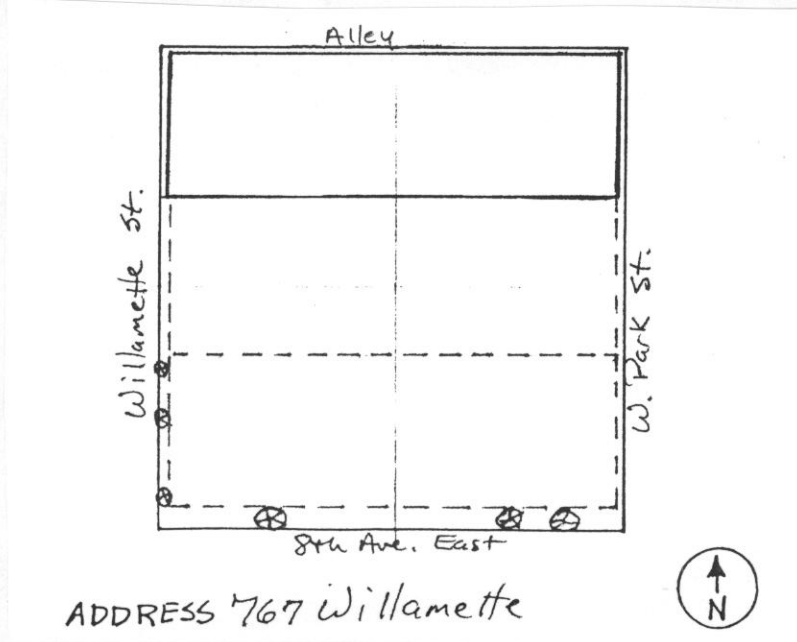

SITE PLAN DRAWN BY:
GRAPHIC & PHOTO SOURCES:

FIELD SURVEY NO: 00000
STATE INVENTORY NO: 0

DOWNTOWN CULTURAL RESOURCES SURVEY AND INVENTORY EVALUATION CRITERIA, 1991

ADDRESS: 767 Willamette St. INVENTORY NUMBER: _____
 MAP/TAX LOT #: 17033111/9200 TOTAL SCORE: _____ FINAL RANKING: P S C NC

Please rank properties using a numerical ranking of 0-5. 0 = Does not meet criteria; 1 = Low merit under this criteria; 2 = Some merit under this criteria; 3 = Average merit under this criteria; 4 = Strong merit under this criteria; 5 = Very Strong merit under this criteria.

CRITERIA	RANKING
1. Association with historic or famous events.	_____
2. Antiquity.	_____
3. Unique architectural merit because: (There are only a total of 5 points allowed for all parts of #3.)	_____
a. Representative character of a period or style of architecture or method of construction;	_____
b. Extraordinary or unusual design, detail, use of materials or craftsmanship;	_____
c. Identification as the work of an architect, designer, or master builder whose individual work has influenced development in the nation, state, or community.	_____
4. Relationship to the broad cultural history of the nation, state or community.	_____
5. Identification with a person or persons who have significantly contributed to the history of the nation, state, or community.	_____
6. Identification as a unique object representing an aesthetic or educational feature of the community.	_____

LEVEL OF INTEGRITY: _____

LANDMARK STATUS: National Register and City landmark

Evaluator ec [signature] Date 8/7/91