

OREGON INVENTORY OF HISTORIC PROPERTY
ELLIS LAWRENCE BUILDING INVENTORY
COUNTY: Multnomah

HISTORIC NAME: STRONG, MRS. CURTIS, HOUSE

COMMON NAME:
OTHER NAMES: Wheeler, L.R., House

CITY: Portland Oregon
STREET: 2241 SW Montgomery
OWNER: Dickson, Russell
319 SW Washington, Portland OR, 97204

TOWNSHIP: 01S RANGE: 01E SECTION: 09
MAP#: 3227 TAX LOT: 01-01-09-

ADDITION: Carter's ORIGINAL USE: residence
BLOCK: 076 LOT: 6-8 QUAD: Portland PRESENT USE: residence
ASSESSOR #: R-14040-5310 SITE: 0.2 acres, approx.
THEMES: 20C Architecture, Medicine

RESOURCE TYPE: Building
STATUS: built & survives
LAWRENCE
(JOB#) YEAR: (0224) 1912
(JOB#) YEAR: ()
(JOB#) YEAR: ()
FIRST DATE: Febr. 1912
DESIGN BEG:
DESIGN END:
CONSTR BEG:
CONSTR END:
LOSS DATE:

DATA BELOW IS ON LAWRENCE FIRM'S DESIGN AS-BUILT:

ARCHITECT: Ellis F. Lawrence, Architect CHIEF DESIGNER: E F Lawrence
ENGINEERS & CONSULTANTS:

CONTRACTORS:

ARTISTS & CRAFTSMEN:

STYLE: Arts & Crafts
PLAN TYPE/SHAPE: rectangular (front long) +side wing
FOUNDATION MATERIAL: concrete STORIES: 2 BASEMENT: yes
ROOF/MATERIAL: hipped gable w/shed dormer(s)/Comp. shingles
WALL CONSTR: nailed wood frame STRUC.FRAME: nailed wood frame
PRIME WINDOW TYPE: wood group.multi-pane casement
EXTERIOR SURFACE MATERIAL: wood shingles,
DECORATIVE FEATURES/MATERIALS:
Eyebrow arches over front entrance; classical details on portico

OTHER:

Alterations: pantry and deck on west side, tin deck for roof, family rm (1924);
moved doorway and windows, closed in porch (1927); installed tub (1940)

CONDITION: good

MOVED: not moved

ALTERATIONS/ADDITIONS (dated):

Repair cracks, level house (1956); addition to kitchen, family rm, bedroom,
replaced garage w/2 car gar. by Allen, McMath, Hawkins Archt's (1981)

LANDSCAPE FEATURES:

Overgrown landscaping

541

ELLIS LAWRENCE BUILDING INVENTORY

HISTORIC NAME: STRONG, MRS. CURTIS, HOUSE

ASSOCIATED STRUCTURES:

Attached garage

SETTING:

Urban residential; faces east onto Montgomery Dr. in secluded setting; rear faces west on steep slope with view of hills and forest

SIGNIFICANCE OF LAWRENCE FIRM'S DESIGN:

EXTER.DETAILS/CRAFTSMANSHIP: Better than average workmanship and materials.

INTER.DETAILS/CRAFTSMANSHIP: Better than average workmanship and materials.

EXTERIOR INTEGRITY: Moderate changes; some original character remains.

INTERIOR INTEGRITY: Unknown.

SITE INTEGRITY: Minor changes, but original character intact.

SETTING INTEGR: Historic character & relationship of surroundings is intact.

SIGNIFICANCE STATEMENT:

This house is primarily significant for its architectural design. It was featured in THE HOUSE BEAUTIFUL as an excellent example of a small house plan on a difficult site. This article published in 1916, resulted in many letters pouring into Lawrence's office requesting copies of plans. He refused to reproduce them however. In 1919, the house won a local AIA award for small houses.

SOURCES/DOCUMENTS: Description (Location)

Exhibit Quality, full set of blueprints, E. Lawrence Collection U of O;
Multnomah County Tax Assessor Records.

Oregon Biographical Index (OHS); Polk's Portland City Directory; Portland Historic Resource Inventory; Portland Building Permits

sources consulted, no info. located: Oregon Historic Photo Collection (OHS)

PUBLICATIONS:

"A Cottage in the City." HOUSE BEAUTIFUL. Jan. 1916. pp 40-41. PACIFIC COAST ARCHITECT. Vol 2 #6, March 1912. p.228. PORTLAND ARCHITECTURAL CLUB. 1913

SLIDE NO.:

SHPO INVENTORY NO.:

5411

RESEARCH BY: K. Lakin

RECORDED BY: K. Lakin

DATE: 02/16/88

DATE: 07/11/88

5411

ELLIS LAWRENCE BUILDING SURVEY
 HISTORIC NAME: STRONG, MRS. CURTIS, HOUSE

RECENT PHOTO
 NEGATIVE #s:
 KLR4, #10

First # above
 is upper-right
 photo; second #
 is just below.
 If no # above,
 see sources at
 bottom of page.

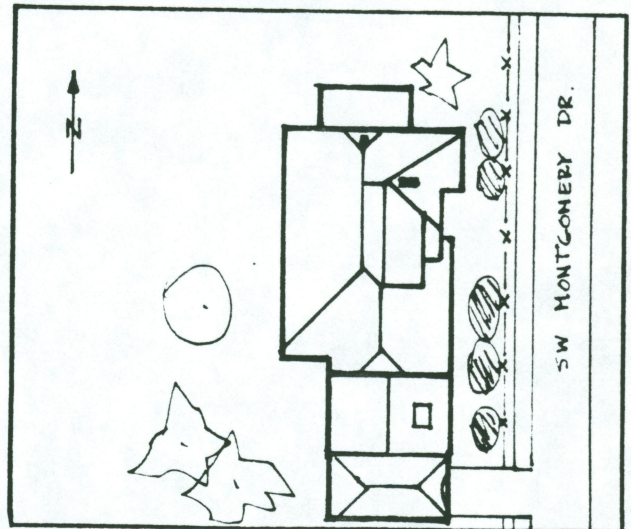
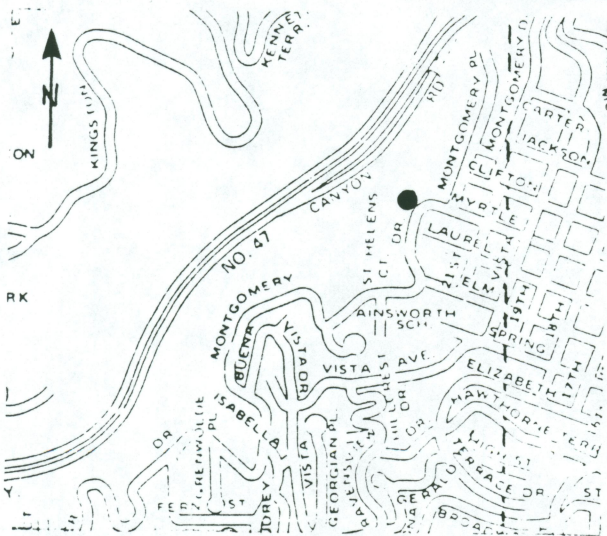

HISTORIC PHOTO/OTHER GRAPHIC SOURCE: K.Lakin and S. Doovan
 Lawrence Col. photos (UO Library)

5411

OREGON INVENTORY OF HISTORIC PROPERTY
ELLIS LAWRENCE BUILDING INVENTORY

E V A L U A T I O N

HISTORIC NAME: STRONG, MRS. CURTIS, HOUSE

<u>INTEGRITY OF:</u>	<u>NUMERICAL</u>
1. EXTERIOR: Moderate changes; some original character remains.	3
2. INTERIOR: Moderate changes; some original character remains.	3
3. SITE: Minor changes, but original character intact.	7
4. SETTING: Historic character & relationship of surroundings is intact.	5
INTEGRITY TOTAL	18

<u>DISTINCTION OF:</u>	
1. EXTERIOR DETAILS & CRAFTSMANSHIP: Better than average workmanship and materials.	3
2. INTERIOR DETAILS & CRAFTSMANSHIP: Better than average workmanship and materials.	3
3. STYLE: (Arts & Crafts) It is a prime example of its identified style. Compared to Lawrence's other surviving Oregon buildings, this style is one of several (6 or more) in its city/town or rural area.	5
4. ORIGINAL USE: (residence) Compared to Lawrence's other surviving Oregon buildings, this use is one of several (6 or more) in its city/town or rural area.	0
5. ARCHITECTURAL DESIGN: Compared to Lawrence's other surviving Oregon buildings, this design is above average quality, published, & of national significance Is it part of an ensemble of surviving buildings by Lawrence? Lawrence building(s) nearby; but arrangement is not ordered. Are structural or technical aspects of the design significant? Of moderate significance.	7
6. LAWRENCE'S PERSONAL INVOLVEMENT IN THE DESIGN PROCESS: Lawrence is known to have been the chief designer.	5
DISTINCTION TOTAL	37

<u>EDUCATIVE OR ASSOCIATIVE VALUE:</u>	
1. HISTORIC EVENTS OR ACTIVITIES: No known association with historic events or activities.	0
2. HISTORIC PERSONS: No known association with a significant historic person.	0
3. SYMBOLIC ASSOCIATION WITH AN IDEAL, INSTITUTION, OR POLITICAL ENTITY: Major symbolic association with local ideal or institution.	5
EDUCATIVE OR ASSOCIATIVE TOTAL	5
GRAND TOTAL	60
RANK:	PRIMARY

NOTE: Only the built, surviving buildings in Oregon were evaluated.

5411