

CITY OF GRESHAM
OREGON INVENTORY OF HISTORIC PROPERTIES
HISTORIC RESOURCE SURVEY FORM

HIST. NAME: First Bethel Baptist Church DATE OF CONSTRUCTION: ca 1886
COMMON NAME: ORIGINAL USE : church
ADDRESS: 101 S Main Avenue (Main City Park)
OWNER: Gresham Historical Society
101 S Main Gresham PRESENT USE: vacant
T/R/S: T1S R3E Sec 10 STYLE: vernacular
MAP NO: 3453 TAX LOT (BLDG) STRUC. DIST. SITE OBJ. (circle)
ADDITION THEME: Religion
BLOCK: LOT: QUAD: Damascus, Or. 7.5' series
ASSESSOR ACCT: #

PLAN TYPE/SHAPE: rectangular NO. OF STORIES: 1
FOUNDATION MATERIAL: concrete BASEMENT (Y/N): no
ROOF FORM & MATERIALS: gable/wood shingles
WALL CONSTRUCTION: wood STRUCTURAL FRAME: N/A
PRIMARY WINDOW TYPE: gothic-shutters closed
EXTERIOR SURFACING MATERIALS: shiplap
DECORATIVE FEATURES: bell tower
OTHER:

CONDITION: EXCELLENT GOOD (FAIR) DETERIORATED (MOVED) (DATE)
1979

Moved from original location at W Powell and Walters Road in 1979.

EXTERIOR ALTERATIONS/ADDITIONS (DATED): front doors altered

NOTEWORTHY LANDSCAPE FEATURES: N/A

ASSOCIATED STRUCTURES N/A

KNOWN ARCHAEOLOGICAL FEATURES: N/A

SETTING: In Main City Park, NW corner. Park to east, playing field south and Jaycee's Hall and restrooms SE. Johnson creek runs south of structure. Bordered by commercial strip/Powell blvd to north.

STATEMENT OF SIGNIFICANCE (Historical and/or architectural importance, dates, events, persons, contexts). USE ADDITIONAL SHEETS IF NECESSARY:

The Bethel Baptist Church is significant to Gresham for its association with the pioneer settlers and developers of Gresham. It is representative of early pioneer churches and is the oldest public building in Gresham. (See Nat'l Register nomination for more detailed information)

SOURCES: "Remembering Our Childhood", Vol 1, Ed. Vera Peters, compiled by Gresham Pioneers, Gresham OR 1984

NEGATIVE NO.: Roll 14 #25
SLIDE NO.:

RECORDED BY: SD
DATE: 2/19/87

SHPO INVENTORY NO.:

5135

CITY OF GRESHAM
OREGON INVENTORY OF HISTORIC PROPERTIES
HISTORIC RESOURCE SURVEY FORM - TWO

PROPERTY NAME: First Bethel Baptist Church
ADDRESS: (Gresham Historical Society)
ASSESSOR ACCT #: Main

T/R/S; T1S, R3E, Sec. 10
MAP NO: 3453 TAX LOT: 94
QUADRANGLE: Damascus, OR 7.5 Series



NEGATIVE NO.: Roll 14 # 25

SLIDE.:

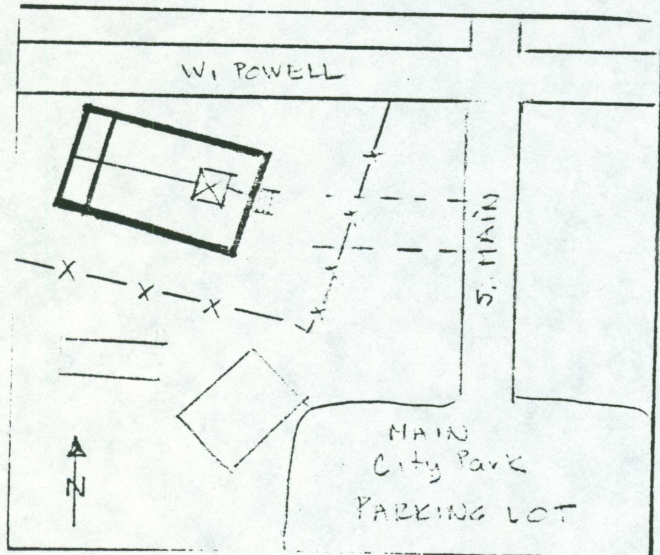

2: -w

GRAPHIC & PHOTO SOURCES:

Northwest Heritage Property Associates

SHPO INVENTORY NO:

5135