

Historic  
Resource  
Inventory  
CITY OF PORTLAND, OREGON.



3-020-00615

615 N.W. Twentieth Avenue

Couch's, Block 282, Lots 3, 4, East half of Lot 5  
QUARTER SECTION MAP #: 2927  
Northwest District Association

ORIGINAL FUNCTION: Residence  
OTHER FUNCTIONS: Community Center

DATE BUILT: 1892

STYLE: Richardsonian Romanesque

ARCHITECTURAL PLANS BY: Whidden and Lewis

ORIGINAL OWNER: MacKenzie, Kenneth A.J., M.D.  
OTHER OWNERS: Pioneer Education Society

ZONING: RH

DESIGNATION: Landmark  
HISTORIC DISTRICT: Nob Hill (potential)

SPECIAL FEATURES AND MATERIALS:

Intersecting gable roofs with eyelid and gable dormers. Roof cornice with block modillions. Coursed rock-faced ashlar and slate-shingled walls. Round tower with conical roof. Massive chimneys. Terraces, balconies, and corner entrance porch. Rectangular bay window.

953

3-020-00615

Round arches with voussoirs, one with stag's head and foliate decoration in tympanum. Multi-light and single-light windows, most double-hung, some bowed. Peep-slits.

AREAS OF SIGNIFICANCE: Architecture, Medicine, in association with Dr. Kenneth A.J. Mackenzie; Politics in association with Theodore Roosevelt

Politics in association with Theodore Roosevelt: Roosevelt was a guest in the house in 1911.

Medicine, in association with Dr. Kenneth A.J. Mackenzie: Mackenzie (1859-1920) was born in Canada, received his M.D. degree from McGill University in 1881, and did post-graduate study at the Royal College of Physicians and Surgeons in Edinburgh. On the advice of his father's friend, Donald Macleay, he came to Portland in 1882. Mackenzie helped to organize the faculty of the University of Oregon Medical School and was on the staff of St. Vincent's Hospital. He was president of both the Portland and Oregon State Medical Associations, and was chief surgeon for the Oregon Railroad and Navigation Company.

BIBLIOGRAPHY:

McMath, George, Portland Historical Landmarks Commission Inventory Form, 1970.

Present owners, as of May 1980: Episcopal Laymen's Mission Society  
MAILING ADDRESS: 615 N.W. Twentieth Avenue, Portland 97209

No Preservation Funding

Negative: 120-11

954

2908

OREGON INVENTORY OF HISTORIC PROPERTIES  
HISTORIC RESOURCE SURVEY FORM  
COUNTY: MULTNOMAH COUNTY

HIST. NAME: Dr. Kenneth A.J. Mackenzie  
House  
COMMON NAME:  
ADDRESS: 615 Northwest Twentieth Avenue  
CITY: Portland  
OWNER: Epicopal Laymen's Mission  
ADDRESS: 615 NW 20th, Portland, OR 97210

DATE OF CONSTRUCTION: 1896  
ORIGINAL USE: Domestic: single dwelling  
PRESENT USE: Social: civic  
ARCHITECT: Whidden and Lewis  
BUILDER:  
THEME: Culture: 19th Century  
Architecture/Medicine  
STYLE: Richardsonian Romanesque

T/R/S: TIN R1E S33  
MAP NO.: 2927 TAX LOT: NA  
ADDITION: Couch's Addition  
BLOCK: 282 LOT: 3, 4  
ZONE: RH QUAD.: Portland  
ASSESSOR NO.: R180227700

RESOURCE TYPE: Residence: single family  
CONDITION: Excellent  
MOVED (DATE):

Old Address: 145 20th Street, N.  
RANK: Portland Landmark: National Historic  
Register

PLAN TYPE/SHAPE: Irregular  
FOUNDATION MATERIAL: Stone  
ROOF FORM & MATERIALS: Gable  
w/intersecting gables, gable dormers/composition  
shingles  
WALL/FRAME: Stone/unknown

NO. OF STORIES: 2 1/2  
BASEMENT: Yes, raised

PRIMARY WINDOW TYPE: 8/1 double-hung wood sash  
EXTERIOR SURFACING MATERIALS: Stone; slate above first floor

DECORATIVE FEATURES: Dormers with bowed fronts; large gabled dormer with bellcast roof and similar bowed glazing; balcony over large projecting rectangular bay on south elevation with stone parapet as balustrade; recessed sleeping balcony under north side gable; first floor semi-circular balcony; large masonry tower facing east with flattened cone roof; four massive stone chimneys; south chimney has sunburst decoration; stag's head in round arched panel over bay /balcony on south elevation; rustic rock-faced masonry; heavy stone flat arches and round arches in masonry areas; large rectangular bay on south elevation with single large window in center recessed under main roof at northeast corner and enclosed by masonry with large round arch openings and stone grid balustrade.

EXTERIOR ALTERATIONS/ADDITIONS (DATED): Two and one-half story addition added to west side, date unknown; new entry to building, c. 1985; window unit air conditioners installed on east and south elevations, date unknown.

NOTEWORTHY LANDSCAPE FEATURES: Foundation and ornamental plantings, mature deciduous trees, stone wall with hedge at sidewalk on southeast side with stone steps to entry on east side.

ASSOCIATED FEATURES: Addition, 1978.

SETTING: The house is located on the west side of N.W. Twentieth Avenue and the corner of N.W. Hoyt Street, a quiet residential street with houses and apartments. Couch School and Park are directly across N.W. Hoyt Street to the south.

RECORDED BY: Donovan and Associates  
Prohaska and Associates

SHPO INVENTORY NO.:  
DATE: August 1991

2908

OREGON INVENTORY OF HISTORIC RESOURCES  
HISTORIC RESOURCE SURVEY FORM  
NORTHWEST PORTLAND

STATEMENT OF SIGNIFICANCE

The property is listed on the National Register of Historic Places.

Historical: The property is associated with the following Portland families: Kenneth and Ronald Mackenzie and Barbara Macleay.

PROPERTY OWNERSHIP HISTORY

- 1887-1923 Kenneth Mackenzie purchased the property from George Anderson in 1887. Mackenzie in 1920. Kenneth and Anona MacKenzie deeded the property to Security Savings and Trust Company in 1923.
- 1925-1936 Ronald Mackenzie deeded the property to the Mackenzie Estate Company on May 18, 1925. Two days later the Mackenzie Estate Company deeded the property to Barbara Macleay. The property was deeded to Investors Synod in 1936.
- 1936-1943 Investor's Synod deeded the property to H.A. and Lulu Blyth in 1943.

OWNERS BIOGRAPHICAL INFORMATION

Dr. Kenneth A.J. Mackenzie (1859-1920) was a prominent Portland physician and surgeon. Mackenzie was born in Cumberland house, Manitoba, Canada on January 13, 1859. He received his medical training in Montreal and Edinburgh. Mackenzie took post graduate work in the Royal College of Physicians and Surgeons. He came to Portland in 1882, where he helped to organize the University of Oregon Medical School and served on the staff of St. Vincent's Hospital. Dr. Mackenzie was Dean of the Medical Department of the University of Oregon and for many years one of its most active members. At the time of his death, he was survived by two daughters, Mrs. Roderick Macleay and Miss Jean Mackenzie, and two sons, Kenneth A.J. Mackenzie, Jr., and Ronald Mackenzie.

Anona MacKenzie was the wife of Kenneth Mackenzie. Mackenzie built their home in 1892 as a private residence for his family. The front door was carved by Mrs. Mackenzie and features a thistle, the national flower of her native Scotland. Much of the artistic handiwork throughout the house was done by Mrs. Mackenzie.

Ronald S. MacKenzie (d. 1930) was the son of Dr. Kenneth A.J. Mackenzie. He died on October 26, 1930 of a heart attack. He was survived by his widow, Mildred and a daughter, Jean Mackenzie. He was the brother of Mrs. Roderick Macleay, Mrs. E.F. Whitney and Kenneth Mackenzie.

HOUSE HISTORY

The house was built by Kenneth A.J. Mackenzie, M.D. in 1892 as a private residence for his family. Architects, Whidden and Lewis, utilized the same gray stone for the exterior as that used

ADDRESS: 615 Northwest Twentieth Avenue  
RECORDED BY: Donovan & Associates  
Prohaska & Associates

SHPO INVENTORY NO.:  
DATE: August 1991

OREGON INVENTORY OF HISTORIC RESOURCES  
HISTORIC RESOURCE SURVEY FORM  
NORTHWEST PORTLAND

in Trinity Episcopal Church (where Dr. Mackenzie was a communicant), the Portland City Hall and the Leadbetter home.

"William Whidden and Ion Lewis made up Portland's foremost architectural firm from 1890 to 1910, though the firm continued in business past Whidden's retirement in 1920 until Lewis' death in 1933. Both men were educated at M.I.T. and launched their careers on the East Coast--Whidden with the prestigious New York firm of McKim, Mead and White, and Lewis with Peabody and Stearns in Boston. Whidden also was trained in Paris at the Ecole des Beaux Arts. He was sent to Portland by his employers to oversee construction of Henry Villard's Portland Hotel in 1883. When the project was halted by the collapse of Villard's financial empire, Whidden returned to the East Coast. In 1888, the unfinished hotel project was rescued by a local syndicate, and Whidden was hired to finish the work. In 1889, Whidden was visited in Portland by his M.I.T. classmate, Ion Lewis, who was persuaded to stay on and enter into a partnership with Whidden, which was established in 1890.

Whidden and Lewis were responsible for most of Portland's finest buildings of the turn-of-the-century period. It was they who introduced up-to-date architectural fashions to Portland. In addition to their residential work in the Colonial Revival Style, the firm introduced in their Portland City Hall (1892-1895) the Renaissance Revival Style exemplified by McKim, Mead and White's New York City Houses for Henry Villard (1882-1886) and the Boston Public Library (1888-1892)" (*National Register of Historic Places Nomination Form* ).

Sources: Ticor Title Company Records  
Multnomah County Tax Assessor Records  
City of Portland Building Bureau  
Portland City Directories  
Portland Block Books  
Mackenzie, *Oregonian*, 5 July 1980, p.13  
Mackenzie, *Journal*, 28 March 1966, p.1  
Mackenzie, *Journal*, 29 May 1965, p.9

ADDRESS: 615 Northwest Twentieth Avenue  
RECORDED BY: Donovan & Associates  
Prohaska & Associates

SHPO INVENTORY NO.:  
DATE: August 1991

OREGON INVENTORY OF HISTORIC PROPERTIES  
HISTORIC RESOURCE SURVEY FORM  
COUNTY: MULTNOMAH COUNTY

ADDRESS: 615 Northwest Twentieth Avenue

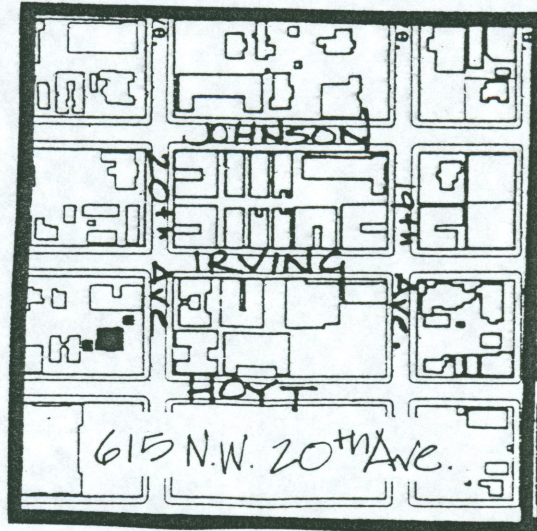
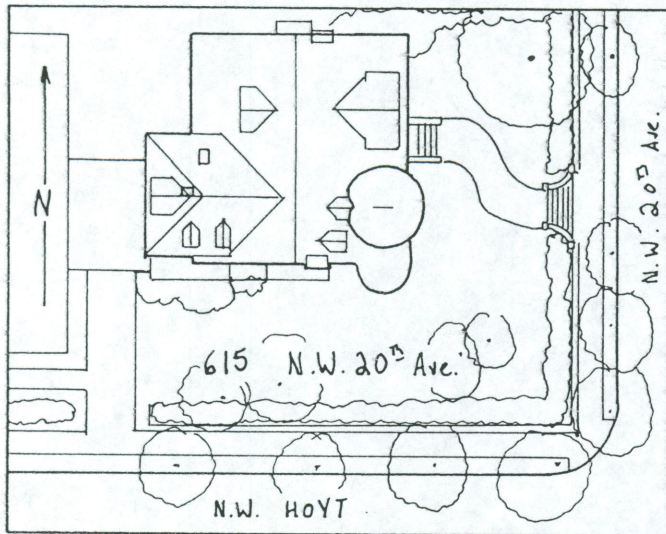

NEGATIVE NO.: Roll 23 #14A,15A,13A

DATE: 1/26/1991



RECORDED BY: Donovan and Associates  
Prohaska and Associates

SHPO INVENTORY NO.: