

Historic  
Resource  
Inventory  
CITY OF PORTLAND, OREGON



4-612-04619

4619 N. Michigan Avenue

M Pattons and Second, Block 22  
QUARTER SECTION MAP #: 2529  
Humboldt

ORIGINAL NAME: Patton Home for the Aged  
OTHER NAMES: Patton Home for the Friendless

ORIGINAL FUNCTION: Retirement Home

DATE BUILT: 1909

STYLE: Twentieth Century Georgian

TAX ASSESSOR'S ACCOUNT #: R-52050-1840  
ZONING: R2.5

Rank II

SPECIAL FEATURES AND MATERIALS:  
Original structure of brick with quoins, Tudor arches, flat arches, segmental arches and label moldings.

SPECIAL F/M - SIGNIFICANT ALTERATION:  
Addition of 1925 has gable roof with gabled entrance pavilion. Decorative roof cornice with block modillions. Round window in stuccoed entrance gable. Padian window above projecting entrance porch with paired Tuscan columns.

AREAS OF SIGNIFICANCE: Architecture, Social

109

1631





1950  
1951  
1952

100 W. Michigan Avenue

1st, 2nd and 3rd floors, block 12  
COURT REPORTERS BLDG. #1-2322

ORIGINAL NAME: Patton Home for the Aged  
OTHER NAMES: Patton Home for the Blind

ORIGINAL FUNCTION: Retirement Home

DATE BUILT: 1900

STATE: Wisconsin Century Continental

TAX ASSESSOR'S ACCOUNT #: R-22020-1840

CONTACT: RLT

1950

SPECIAL FEATURES AND OTHER ASPECTS:  
Original structure of brick with gables, Tudor arches, 1st + second, segments  
arches and label moldings.

SPECIAL NOTE - SIGNIFICANT ALTERATION:  
Addition of 1920s log cabin roof with log entrance pavilion. Pedestals too  
corridor with brick columns. Round window in second and third stories.  
Pavilion has mirror above projecting entrance porch with paired brick columns.

AREAS OF SIGNIFICANCE: Architecture, Social



4-612-04619

**BIBLIOGRAPHY:**

*City of Portland Buildings Bureau microform and card files.*

*Multnomah County Tax Assessor records, microform, automated data files, and card files (Portland, 1980).*

*City of Portland Buildings Bureau microform and card files.*

*Martin, R. Jr., Additions to the Patton Home for the Friendless, plans, 1925, City of Portland Buildings Bureau Microfiche Collection.*

**OLD ADDRESS:** 975 Michigan Avenue

**MAJOR ALTERATIONS:** 1925/171633/R. M. Martin Jr.

*Present owner as of May 1981: Patton Home for the Friendless*

**MAILING ADDRESS:** 4619 N. Michigan Avenue, Portland 97217

*No Preservation Funding*

*Negative: 591-33*

*Score - Design/Construction: 8*

*Score - Historical: 5*

*Score - Rarity:*

*Score - Environment: 8*

*Score - Integrity: 10*

*Score - Intrinsic:*

*Score - Contextual: 18*

*Score - Total: 63.5*



APPENDIX

City of Portland Building Bureau Microform and card files.  
Multnomah County Tax Assessor records, microform, audiotaped data files, and  
card files (Portland, 1980).

City of Portland Building Bureau Microform and card files.  
Martin, R. W., Additions to the Barton Home for the Blind, plus 2, 1925.  
City of Portland Building Bureau Microform Collection.

Old Address: 925 Michigan Avenue

MARK ARMAILOW: 1025 VILLAGE M. WATSON

Present owner as of 1978: Barton Home for the Blind  
Mailing Address: 4615 N. Michigan Avenue, Portland, 97217

No preservation funding

negative: 5/1/82

Scope - Description: 2

Scope - Material: 2

Scope - Format: 2

Scope - Environment: 2

Scope - Frequency: 10

Scope - Intensity: 10

Scope - Context: 18

Scope - Total: 63



Albina Community Historic Resources Inventory

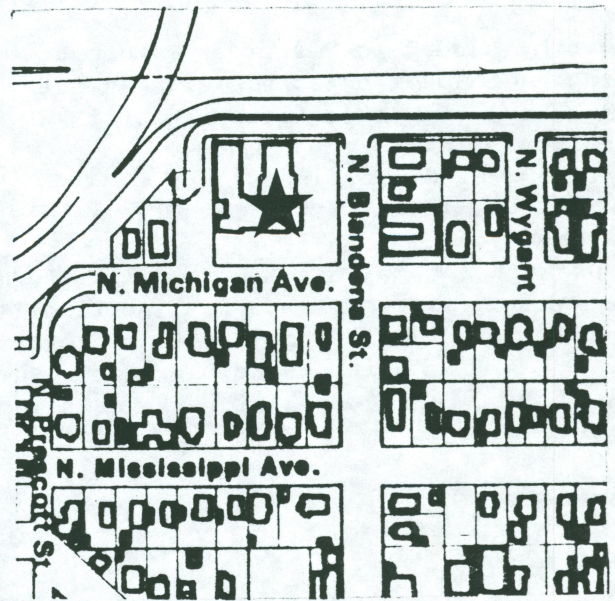
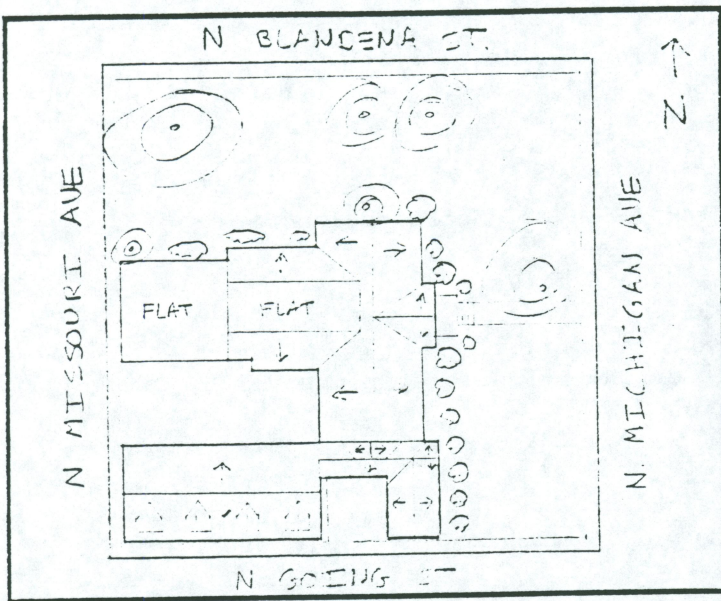

ADDRESS: 4619 N. Michigan Ave.

1631



4-612-04619

**4619 N. Michigan Avenue**

M Pattons and Second, Block 22

Present owner as of 1993: Patton Home for the Friendless

**Neighborhood Association:** Humboldt

**Historic District:** Mississippi

**Tax Assessor #:** R-52050-1840

**Quarter Section Map #:** 2529

**Zoning Designation:** R2.5ad

**Historic Name:** Patton Home for the Aged

**Date Built:** 1909

**Original Owner:** Patton Home for the Aged

**Builder:** Pippy and Disbrow

**Original Function:** Retirement Home

**Present Function:** Residential Care Facility

**Style/Typology:** Twentieth Century Georgian

**Theme:** Architecture; Social/Humanitarian

**Chronological Period:** The Progressive Era 1884-1913

**Resource Type:** Building

**Plan Type/Shape:** "U" shaped

**Foundation Material:** Concrete

**Frame:** Wood

**Roof:** Gable with Gabled Entrance Pavilion; Composition Shingle

**Primary Window Type:** One-Over-One Double Hung

**Number of Stories:** 2.5

**Basement:** Yes

**Exterior Surface Materials:** Brick

**Decorative Features:** Original structure of brick with quoins, Tudor arches, flat arches, segmental arches and label moldings. Addition of 1925 has gable roof with gabled entrance pavilion. Decorative roof cornice with block modillions. Round window in stuccoed entrance gable. Palladian window above projecting entrance porch with paired Tuscan columns.

**Condition:** Good

**Noteworthy Landscape Features:** Mature trees and foundation planting.

**Setting:** Group of buildings sits on full block facing N Michigan Ave between N Blandena and N Going Sts. Area is residential.

**Alteration Data:**

1925/171633/R. M. Martin Jr.

**Statement of Significance:** Highly visible from I-5. Neighborhood landmark.

**Bibliography:**

City of Portland Buildings Bureau microform and card files.

Multnomah Tax Assessor records (Portland, 1993).

City of Portland Buildings Bureau microform and card files.

Martin, R. Jr., Additions to the Patton Home for the Friendless, plans, 1925, City of Portland Buildings Bureau Microfiche Collection.

**Negative:** 591-33

**Total Score:** 21

Architecture: 7

History: 6

Integrity: 6

Environment: 2

Ensemble: 0