

Historic  
Resource  
Inventory  
CITY OF PORTLAND, OREGON.



2-185-01811

1811 N.W. Couch Street

Couch's, Block 170, Lots 1, 4  
QUARTER SECTION MAP #: 3028  
Northwest District Association

ORIGINAL NAME: Tudor Arms Apartments

ORIGINAL FUNCTION: Apartment House

DATE BUILT: 1915

STYLE: Jacobethan

ARCHITECTURAL PLANS BY: Carl L. Linde

TAX ASSESSOR'S ACCOUNT #: R-18021-5390

ZONING: RH

Rank II.

HISTORIC DISTRICT: Nob Hill (potential)

SPECIAL FEATURES AND MATERIALS:

Flat roof with parapet. Brick and glazed terra cotta exterior. Glazed terra cotta elements include balustrade, stepped pattern in curvilinear gables, finials, cornice, quoins, window lintels, and elaborate curvilinear pediment over entry to courtyard. Courtyard entry has terra cotta panel inscribed "Tudor Arms" over opening.

AREAS OF SIGNIFICANCE: Architecture

67

2457

2-185-01811

**BIBLIOGRAPHY:**

Carl L. Linde Job List, Collection Portland Historical Landmarks Commission  
City of Portland Buildings Bureau microform and card files.

Portland City Directory (Portland, Oregon).

Multnomah County Tax Assessor records, microform, automated data files, and  
card files (Portland, 1980).

OLD ADDRESS: 581 Couch Street

Present owners, as of May 1980: ELW Properties, Inc.

MAILING ADDRESS: 1811 N.W. Couch Street, #102, Portland 97209

No Preservation Funding

Negative: 570-15

Score - Design/Construction: 9

Score - Historical: 0

Score - Rarity: 5

Score - Environment: 8

Score - Integrity: 10

Score - Intrinsic: 9

Score - Contextual: 23

Score - Total: 54.5

68

2457

OREGON INVENTORY OF HISTORIC PROPERTIES  
HISTORIC RESOURCE SURVEY FORM  
COUNTY: MULTNOMAH COUNTY

HIST. NAME: Royal Apartments  
COMMON NAME: Tudor Arms Apartments  
ADDRESS: 1811 Northwest Couch Street  
CITY: Portland  
OWNER: Tanner, Nancy  
ADDRESS: P.O. Box 399, Eagle Creek, OR  
97022

DATE OF CONSTRUCTION: 1915  
ORIGINAL USE: Domestic: multiple dwelling  
PRESENT USE: Domestic: multiple dwelling  
ARCHITECT: Linde, Carl L.  
BUILDER:  
THEME: Culture: 20th Century Architecture  
STYLE: Jacobethan

T/R/S: T1N R1E S33  
MAP NO.: 3028 TAX LOT: NA  
ADDITION: Couch's Addition  
BLOCK: 170 LOT: 1,4  
ZONE: RH QUAD.: Portland  
ASSESSOR NO.: R180215390

RESOURCE TYPE: Apartment  
CONDITION: Excellent  
MOVED (DATE):

Old Address:  
RANK: Portland Landmark, National Historic  
Register

PLAN TYPE/SHAPE: U-shape  
FOUNDATION MATERIAL: Concrete  
ROOF FORM & MATERIALS: Flat w/parapet  
WALL/FRAME: Brick; stone

NO. OF STORIES: 4  
BASEMENT: Yes, raised

PRIMARY WINDOW TYPE: 8/1 double-hung wood sash  
EXTERIOR SURFACING MATERIALS: Brick; terra cotta

DECORATIVE FEATURES: Balustraded parapet with ornamental terra-cotta finish; obelisk-like finials, projecting terra-cotta cornice; rosettes design at intervals; terra-cotta band courses on second and fifth floors, terra-cotta quoins at corners and at intermediate projecting areas of wall; rusticated concrete on first floor; rectangular windows, with terra-cotta trim, Gothic inlets with drip molds, stone lintels and stone sills; balconies with iron work; entrance located on N.W. Couch, recessed with entry court; elaborate arched entry to courtyard on sidewalk with composite fluted columns, terra-cotta crests, porch-like entry on court, brick and terra-cotta with parapet; signage; "Tudor Arms" over arch entry.

EXTERIOR ALTERATIONS/ADDITIONS (DATED): Installation of sliding glass door on balconies, date unknown.

NOTEWORTHY LANDSCAPE FEATURES: Foundation plantings; laurel hedge; mature deciduous; maple; courtyard.

ASSOCIATED FEATURES: None

SETTING: The building is located one-fourth of a block on a corner lot, slightly set back on N.W. Couch Street. Apartments are located to the north and an auto-body shop is located to the west. St. Mary's is across from NW Eighteenth Avenue.

RECORDED BY: Donovan and Associates  
Prohaska and Associates

SHPO INVENTORY NO.: P-111  
DATE: August 1991

2457

OREGON INVENTORY OF HISTORIC RESOURCES  
HISTORIC RESOURCE SURVEY FORM  
COUNTY: MULTNOMAH COUNTY

STATEMENT OF SIGNIFICANCE

Architectural: The Tudor Arms Apartment is listed on the National Register of Historic Places. The building is significant as an excellent example high-style Jacobethan architecture. The apartment was designed by the prominent Portland architect Carl L. Linde in 1915 for the Royal Arms Company. One of twelve apartment building designed in this style, the Tudor Arms Apartments is an intact example of the type.

Historical: The property is associated with the following Portland families or businesses: Ellen, Kate and George Williams, Mary Grattan, Royal Arms Company, S.M. Morris, Byron and Margaret Wolverton.

PROPERTY OWNERSHIP HISTORY

- 1910 Ellen W. Williams, daughter of Kate and George H. Williams, was deeded lots 1-8 of Block 170. On October 19, 1910, she sold the property to Mary J. Grattan. When the improvements were made to NW Couch and Nineteenth streets on November 5, 1910, Mary Grattan was assessed for the improvements.
- 1914-1915 Mary Grattan deeded her property to Security Savings and Trust Company on November 30, 1914. Security Savings and Trust Company deeded lots 1 and 4 to the Royal Arms Company on March 4, 1915.
- 1915-1929 Royal Arms Company leased the property to S.M. Morris on April 29, 1929.
- 1929-1946 S.M. Morris deeded the property to Byron W. and Margaret Wolverton on December 20, 1946.

OWNERS BIOGRAPHICAL INFORMATION

George H. Williams (1823-1910) was a former U.S. Senator, Attorney General and prominent Judge in the state of Oregon. In 1874, he withdrew his bid to become chief justice of the Supreme Court of the United States. Williams was known as the "grand old man" of Oregon--grand in his simplicity, religious without being puritanical, intellectual and scholarly without vanity and pedantry. Judge Williams was born in New Lebanon, Columbia County, New York on March 26, 1823. He was educated in New York and began his practice at the age of twenty-one in the courts of New York. Williams later moved to Madison, Iowa and was chosen judge of the first judicial district court where he served for five years on the Iowa bench.

Williams received a presidential appointment to serve as chief justice of the territory of Oregon. He was reappointed to the position by President Buchanan in 1857. He was chosen a member of the constitutional convention which drafted the first organic law of Oregon. Williams acted as chairman of the judiciary committee. While participating in the convention, he vigorously opposed the introduction of slavery in Oregon. In 1860 Williams became one of the founders of the Union Party and canvassed the country for Abraham Lincoln and did everything possible to gather support for the Union cause. Williams was a member of the United States Senate, elected in 1864. Williams returned to Oregon after his senate duty, and resumed the practice of law.

ADDRESS: 1811 Northwest Couch Street  
RECORDED BY: Donovan & Associates  
Prohaska & Associates

SHPO INVENTORY NO.:  
DATE: August 1991

OREGON INVENTORY OF HISTORIC RESOURCES  
HISTORIC RESOURCE SURVEY FORM  
COUNTY: MULTNOMAH COUNTY

In 1850 Judge Williams married Kate Van Atwerp, a daughter of General Verplank Van Atwerp. Mrs. Williams moved with him to the Oregon Territory in 1853 when he was appointed Chief Justice of the Oregon Territorial Supreme Court by President Franklin Pierce. They had one daughter, Ellen. Mrs. Williams died in July, 1864, just before the Oregon Legislature elected her husband to the U.S. Senate. A few years later Judge Williams married Mrs. Kate George, a daughter of Ross Hughes of Iowa. Mrs. Williams prior marriage was to A Jacob Ivans. Her second marriage was to a stagecoach driver from Colorado. After his death Kate moved to Portland. She married George Williams and then moved to Washington as the senator's wife. The Williams entertained in grand style at the National Hotel where they lived and soon the senator's wife was involved in Washington society. This created many problems for the family. Upon their return to Oregon, Kate became very religious and practiced prolonged periods of fasting, one which lasted 110 days. The last fast proved to be too much for her and on April 18, 1894, she died at the age of 61. There were two adopted children from this marriage, Mrs. Carl Harbaugh and Theodore Williams.

Ellen W. Williams was the daughter of Kate and George H. Williams. See George H. Williams.

Mary J. Gratton: No biographical information is currently known.

S.M. Morris: No biographical information is currently known.

#### ARCHITECT

Carl L. Linde (1864-1945), "was a German native who settled in Milwaukee, Wisconsin in 1870. Before graduating from Milwaukee's German-English Academy in 1887, he apprenticed to an architect. In 1883 he went to New York to enlist in the Navy. After serving a year at the Newport, Rhode Island, naval training station, his parents purchased his release. It is unclear whether he stayed in New York for a short time then, or returned to New York after graduating from the Academy. Mr. Fred C. Baker, a close personal friend of Mr. Linde's, asserts that Linde worked as a draftsman for McKim, Meade & White in his youth. No confirmation has yet been found in the McKim, Mead & White files.

At some time, Mr. Linde returned to the mid-west and worked as a staff architect for Ryerson Steel in Chicago. He worked on several high-rise buildings in the Chicago area during the "time of the union trouble" at Ryerson. Sometime before coming to Oregon in 1906, Mr. Linde was employed as a brewery architect in Milwaukee, Wisconsin. No specific chronology for this period in Mr. Linde's life is currently available.

After coming in Oregon in 1906, Mr. Linde worked in Edgar Lazarus' office where he designed and supervised construction of the Electric Building for which he received national attention. Linde later worked for Whidden & Lewis, D.C. Lewis, A.E. Doyle and Whitehouse & Fouilhoux before applying for his license in 1921. From 1921 until 1940 he maintained his own architectural practice in Portland. From 1941 until his death in 1945 he was "associated" with the army engineers at Vancouver Barracks, Washington. Mr. Linde is remembered primarily for his residences and apartment houses in Portland, although he did a bank and brewery in Vancouver, Washington, and the Cameron Hotel and Puget Sound Savings and Loan in Seattle. For a period of time Mr. Linde maintained an office in Seattle as well as in Portland.

ADDRESS: 1811 Northwest Couch Street  
RECORDED BY: Donovan & Associates  
Prohaska & Associates

SHPO INVENTORY NO.:  
DATE: August 1991

OREGON INVENTORY OF HISTORIC RESOURCES  
HISTORIC RESOURCE SURVEY FORM  
COUNTY: MULTNOMAH COUNTY

Mr. Linde's work includes The Ambassador Apartments (listed in the National Register), the Sovereign, Envoy and Embassy Apartments, the Banfield home on the Oregon Coast, the Jack Barde house (a Portland Historic Landmark) and the McBride, Poole and Wakeman residences in the Portland area." (Tess: 3-4)

Sources: Ticor Title Company Records  
Multnomah County Tax Assessor Records  
City of Portland Building Bureau  
Portland City Directories  
Portland Block Books  
Williams, Carl Abbott, Ph.D., research files  
John M. Tess, "National Register of Historic Places Nomination Form," 1986  
Williams: *Portland, Its History and Builders*, Vol II. p.10  
*Oregonian* 16 March 1929, p. 12  
*Oregon Journal*, 29 January 1933, p.8  
*Oregon Journal*, 21 December 1930, p.8  
*Oregonian*, 28 March 1911, p.14

ADDRESS: 1811 Northwest Couch Street  
RECORDED BY: Donovan & Associates  
Prohaska & Associates

SHPO INVENTORY NO.:  
DATE: August 1991

OREGON INVENTORY OF HISTORIC PROPERTIES  
HISTORIC RESOURCE SURVEY FORM  
COUNTY: MULTNOMAH COUNTY

ADDRESS: 1811 Northwest Couch Street

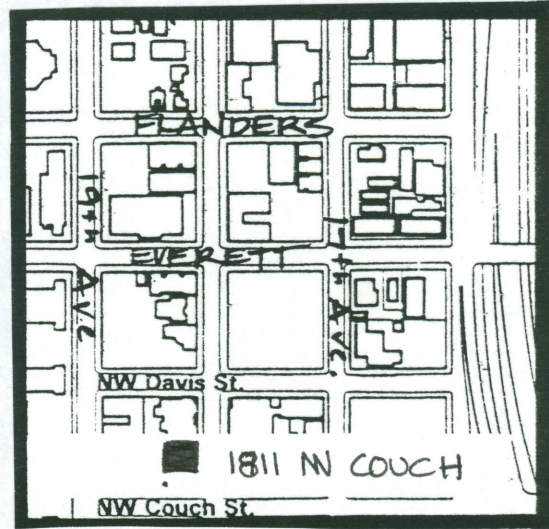
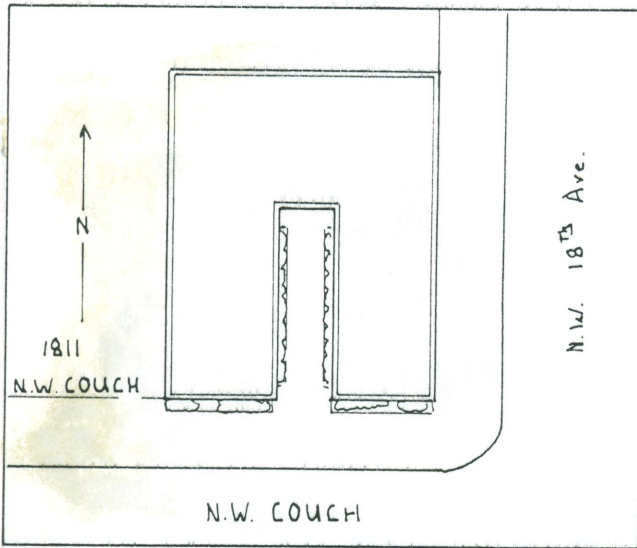

NEGATIVE NO.: Roll 26 #7

DATE: 3/20/91



RECORDED BY: Donovan and Associates  
Prohaska and Associates

SHPO INVENTORY NO.: