

OREGON INVENTORY OF HISTORIC PROPERTY  
ELLIS LAWRENCE BUILDING INVENTORY  
COUNTY: Multnomah

HISTORIC NAME: STETTLER, FRANK C., HOUSE

COMMON NAME:  
OTHER NAMES:

RESOURCE TYPE: Building  
STATUS: built & survives

LAWRENCE

(JOB#) YEAR: (0103)

(JOB#) YEAR: ( )

(JOB#) YEAR: ( )

CITY: Portland Oregon  
STREET: 2606 NW Lovejoy  
OWNER: Allen, Barbara  
(property address above) 97210

FIRST DATE: Dec. 1913

DESIGN BEG:

DESIGN END:

CONSTR BEG: Jan. 1914

CONSTR END:

TOWNSHIP: 01n RANGE: 01e SECTION: 32  
MAP#: 2926 TAX LOT: 01-01-32-

LOSS DATE:

ADDITION: ORIGINAL USE: residence

BLOCK: LOT: QUAD: Portland PRESENT USE: bed & breakfast

ASSESSOR #: R-94132-0170 SITE: 0.2 acres, approx.

THEMES: 20C Architecture, Manufacturing/Processing

DATA BELOW IS ON LAWRENCE FIRM'S DESIGN AS-BUILT:

ARCHITECT: Lawrence and Holford  
ENGINEERS & CONSULTANTS:

CHIEF DESIGNER: unknown

CONTRACTORS:

B.T. Allen (General)

ARTISTS & CRAFTSMEN:

STYLE: Arts & Crafts

PLAN TYPE/SHAPE: rectangular (front long)

FOUNDATION MATERIAL: concrete

STORIES: 2.5 BASEMENT: yes

ROOF/MATERIAL: gable w/2 offset gables w/comb. dormer types/Comp. shingles

WALL CONSTR: nailed wood frame

STRUC.FRAME: nailed wood frame

PRIME WINDOW TYPE: wood multi over 1 double hung

EXTERIOR SURFACE MATERIAL: stucco,

DECORATIVE FEATURES/MATERIALS:

porte cochere with Tudor arches, double gable roof

OTHER:

interior: varnished oak woodwork, some original light fixtures, built-ins,  
maple floors, maple stair treads and fir risers

CONDITION: good

MOVED: not moved

ALTERATIONS/ADDITIONS (dated):

restore existing carriage house to garage (1985); entrance portico enclosed  
with plywood, room added over porte cochere, kitchen enlarged (no date)

LANDSCAPE FEATURES:

tall arbor vitae hedge surrounds property

5377

ELLIS LAWRENCE BUILDING INVENTORY

HISTORIC NAME: STETTLER, FRANK C., HOUSE

**ASSOCIATED STRUCTURES:**

detached historic two story carriage house built in 1920

**SETTING:**

urban residential/commercial; faces northeast on an angle to the street, corner of Lovejoy and Cornell

**SIGNIFICANCE OF LAWRENCE FIRM'S DESIGN:**

**EXTER.DETAILS/CRAFTSMANSHIP:** unknown

**INTER.DETAILS/CRAFTSMANSHIP:** Better than average workmanship and materials.

**EXTERIOR INTEGRITY:** Major changes; original character lost.

**INTERIOR INTEGRITY:** Minor changes, but original character intact.

**SITE INTEGRITY:** Moderate changes; some original character remains.

**SETTING INTEGR:** Minor changes to character and relationship of surroundings.

**SIGNIFICANCE STATEMENT:**

Frank Stettler was born in Ohio in 1856 and moved to Portland in 1902. He set up a paper box manufacturing business which by 1916 had grown large enough to build a substantial building expressly for this purpose on the east side of Portland. The F.C. Stettler Manufacturing Company also operated in Spokane, Washington and did business as far east as Denver, St. Paul and St. Louis. In addition to making paper carton, boxes and labels, the company also produced color lithography and printing for various forms of advertising.

**SOURCES/DOCUMENTS: Description (Location)**

Ellis Lawrence Collection/U of O Special Collections; Multnomah County Tax Assessor Records; Oregon Biographical Index (OHS);

Polk's Portland City Directory; Portland Building Permits

sources consulted/no info located: Oregon Historic Photo Collection (OHS); Portland Historic Resource Inventory

**PUBLICATIONS:**

Lockley, Fred. HISTORY OF THE COLUMBIA RIVER VALLEY. p. 227-8.

SLIDE NO.:

SHPO INVENTORY NO.:

5377

RESEARCH BY: K. Lakin

RECORDED BY: K. Lakin

DATE: 07/26/88

DATE: 08/28/88

5377

ELLIS LAWRENCE BUILDING SURVEY  
HISTORIC NAME: STETTLER, FRANK C., HOUSE

RECENT PHOTO  
NEGATIVE #s:

*First # above  
is upper-right  
photo; second #  
is just below.  
If no # above,  
see sources at  
bottom of page.*

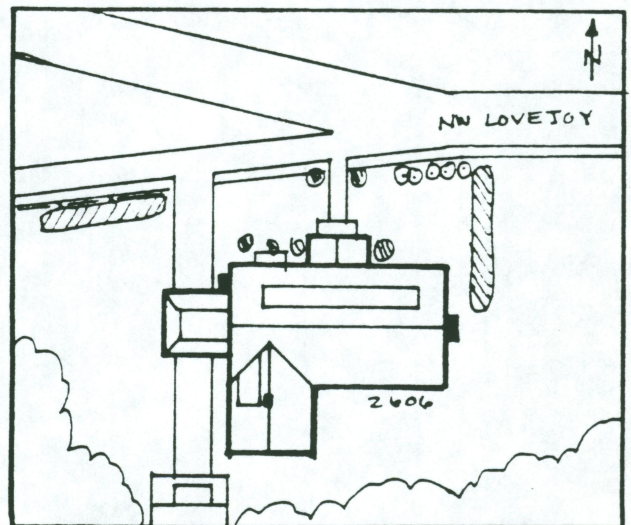
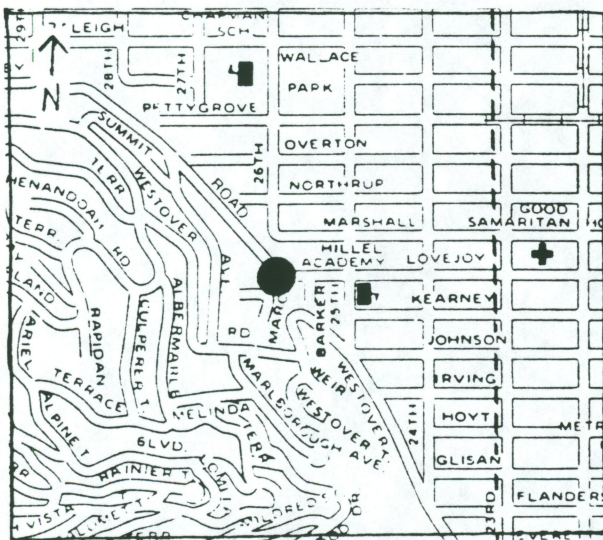

HISTORIC PHOTO/OTHER GRAPHIC SOURCE: K. Lakin

OREGON INVENTORY OF HISTORIC PROPERTY  
ELLIS LAWRENCE BUILDING INVENTORY

E V A L U A T I O N

HISTORIC NAME: STETTLER, FRANK C., HOUSE

<u>INTEGRITY OF:</u>	<u>NUMERICAL</u>
1. EXTERIOR: Major changes; original character lost.	0
2. INTERIOR: Minor changes, but original character intact.	7
3. SITE: Moderate changes; some original character remains.	3
4. SETTING: Minor changes to character and relationship of surroundings.	3
<b>INTEGRITY TOTAL</b>	<b>13</b>

<u>DISTINCTION OF:</u>	
1. EXTERIOR DETAILS & CRAFTSMANSHIP: unknown	0
2. INTERIOR DETAILS & CRAFTSMANSHIP: Better than average workmanship and materials.	3
3. STYLE: (Arts & Crafts) It has few features associated with its identified style. Compared to Lawrence's other surviving Oregon buildings, this style is one of several (6 or more) in its city/town or rural area.	0
4. ORIGINAL USE: (residence) Compared to Lawrence's other surviving Oregon buildings, this use is one of several (6 or more) in its city/town or rural area.	0
5. ARCHITECTURAL DESIGN: Compared to Lawrence's other surviving Oregon buildings, this design is below average quality and significance. Is it part of an ensemble of surviving buildings by Lawrence? Lawrence building(s) nearby; but arrangement is not ordered. Are structural or technical aspects of the design significant? Of little significance.	0
6. LAWRENCE'S PERSONAL INVOLVEMENT IN THE DESIGN PROCESS: Lawrence was probably chief designer, though little evidence	6
<b>DISTINCTION TOTAL</b>	<b>14</b>

<u>EDUCATIVE OR ASSOCIATIVE VALUE:</u>	
1. HISTORIC EVENTS OR ACTIVITIES: No known association with historic events or activities.	0
2. HISTORIC PERSONS: Some association with significant historic person(s).	2
3. SYMBOLIC ASSOCIATION WITH AN IDEAL, INSTITUTION, OR POLITICAL ENTITY: No known significant symbolic association.	0
<b>EDUCATIVE OR ASSOCIATIVE TOTAL</b>	<b>2</b>
<b>GRAND TOTAL</b>	<b>29</b>
<b>RANK:</b>	<b>COMPATIBLE</b>

NOTE: Only the built, surviving buildings in Oregon were evaluated.

5377