

OREGON INVENTORY OF HISTORIC PROPERTY  
ELLIS LAWRENCE BUILDING INVENTORY  
COUNTY: Multnomah

HISTORIC NAME: GILLILAND, LEWIS T., HOUSE

COMMON NAME:  
OTHER NAMES:

RESOURCE TYPE: Building  
STATUS: built & survives  
LAWRENCE

CITY: Portland Oregon  
STREET: 2229 NE Brazee  
OWNER: Warberg, James and Suzann  
(property address above) 97212

(JOB#) YEAR: ( )  
(JOB#) YEAR: ( )  
(JOB#) YEAR: ( )  
FIRST DATE: June 1910  
DESIGN BEG:  
DESIGN END:  
CONSTR BEG:  
CONSTR END:  
LOSS DATE:  
ORIGINAL USE: residence  
PRESENT USE: residence  
SITE: 0.2 acres, approx.

TOWNSHIP: 1N RANGE: 1E SECTION: 26  
MAP#: 2832 TAX LOT: 1N-1E-26-  
ADDITION: Irvington ORIGINAL USE:  
BLOCK: 010 LOT: 9,10 QUAD: Portland PRESENT USE:  
ASSESSOR #: R42040-2020  
THEMES: 20C Architecture, Commercial

DATA BELOW IS ON LAWRENCE FIRM'S DESIGN AS-BUILT:

ARCHITECT: Ellis F. Lawrence, Architect CHIEF DESIGNER: E F Lawrence  
ENGINEERS & CONSULTANTS:

CONTRACTORS:

F. M. Moore (General); Thomas Hulme (Plumbing); Abbet Tining (Heating); Comet  
(Wiring); Cooper Sandstone Co., (Stonework); J. G. Mack Co. (Wallpaper).

ARTISTS & CRAFTSMEN:

STYLE: Arts & Crafts

PLAN TYPE/SHAPE: rectangular (front long)

FOUNDATION MATERIAL: concrete

STORIES: 1.5 BASEMENT: yes

ROOF/MATERIAL: low gable (6/12 max.) /Comp. shingles

WALL CONSTR: nailed wood frame

STRUC.FRAME: nailed wood frame

PRIME WINDOW TYPE: wood multi-pane double-hung

EXTERIOR SURFACE MATERIAL: wood shingles, cut stone

DECORATIVE FEATURES/MATERIALS:

Cut stone porch posts; inset front and side porches.

OTHER:

Interior: elaborate Craftsman Style woodwork, built-ins, stone fireplace,  
original light fixtures, original wallpaper frieze in living room.

CONDITION: good

MOVED: Not moved

ALTERATIONS/ADDITIONS (dated):

Basement finished (1973)

LANDSCAPE FEATURES:

5453



10/1/10

ELLIS LAWRENCE BUILDING INVENTORY

HISTORIC NAME: GILLILAND, LEWIS T., HOUSE

**ASSOCIATED STRUCTURES:**

Detached garage (historic)

**SETTING:**

Urban residential; faces south set back on slight rise from street in Irvington neighborhood

**SIGNIFICANCE OF LAWRENCE FIRM'S DESIGN:**

**EXTER.DETAILS/CRAFTSMANSHIP:** High-quality skilled work: some fine materials.

**INTER.DETAILS/CRAFTSMANSHIP:** High-quality skilled work: some fine materials.

**EXTERIOR INTEGRITY:** Essentially intact as originally built.

**INTERIOR INTEGRITY:** Essentially intact as originally built.

**SITE INTEGRITY:** Essentially intact as originally built.

**SETTING INTEGR:** Historic character & relationship of surroundings is intact.

**SIGNIFICANCE STATEMENT:**

This house is primarily significant for its excellent intact design. Both the interior and exterior are significant. This is the only Lawrence design in which he copied a plan from another source. The house appears in the Gustave Stikley magazine THE CRAFTSMAN. Lawrence copied this design exactly on the exterior and first floor interior. Evidently the client (Gilliland) had this design in mind when he hired Lawrence. The design is unique for its open to the roof living room ceiling. The interior detailing such as woodwork, light fixtures, border paper, and fireplace stone is all intact.

**SOURCES/DOCUMENTS: Description (Location)**

Exhibit Quality samples, E. Lawrence Collection/U of O Special Collections; Multnomah County Tax Assessor Records;

Oregon Biographical Index (OHS); Polk's Portland City Directories, Portland Building Permits;

Gilliland House National Register nomination prepared by Northwest Heritage Property Associates

sources consulted/no info located: Oregon Historic Photo Collection (OHS);

Portland Historic Resource Inventory

**PUBLICATIONS:**

PORTLAND DAILY ABSTRACT. 6/17,18/1910, 7/14/1910. MEN OF OREGON. 1911.

PACIFIC BUILDER AND ENGINEER. 7/2,23,30/1910. THE NORTHWEST ARCHITECT. 7/1910.

SLIDE NO.:

SHPO INVENTORY NO.: 5453

RESEARCH BY: K. Lakin

RECORDED BY: K. Lakin

DATE: 05/06/88

DATE: 09/18/88

5453

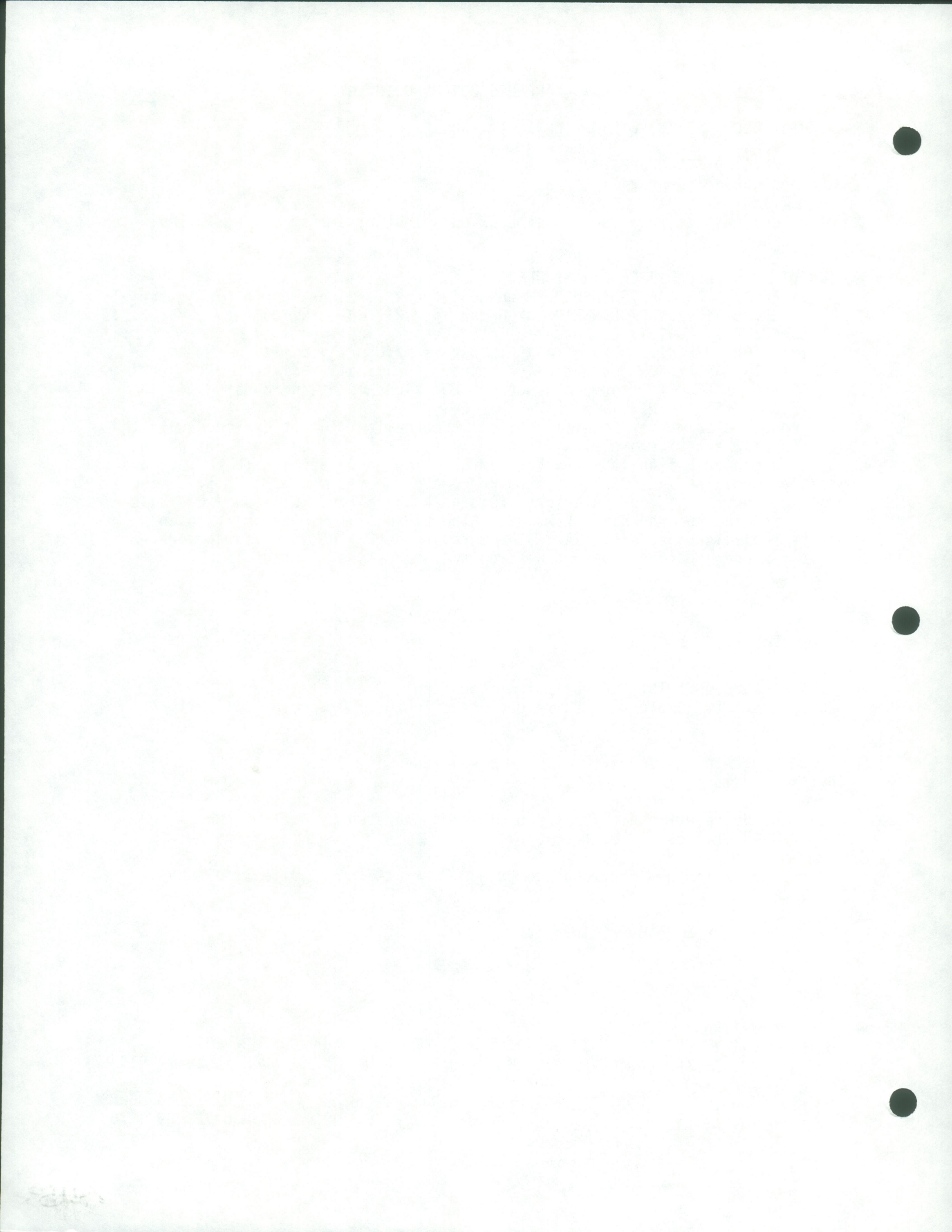

ELLIS LAWRENCE BUILDING SURVEY  
 HISTORIC NAME: GILLILAND, LEWIS T., HOUSE

RECENT PHOTO  
 NEGATIVE #s:  
 KLR13, #1

*First # above  
 is upper-right  
 photo; second #  
 is just below.  
 If no # above,  
 see sources at  
 bottom of page.*

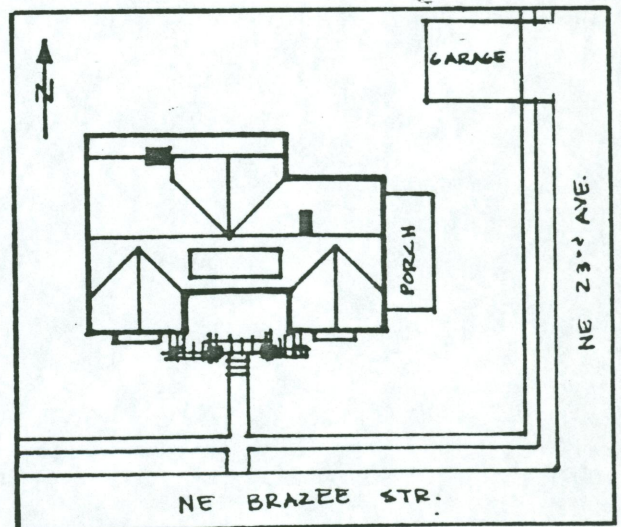
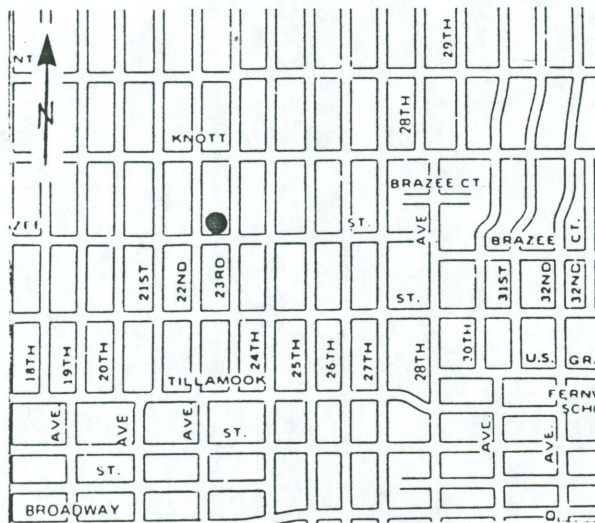

HISTORIC PHOTO/OTHER GRAPHIC SOURCE: K. Lakin and S. Donovan



2113

OREGON INVENTORY OF HISTORIC PROPERTY  
ELLIS LAWRENCE BUILDING INVENTORY

EVALUATION

HISTORIC NAME: GILLILAND, LEWIS T., HOUSE

<u>INTEGRITY OF:</u>	<u>NUMERICAL</u>
1. EXTERIOR: Essentially intact as originally built.	9
2. INTERIOR: Essentially intact as originally built.	9
3. SITE: Essentially intact as originally built.	9
4. SETTING: Historic character & relationship of surroundings is intact.	5
<b>INTEGRITY TOTAL</b>	<b>32</b>

<u>DISTINCTION OF:</u>	
1. EXTERIOR DETAILS & CRAFTSMANSHIP: High-quality skilled work: some fine materials.	7
2. INTERIOR DETAILS & CRAFTSMANSHIP: High-quality skilled work: some fine materials.	7
3. STYLE: (Arts & Crafts) It is a prime example of its identified style.	5
Compared to Lawrence's other surviving Oregon buildings, this style is one of several (6 or more) in its city/town or rural area.	0
4. ORIGINAL USE: (residence) Compared to Lawrence's other surviving Oregon buildings, this use is one of several (6 or more) in its city/town or rural area.	0
5. ARCHITECTURAL DESIGN: Compared to Lawrence's other surviving Oregon buildings, this design is above average quality, published, & of national significance	7
Is it part of an ensemble of surviving buildings by Lawrence? Lawrence building(s) nearby; but arrangement is not ordered.	5
Are structural or technical aspects of the design significant? Of moderate significance.	5
6. LAWRENCE'S PERSONAL INVOLVEMENT IN THE DESIGN PROCESS: Lawrence is known to have been the chief designer.	9
<b>DISTINCTION TOTAL</b>	<b>45</b>

<u>EDUCATIVE OR ASSOCIATIVE VALUE:</u>	
1. HISTORIC EVENTS OR ACTIVITIES: No known association with historic events or activities.	0
2. HISTORIC PERSONS: No known association with a significant historic person.	0
3. SYMBOLIC ASSOCIATION WITH AN IDEAL, INSTITUTION, OR POLITICAL ENTITY: No known significant symbolic association.	0
<b>EDUCATIVE OR ASSOCIATIVE TOTAL</b>	<b>0</b>
<b>GRAND TOTAL</b>	<b>77</b>
<b>RANK:</b>	<b>PRIMARY</b>

NOTE: Only the built, surviving buildings in Oregon were evaluated.

