

**Historic
Resource
Inventory**
CITY OF PORTLAND, OREGON



6-890-01927

1927 N.E. Tillamook Street

Irvington, Block 35, Lots 11, 12
QUARTER SECTION MAP #: 2832
Irvington

ORIGINAL FUNCTION: Residence

DATE BUILT: 1893

STYLE: Twentieth Century Colonial

ORIGINAL OWNER: Chamberlain, George

TAX ASSESSOR'S ACCOUNT #: R-42040-7530

ZONING: R5

Rank II

HISTORIC DISTRICT: Irvington (potential)

SPECIAL FEATURES AND MATERIALS:

Gambrel roof with shed-roofed dormers. Pavilions on east and west sides with second-story balconies. Polygonal bay window. Bevel siding.

SPECIAL F/M - ORIGINAL REMOVED:

Porch partially enclosed.

AREAS OF SIGNIFICANCE: Government, Law in association with George Chamberlain

Historic Resource Inventory
City of Portland
OREGON

4-21-77
KIMBERLY DAVIS

6-000-0107

1937 W. 11th Street

Livingston, Block 35, Lots 11-13

QUARTER SECTION MAP # 2812

Livingston

ORIGINAL FUNCTION: Residence

DATE BUILT: 1911

STREET: Southwest Oregon Colonial

ORIGINAL OWNER: C.A. Perkins, George

TAX ASSESSOR'S ACCOUNT #: 4-1200-75

OWNER: 851

Block 11

HISTORIC DISTRICT: Livingston (potential)

SPECIAL FEATURES AND MATERIALS:

Garage roof with shed-roofed dormer. Pavement on east and west sides with second-story balconies. Polynesian bay window. Bayed chimney.

SPECIAL VA - ORIGINAL RECORD:

Partially obscured.

Notes on SIGNIFICANCE: Government, 150 in association with George Chamberlain

6-890-01927

Government, Law in association with George Chamberlain: Chamberlain (1854-1928) was born near Natchez, Mississippi and graduated from Washington and Lee University with a law degree in 1876. He came to Oregon the same year and practiced law in Linn County until appointed attorney general of the state in 1891. In 1900 he was chosen district attorney for Multnomah County. He then was elected Democratic Governor of Oregon, serving two terms, 1902-1909. He was elected U.S. Senator in 1909. He played an important role in the senate, formulating World War I selective service draft and food control measures. He also served as a member of the U.S. Shipping Board, 1920-1928.

BIBLIOGRAPHY:

City of Portland Buildings Bureau microform and card files.

Multnomah County Tax Assessor records, microform, automated data files, and card files (Portland, 1980).

Corning, Howard M., *DICTIONARY OF OREGON HISTORY* (Portland, 1956).

Present owner as of May 1981: Robert C. and Sunnie L. Baumann Jr.
MAILING ADDRESS: 1927 N.E. Tillamook Street, Portland 97212

No Preservation Funding

Negative: 902-6

Score - Design/Construction: 5
Score - Historical: 10
Score - Rarity:
Score - Environment: 10
Score - Integrity: 2
Score - Intrinsic: 5
Score - Contextual: 12
Score - Total: 64.5

Government, then in association with George Chamberlain Chamberlain
(1844-1918) was born near Wiscasset, Maine, and graduated from Wiscasset
and Maine University in 1870. He came to Oregon the same year
and practiced law in Multnomah County until appointed attorney general of the state
in 1871. In 1880 he was chosen district attorney for Multnomah County. He
then was elected district attorney of Oregon, serving two terms, 1897-1903.
He was elected U.S. Senator in 1909. He played an important role in the
separate, formulating World War I selective service bill and food control
measures. He also served as a member of the U.S. Shipping Board, 1910-1918.

BIBLIOGRAPHY:

City of Portland and Multnomah County records, 1870-1918.
Multnomah County Tax Assessor records, microform, indexed data files, and
city files (Portland, 1960).
Gortals, Howard H., DICTIONARY OF OREGON HISTORY (Portland, 1956).
Present owner as of 1961: Robert C. and Susan C. Gortals, 11
WATLING STREET, 1011 N. 21st Street, Portland, OR 97217

NO ASSASSINATION FOUND

Revised: 10/2/61

Score - Best/Construction: 7
Score - Historical: 10
Score - Family: 10
Score - Environment: 10
Score - Intellectual: 10
Score - Intuitive: 10
Score - Contentment: 10
Score - Total: 77

Albina Community Historic Resources Inventory

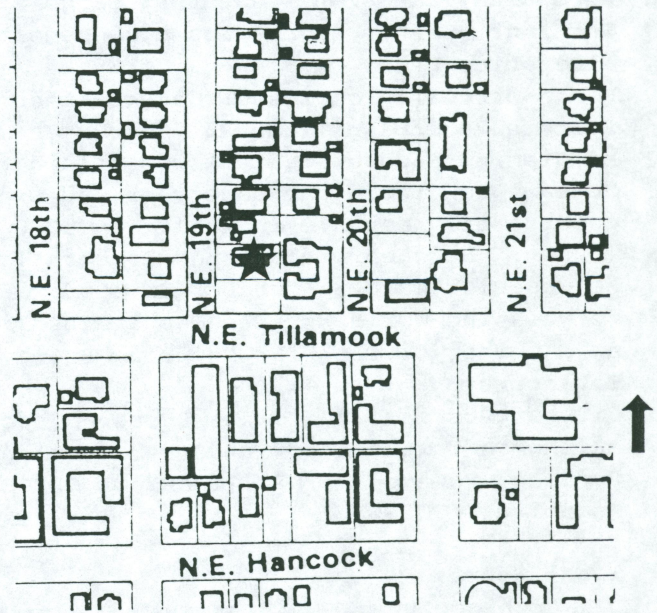
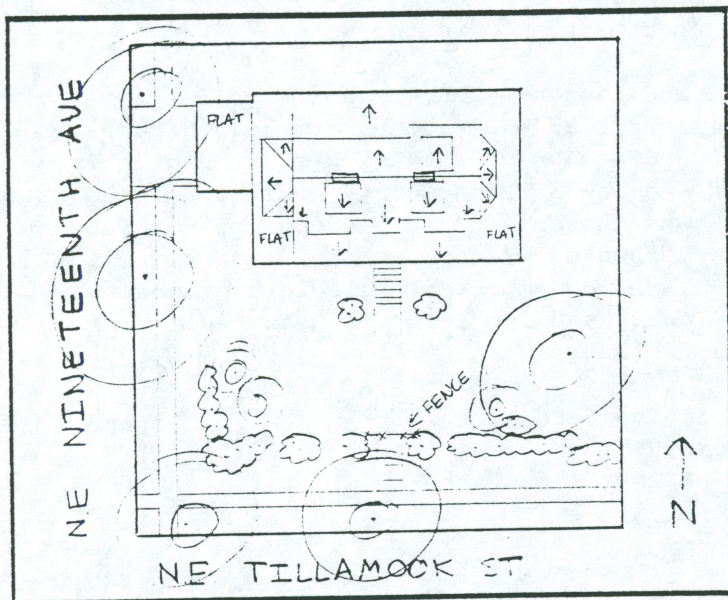

ADDRESS: 1927 NE TILLAMOOK

2208

6-890-01927

1927 N.E. Tillamook Street

Irvington, Block 35, Lots 11, 12

Present owner as of 1993: Stephen Bailey and Richard Johnston

Rank: National Register

Neighborhood Association: Irvington

Historic District: Irvington

Tax Assessor #: R-42040-7530

Quarter Section Map #: 2832

Zoning Designation: R5ad

Date Built: 1893

Original Owner: George Chamberlain

Other Owners: Robert and Sunnie Baumann

Original Function: Residence

Present Function: Residence

Style/Typology: Twentieth Century Colonial

Theme: Government/Military; Architecture

Chronological Period: The Progressive Era 1884-1913

Resource Type: Building

Plan Type/Shape: Rectangular

Foundation Material: Concrete, Brick

Frame: Wood

Roof: Gambrel; Composition Shingle

Primary Window Type: Six-Over-One Double Hung

Number of Stories: 2.5

Basement: Yes

Exterior Surface Materials: Bevel

Decorative Features: Gambrel roof with shed-roofed dormers. Pavilions on east and west sides with second-story balconies. Polygonal bay window.

Condition: Good

Noteworthy Landscape Features: Large street trees.

Setting: Corner double lot high density apartment area to the south.

Alteration Data:

Porch partially enclosed. Garage attached addition to west.

Statement of Significance: George Chamberlain (1854-1928) was born near Natches, Mississippi and graduated from Washington and Lee University with a law degree in 1876. He came to Oregon the same year and practiced law in Linn County until appointed attorney general of the state in 1891. In 1900 he was chosen district attorney for Multnomah County. He then was elected Democratic Governor of Oregon, serving two terms, 1902-1909. He was elected U.S. Senator in 1909. He played an important role in the Senate, formulating World War I selective service draft and food control measures. He also served as a member of the U.S. Shipping Board, 1920-1928.

Bibliography:

City of Portland Buildings Bureau microform and card files.

Multnomah Tax Assessor records (Portland, 1993).

Corning, Howard M., DICTIONARY OF OREGON HISTORY (Portland, 1956).

Negative: 902-6

Total Score:

Architecture:

History:

Integrity:

Environment:

Ensemble: