

**Historic  
Resource  
Inventory**  
CITY OF PORTLAND, OREGON



6-487-01828

1828 N.E. Knott Street

Irvington, Block 38, Lots 1, 2  
QUARTER SECTION MAP #: 2732  
Irvington

ORIGINAL FUNCTION: Residence

DATE BUILT: ca. 1915

STYLE: Arts and Crafts

TAX ASSESSOR'S ACCOUNT #: R-42040-8070

ZONING: R5

HISTORIC DISTRICT: Irvington (potential)

**SPECIAL FEATURES AND MATERIALS:**

Low-pitch hip roof with shed-roofed dormer. Segmental pediment over entry. Recessed front porch with Tuscan columns. Exterior finish of stucco with mock half-timbering.

AREAS OF SIGNIFICANCE: Architecture

6-487-01828

**BIBLIOGRAPHY:**

*City of Portland Buildings Bureau microform and card files.*

*Multnomah County Tax Assessor records, microform, automated data files, and card files (Portland, 1980).*

*Present owner as of May 1981: Martha L. Swan*

*MAILING ADDRESS: 1828 N.E. Knott Street, Portland 97212*

*No Preservation Funding*

*Negative: 798-2*

*Score - Design/Construction: 6*

*Score - Historical:*

*Score - Rarity:*

*Score - Environment: 6*

*Score - Integrity: 10*

*Score - Intrinsic: 6*

*Score - Contextual: 10*

*Score - Total: 31*

Albina Community Historic Resources Inventory

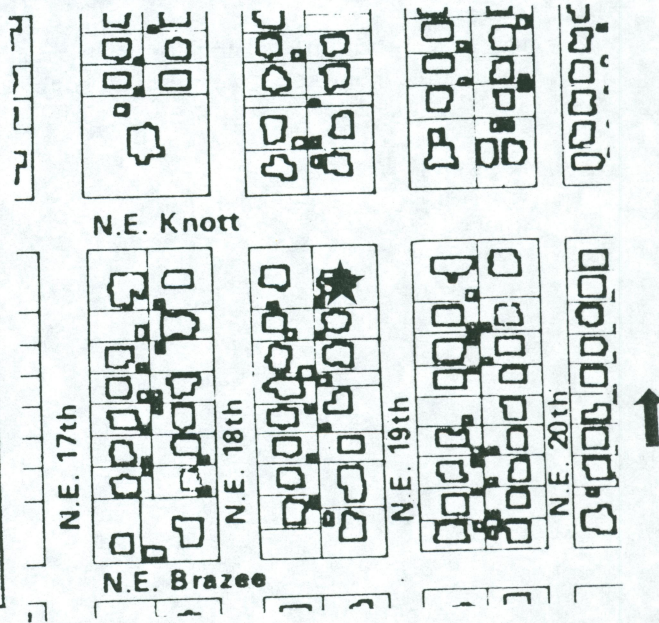
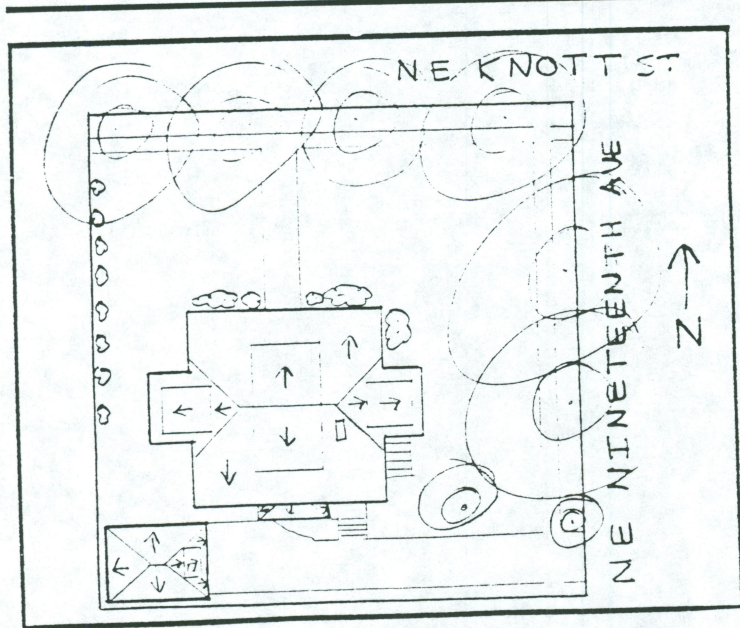

ADDRESS: 1828 NE KNOTT ST.

2119