

STATE OF OREGON INVENTORY
OF HISTORIC PROPERTIES
State Historic Preservation Office
Oregon State Parks, Salem, OR 97310

County Washington
 Theme Architectural Development
 Name (Common) Redwine House
 (Historic) Sholes House
 Address 1599 S. Alpine Street
Cornelius, Oregon 97113
 Present Owner Joe & Katherine Redwine
 Address 1599 S. Alpine Street
 Original Use Residence
 Date of Construction 1909



REDWINE HOUSE

Physical description of property and statement of historical significance:

The Sholes house is a private residence in the Georgian Revival style with the elements of Arts and Crafts, built in 1909. The house faces north and is on a corner lot in a residential neighborhood at the end of a street. Mr. A. S. Sholes platted 91 fifty foot lots in the first Cornelius subdivision called Pleasantview Addition and built his house on the three northeastern most lots. The next three (3) houses to the west on this same block were built for family members during the same time period. Other houses in the immediate neighborhood were constructed from the early twentieth century up to and including this last decade. The neighborhood still retains the 1900's character and charm.

This rectangular shaped house has eighteen rooms contained in three (3) stories, plus a full basement. The foundation and basement are of concrete. A drawing of the first floor plan is attached. The library is located on the second floor, along with a guest bedroom, master bedroom and sunroom. The third floor contains a large billard room. The outer walls of the house are covered with horizontal shiplap siding. The roof is a gabled roof with a third story front dormer. The eaves are exposed rafters which display the Arts and Crafts influence. All drain troughs are of copper.

The house has a large balconied porch which surrounds the house on the front, or north, and half the east and west sides. They add to the symmetrical facade of the house. The porch on the east elevation has a lattice roof and is reached by French doors from the living room. The west side of the porch is reached by a door with a beveled glass window, from

CONTINUE ON BACK IF NECESSARY

Recorded by Stephen C. Goodrich Date June 30, 1981

Sources consulted (continue on back if necessary):

- Katherine Redwine
- Tom Sholes
- Marge Wintermute - George McMath Architects

Please enclose map. Township 1 (S) 3 (W) Section 4AA

CONTINUED FROM FRONT

the breakfast room, and has a shed roof. The front entry has a shed roof with a column supported arch. The service entry porch contains a toilet and sink and an entry to the kitchen and maid's quarters.

There is one stained glass window located in the south wall of the dining room above the built-in buffet. The front windows, located in the living room and breakfast room, do not open. The tops are of leaded glass and the bottoms are of beveled glass. The top window above the staircase landing is also of leaded glass. Three windows above the front entry are diamond shaped panel windows. The second story double hung front bedroom windows each have flower boxes with supports that match the eaves. Other windows in the house are double hung. The front door also has a beveled glass window three-fourths the length of the door. There are matching windows on either side of the door.

The two (2) chimneys are of clinker brick. The east chimney begins at ground level. The interior workmanship features hardwood floors of 5/8" eastern quarter sawn white oak with a surrounding two foot wide border of the same material.

The pocket doors in the living room and breakfast room are 1-3/4" eastern oak. There is a built-in buffet in the dining room and a built-in linen closet of Port Orford cedar. The stair bannister and columns are of Oregon yellow fir, selected for their natural finish. On the lower stair landing is a built-in seat with hinged lid.

The entry and dining room ceilings have ten in-beams in a rectangular pattern. Other significant features of this house are speaking tubes between the kitchen and second floor, an annunciator located in the kitchen, and the original velvet drapes. There are also a dumb-waiter and wood lift, which have been removed for safety.

The front entry has four (4) Edison light bulbs attached to the 10" wood beams. In the center of the entry is a chandelier of three (3) globes etched with a grape design. The living room has a matching chandelier with five (5) globes in it. A Stuben chandelier in the center of the dining room has five (5) globes, and one matching Stuben light fixture on each side of the buffet. The house included three (3) fireplaces. One is located on the 2nd floor, in the library. Another one is located in the living room, with a mantel matching the room's woodwork. The front of the fireplace is of plain 8" ceramic tile.

The breakfast room fireplace is of particular interest, as it is in the shape of an arch and constructed of stone. The arch is similar to arches found in old Portland buildings, such as the Dekum Building, which Richard Martin, Jr. also designed. He was the architect of the Sholes house.

Much of the landscaping is the original. The wisteria still grows over the lattice work of the east porch. There is a two-car garage located to the back of the lot, which includes a pit for making car repairs easy, and a ten foot well, all bricked.

The Sholes house was built in 1909. It was the first house in the Pleasant View addition. Pleasant View was the first subdivision in Cornelius and one of the first subdivisions in Washington County. It was platted in 1909. The original owner of the house was Mr. Albert Seymour Sholes. He built three houses in the same block. The house next door was occupied by his son Frank. Mr. Sholes was an early mayor of Cornelius. He also owned the Cornelius State Bank which he bought in 1906 and operated until his death in 1932. The name "Banker's Row" was given to the street because of his and his son's activities with the bank. A number of community activities occurred at the house including a number of funerals which were conducted there. Mr. Sholes was instrumental in forming the Cornelius Volunteer Fire Department, an organization which has provided continuous fire protection for the town up to the present. In 1933 the house was sold to Percy Hillis. Mr. Hillis ran the local hardware store and was a mayor of Cornelius for a number of years. The house was sold in 1967 to Joe and Katherine Redwine. Mrs. Redwine served four years on the Cornelius City Council. The house is now visited regularly by school classes, civic groups, and other interested individuals who are interested in the house and its history. Finally, besides the personalities involved that create the history surrounding this house, the house itself because of its design makes the house of significant historical interest.

FOREST GROVE QUADRANGLE
 OREGON-WASHINGTON CO.
 7.5 MINUTE SERIES (TOPOGRAPHIC)

15° 11' 14" N
 123° 11' 14" W
 (DIXIE MTN.)

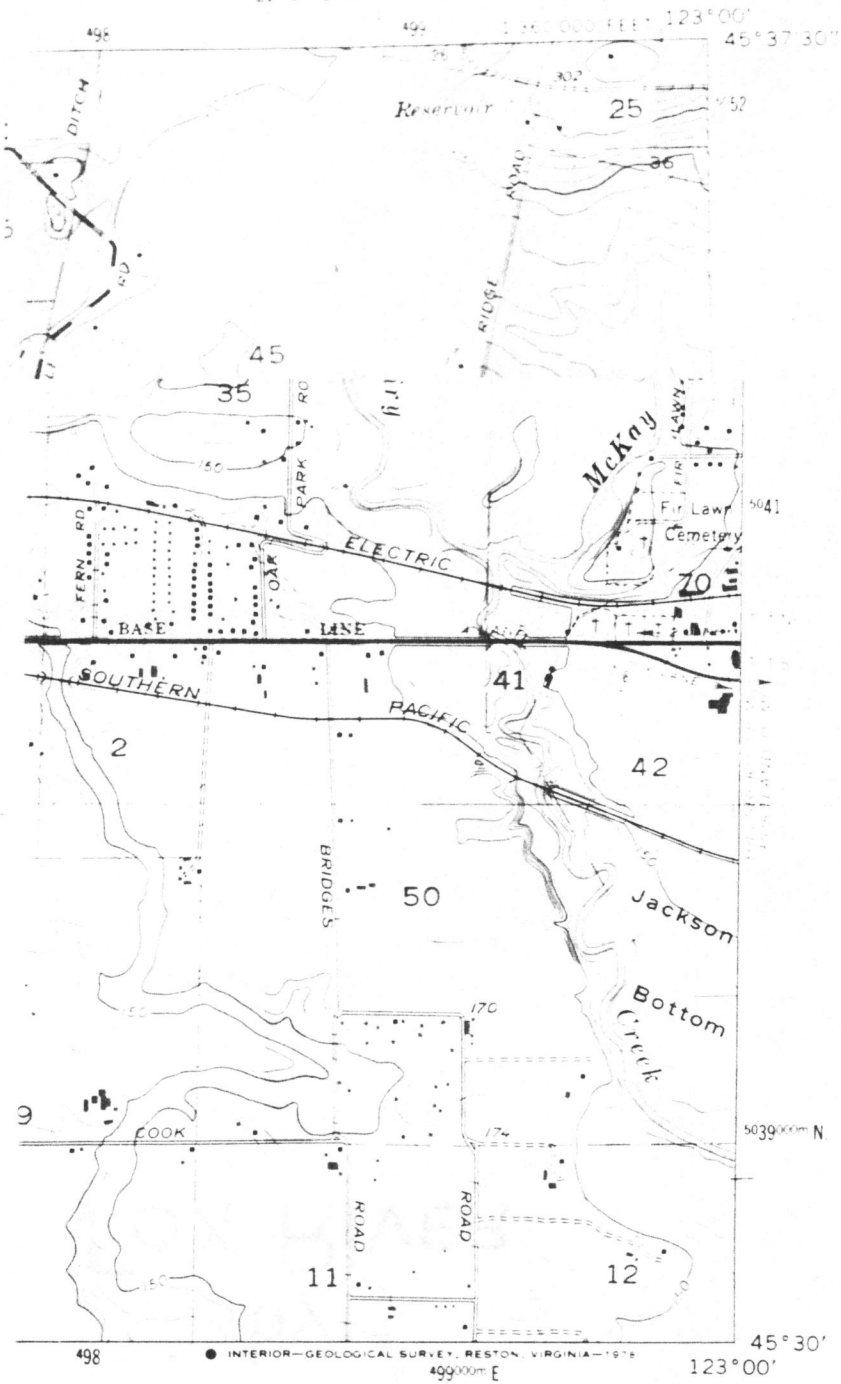

● INTERIOR-GEOLOGICAL SURVEY, RESTON, VIRGINIA-1975
 499000m E

5039000m N

ROAD CLASSIFICATION

- Heavy-duty ————— Light-duty —————
- Medium-duty ———— Unimproved dirt - - - - -

- U.S. Route ○ State Route

SHOLES (ALBERT S.) HOUSE
 FOREST GROVE, OREG.

SE 4 FOREST GROVE 15 QUADRANGLE
 N4530—W12300/7.5

1956

PHOTO REPRODUCED 1970 AND 1975
 AMS 1375 II SE-SERIES 4892

10/496020/5040400

(SCHOLLS)
 1274 N W

FOX RIVER
by
FOXLINE BOOKS

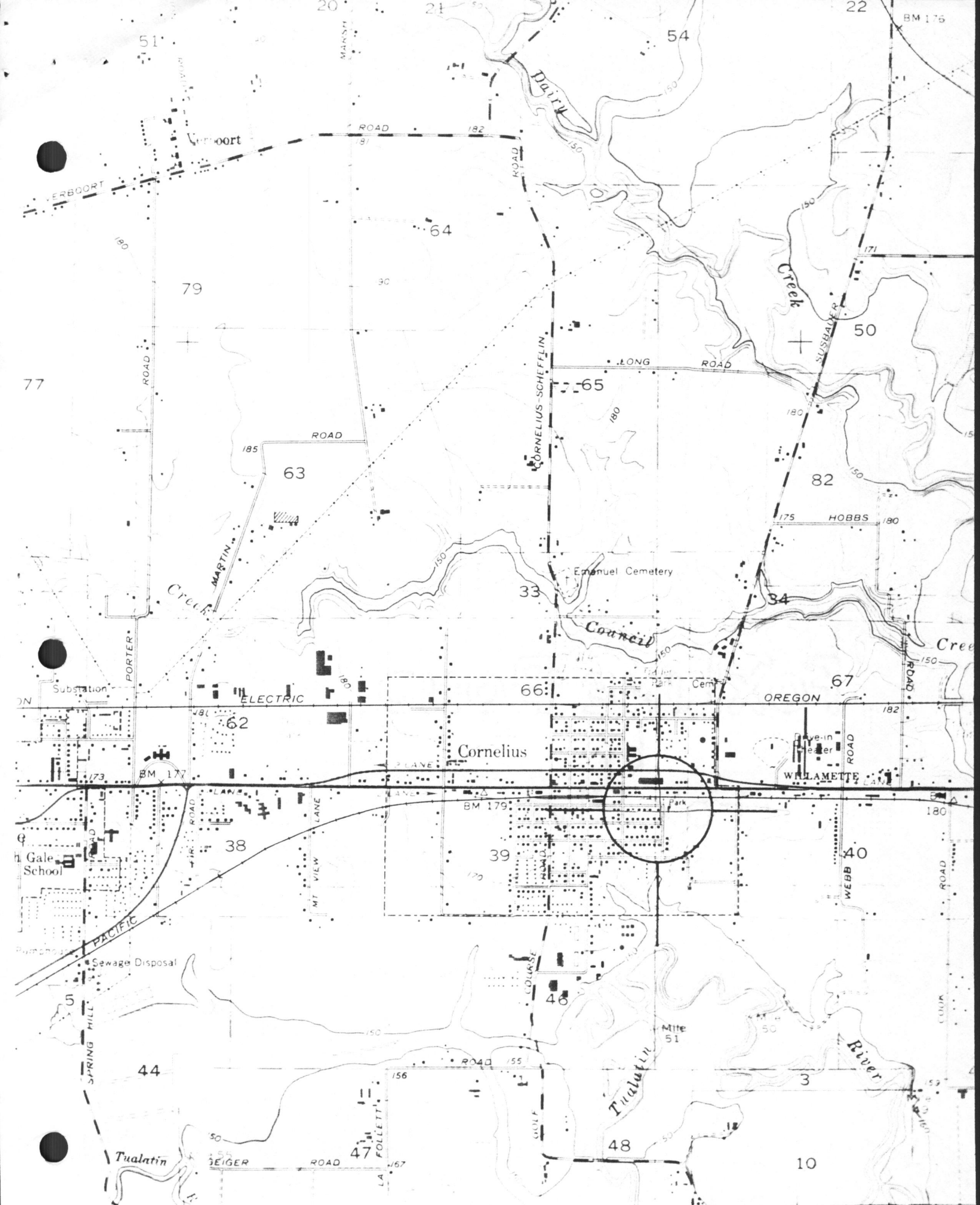

(LAURELWOOD)
1374 NE
SCALE 1:24,000

2' 30" 49'

WATERLINE PROJECT
by
FOY RIVER