

CITY OF SEASIDE  
INVENTORY OF HISTORIC PROPERTIES  
HISTORIC RESOURCE SURVEY

**HIST. NAME:** V. Shepard House  
**COMMON NAME:**  
**ADDRESS:** 140 Avenue 'T'  
**OWNER:** Carol Sue Rees, 208 North Holladay, Seaside  
**MAP NO.:** 21 CD      **TAX LOT:** 5900  
**ADDITION:** Cartwright Park  
**BLOCK:** 5      **LOT:** 11, 12  
**QUAD:** N4552.5 - W12352.5/7.5, Tillmook Head, Oregon

**DATE OF CONSTRUCTION:** c. 1925  
**ORIGINAL USE:** Residence  
**PRESENT USE:** Residence  
**ARCH. BLDR.:**  
**STYLE:** Oregon Rustic  
**RESOURCE TYPE:** Building  
**THEME:** Arch. - 20th c.

**PLAN TYPE/SHAPE:** Asymmetrical      **NO. OF STORIES:** 1  
**FOUNDATION MATERIAL:** Concrete block      **BASEMENT:** No  
**ROOF FORM & MATERIALS:** Low-pitched hip and intersecting gable w/wood shakes.  
**WALL CONSTRUCTION:** Wood      **STRUCTURAL FRAME:** Unknown  
**PRIMARY WINDOW TYPE:** Double hung sash. Multi-light casement.

**EXTERIOR SURFACING MATERIALS:** Peeled half logs and shingles.  
**DECORATIVE FEATURES:** Window muntins, s. elevation. Dutch door. Rock and stucco chimney.  
**OTHER:** Low pitched shed roof w/peeled log posts. Exposed rafters, purlins and rafters.  
**CONDITION:** Good. Some deterioration to porch posts.

**EXTERIOR ALTERATIONS/ADDITIONS (DATED):** Flat roof attachment w/o foundation, n. elevation, n.d. Windows altered, w. elevation, n.d.

**NOTEWORTHY LANDSCAPE FEATURES:** Laurel hedge along s. and w. property line. Conifers along s. and e. property line. Mature conifer at nw corner of lot.

**ASSOCIATED STRUCTURES:** One story garage w/narrow bevel siding and wood shingle roof in poor condition.

**SETTING:** On nw corner of Avenue T and Columbia, lightly traveled roads. In area of post World War II era residences.

**STATEMENT OF SIGNIFICANCE:** See attached page.

**SOURCES:** See attached page.

**RECORDED BY:** Koler, Morrison, & Cavin  
**DATE:** 1987

**SHPO INVENTORY NO.:** 732

CITY OF SEASIDE  
INVENTORY OF HISTORIC PROPERTIES  
HISTORIC RESOURCE SURVEY FORM  
(Continuation Form)

140 Avenue T

Statement of Significance:

Designed in the Oregon Rustic style, the Vilas D. Shepard House is a singular example of the log building type in Seaside dating from the historic period. This style shared philosophical roots with the grand resort lodges built in the National Parks during the early years of this century. Harmonizing with the landscape was the prime objective of Oregon Rustic affectionados.

Architectural clues indicate that Shepard's House was constructed in the mid 1920's. Shepard purchased the property in 1925, selling it in 1930.

Notable architectural features include the rock and stucco chimney; the wood shake roof, and the peeled log and shingle exterior walls. Multi-light casement windows and decorative muntins further contribute to the rustic ambience.

Shepard was a state legislator from Clatskanie, Columbia County. The house was sold to Theresa Stampler in 1930, she owned it until 1954.

Sources:

TICOR Title Co. Records. Astoria, Oregon.  
Beaverton Cultural Resource Inventory, 1986.

**CITY OF SEASIDE  
INVENTORY OF HISTORIC PROPERTIES  
HISTORIC RESOURCE SURVEY FORM**

**ADDRESS:** 140 Avenue T

**MAP NO.:** 21CD

**TAX LOT:** 5900



\*\*\*\*\*

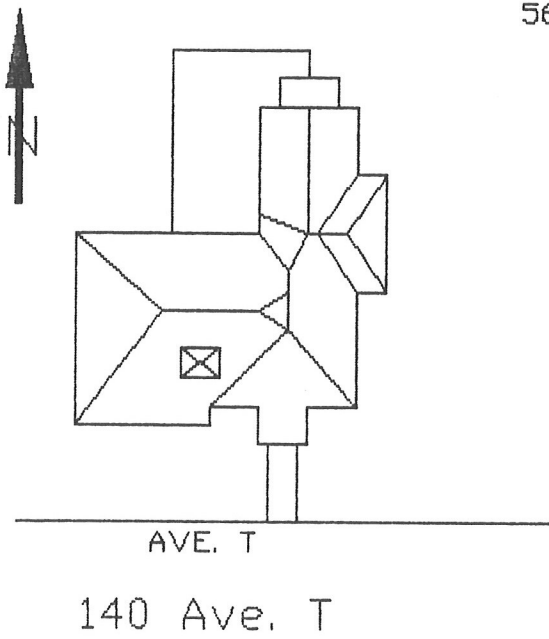

56

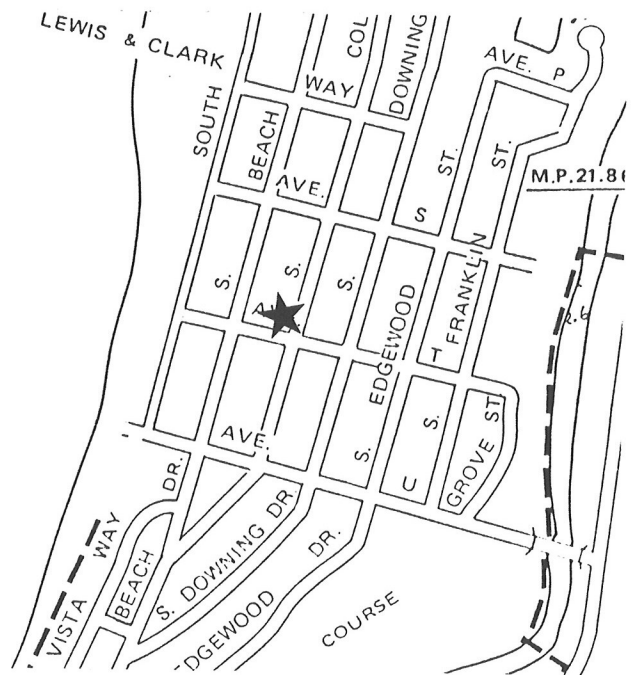

**NEGATIVE NO.:** 2 #17  
**SLIDE NO.:**

**SHPO INVENTORY NO.:** 732