

OREGON INVENTORY OF HISTORIC PROPERTIES
HISTORIC RESOURCE SURVEY FORM
COUNTY: CLATSOP

HIST. NAME: BPOE No. 180 Lodge
COMMON NAME: Elks Temple Lodge
ADDRESS: 453 Eleventh Street

DATE OF CONSTRUCTION: 1924
ORIGINAL USE: fraternal lodge
PRESENT USE: fraternal lodge

CITY: Astoria, 97103
OWNER: Astoria Lodge #180, B.P.O.E.

ARCHITECT: Charles T. Diamond
BUILDER: Hilmer J. Settergreen
THEME: culture & architecture
STYLE: american renaissance

T/R/S: T8N/R9W/S8
MAP NO.: 80908 CC TAX LOT: 2000

ADDITION: McClure's Astoria xBLDG STRUC DIST SITE OBJ
BLOCK: 46 LOT: 5, 6 QUAD: Astoria

PLAN TYPE/SHAPE: rectangular
FOUNDATION MATERIAL: concrete/pier
ROOF FORM & MATERIALS: flat/built up
WALL CONSTRUCTION: reinforced conc
PRIMARY WINDOW TYPE: 1/1 double hung,
EXTERIOR SURFACING MATERIALS: brick

NO. OF STORIES: three
BASEMENT: yes
STRUCTURAL FRAME: reinf conc

frame; fixed in aluminum sash with wood frame
DECORATIVE FEATURES: terra cotta cornice and entry; patterned bricks
OTHER: pressed tin above cornice; marble columns near entry

CLASSIFICATION: secondary

STRUCTURAL STATUS: xGOOD FAIR POOR MOVED (DATE)

HISTORICAL INTEGRITY: slightly altered

EXTERIOR ALTERATIONS/ADDITIONS: original entry is now a trophy case,
main entry moved to center of east elevation; display windows replaced
with like size in aluminum sash

NOTEWORTHY LANDSCAPE FEATURES: none

ASSOCIATED STRUCTURES: none

KNOWN ARCHAEOLOGICAL FEATURES: none

SETTING: NW corner, 11th and Exchange; three elevations exposed

STATEMENT OF SIGNIFICANCE: The architect for this building was Charles
T. Diamond. General contractor, Hilmer J. Settergreen of Portland,
with a low bid of \$136,000, was awarded the building contract October
6, 1923. The \$250,000 temple was used for lodge puposes for the first
time on February 23, 1925. The building was formally dedicated March
27, 1925. This building was placed on the National Register of
Historic Places in June of 1990.

SOURCES: Sanborn Fire Insurance Maps; Astoria Evening Budget, October
12, 1923, February 23, 1925, March 28, 1925

NEGATIVE NO: R4 N14

RECORDED BY: NCLC

DATE: 12/13/89

1102

6/14/90

SHPO INVENTORY NO.: 1102

OREGON INVENTORY OF HISTORIC PROPERTIES
 HISTORIC RESOURCE SURVEY FORM
 COUNTY: CLATSOP

PROPERTY: Elks Temple Lodge
 ADDRESS: 453 Eleventh Street
 TAX I.D.: 51187

T/R/S: T8N/R9W/S8
 MAP NO.: 80908 CC
 QUAD.: Astoria



NEGATIVE NO.: R4 N14

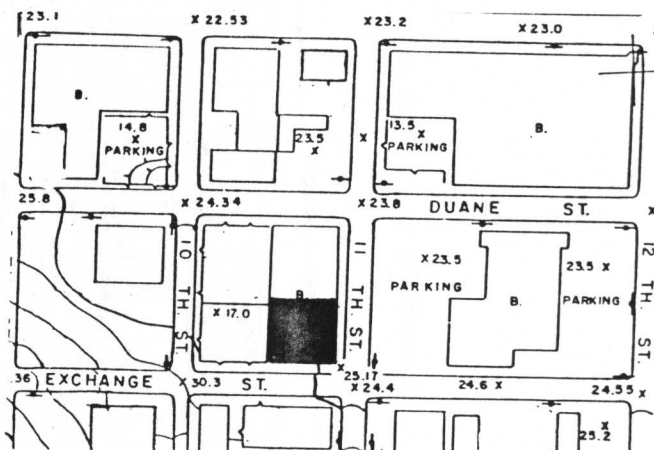
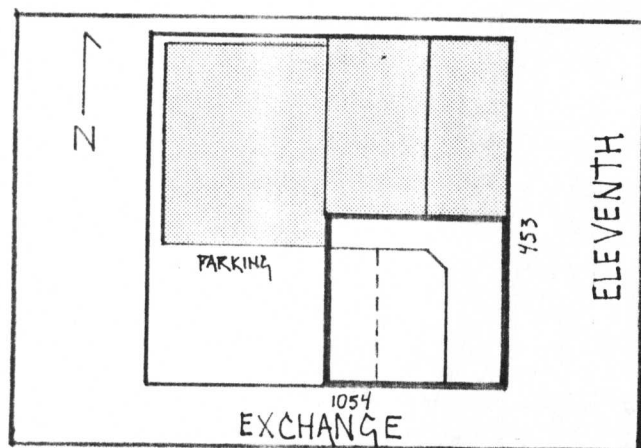

TOPOG. DATE: 1967

GRAPHIC & PHOTO SOURCES: N.C.L.C.; CITY OF ASTORIA, ENGINEERING DEPT.
 S.H.P.O. INVENTORY NO.: