

OREGON INVENTORY OF HISTORIC PROPERTIES
HISTORIC RESOURCE SURVEY FORM
COUNTY: CLATSOP

HIST. NAME: Hotel Astoria
COMMON NAME: John Jacob Astor Apts
ADDRESS: 342 Fourteenth Street
1405-1431 Commercial
1418 Duane

DATE OF CONSTRUCTION: 1923
ORIGINAL USE: hotel
PRESENT USE: apartments, office

CITY: Astoria, 97103
OWNER: Oregon Landmark One, Ltd.

ARCHITECT: Tourtellotte & Hummel
BUILDER: Thomas Muir
THEME: commerce & urban dev.
STYLE: Gothic

T/R/S: T8N/R9W/S8
MAP NO.: 80908 CA TAX LOT: 6600
ADDITION: Shively's Astoria
BLOCK: 135 LOT: 4 thru 6 QUAD: Astoria

xBLDG STRUC DIST SITE OBJ

PLAN TYPE/SHAPE: L-shaped
FOUNDATION MATERIAL: conc/wood post
ROOF FORM & MATERIALS: flat/built-up
WALL CONSTRUCTION: reinforced conc
PRIMARY WINDOW TYPE: 1/1 double hung, multi-paned casement in wood frame; fixed in aluminum and wood frame
EXTERIOR SURFACING MATERIALS: finished and unfinished concrete
DECORATIVE FEATURES: pilasters capped by spires; string course
OTHER: mezzanine colonade; medallions on capitals of lower pilasters

NO. OF STORIES: eight
BASEMENT: yes

STRUCTURAL FRAME: reinf conc

CLASSIFICATION: secondary
STRUCTURAL STATUS: xGOOD FAIR POOR MOVED (DATE)
HISTORICAL INTEGRITY: slightly altered
EXTERIOR ALTERATIONS/ADDITIONS: exterior stair tower added to east elevation in 1985; earlier, many transoms covered over and some display windows infilled or replaced; south entrance to lobby and its side lights infilled with cinder blocks; all alterations confined to first two levels

NOTEWORTHY LANDSCAPE FEATURES: none
ASSOCIATED STRUCTURES: none
KNOWN ARCHAEOLOGICAL FEATURES: none

SETTING: East side of 14th Street, between Commercial and Duane; free standing; parking to east

STATEMENT OF SIGNIFICANCE: The board of directors of the Columbia Hotel Company awarded Portland contractor Thomas Muir the contract for the construction of their hotel building on November 1, 1922. Mr. Muir had submitted a bid of \$169,428. On November 3, 1922, a building permit in the amount of \$225,000 was issued to Muir. Plans and specifications were drawn by the Portland firm of Tourtellotte &

Hummel and local architect Charles Templeton Diamond, who also functioned as the resident architect. The foundation of the proposed eight-story building had been completed prior to the December, 1922 fire and on January 5, 1923, it was announced that the foundation would be rebuilt and construction plans would proceed forthwith. Although the hotel's first guests were signed in on January 1, 1924, formal dedication of the building did not take place until February 22nd. After many years of financial troubles and management problems, the building was closed in 1968. In November, 1983, Clatsop County commissioners approved plans for renovation of the hotel and the land development company of Pingree & Dahle, Inc., secured a lease on the property. During 1984-85 the building underwent remodeling, refurbishing and repainting and the newly-named John Jacob Astor Apartments welcomed its first tenant in June of 1986. This property was placed on the National Register of Historic Places in November 16, 1979.

SOURCES: Sanborn Fire Insurance Maps; Astoria Evening Budget, January 5, 1923, March 13, 1923, January 1, 1924, February 22, 1924; The Morning Astorian, November 2, 1922, November 4, 1922; The Daily Astorian, October 25, 1984, June 27, 1986; Astoria and Clatsop County Telephone Directory; Polk's Astoria and Clatsop County Directory

NEGATIVE NO: R7 N14

RECORDED BY: NCLC

DATE: 12/19/89

6/19/90

SHPO INVENTORY NO.: 1112

OREGON INVENTORY OF HISTORIC PROPERTIES
 HISTORIC RESOURCE SURVEY FORM
 COUNTY: CLATSOP

PROPERTY: John Jacob Astor Apts.
 ADDRESS: 342 Fourteenth Street
 TAX I.D.: 51072

T/R/S: T8N/R9W/S8
 MAP NO.: 80908 CA
 QUAD.: Astoria



NEGATIVE NO.: R7 N14

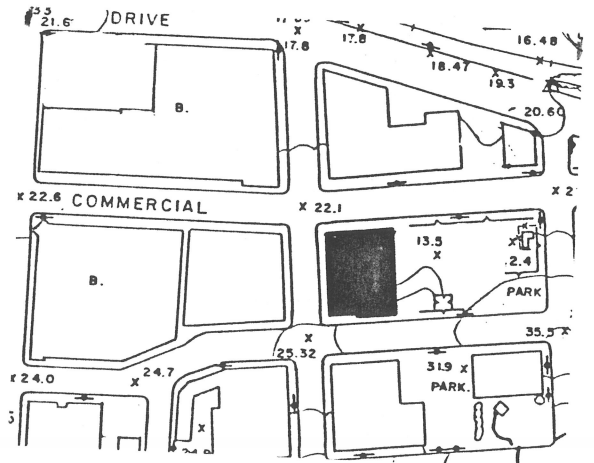
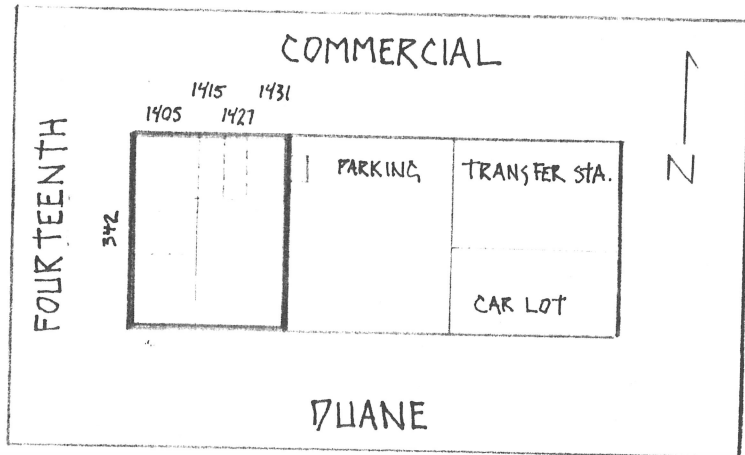

TOPOG. DATE: 1967

GRAPHIC & PHOTO SOURCES: N.C.L.C.; CITY OF ASTORIA, ENGINEERING DEPT.
 S.H.P.O. INVENTORY NO.:

1112