

Cultural Resource Survey Form:

CLACKAMAS COUNTY

I. D. NUMBER _____

PHOTO INFORMATION:

ROLL: XLVIII
FRAME: 2

STUDY AREA: CANBY/BARLOW
LEGAL: T. 4 R. 1E SEC. 23BB
TAX (LOTS): 600
ZONE _____ SIZE .64

IDENTIFICATION:

COMMON/HISTORICAL NAME: MACKSBURG LUTHERAN CHURCH
ADDRESS: 10190 Macksburg Road AREA: MACKSBURG
CURRENT OWNER: Macksburg Lutheran Evangelical Church USE: Public
OWNER'S ADDRESS: Same Canby 97013
ORIGINAL OWNER: _____ USE: Public
AREA OF SIGNIFICANCE: TOWN: _____ COUNTY: X CITY: _____ NATION: _____

HISTORIC INTEREST:

THEME: Architecture - 20th Century; Culture - Religion DATE: 1910
DESCRIPTION: See attached National Register Form

ARCHITECTURAL INTEREST:

STYLE: Rural Gothic Vernacular STORIES: 1
DATE: 1910 CONDITION: Good ARCHITECT: _____
SIDING: Wide shiplap
ROOF: Gable with bell tower
DOORS: _____
WINDOWS: Pointed arch (glass, replaced)

MAIN ENTRANCE: Altered

NOTES: Bell tower has lancet windows, four gables and decorative shingles.



BIBLIOGRAPHY:

DATE: April, 1984
RECORDER: Hayden/Altier

CLACKAMAS COUNTY
HISTORIC RESOURCES INVENTORY 1989-92

HISTORIC NAME: **MACKSBURG LUTHERAN CHURCH**
COMMON NAME:
PROPERTY ADDRESS: 10190 Macksburg Road
OWNER: Macksburg Lutheran Church
OWNER ADDRESS: 10190 S. Macksburg Road, Canby, OR 97013
RESOURCE TYPE: Building
PRESENT USE: Church
ORIGINAL USE: Church
THEME: Culture: Architecture and Religion
ARCHITECT/BUILDER: Unknown
COUNTY: Clackamas
QUAD: Yoder
T/R/S: 4 1E 23BB
TAX LOT: 600
ADDITION: N/A
BLOCK: N/A
LOT: N/A
LOT SIZE: 1.12 Acres
ZONE: EFU-20/HL

SETTING: The Macksburg Lutheran Church is located on the south side of Mackburg Road, a busy, two-lane thoroughfare. The church is close to the road. The Church is located on a knoll and shares the property with a non-historic parsonage. Across the road, to the north, is an orchard and farm complex. On the south there are Christmas trees. On the east there is an orchard and an early 20th-century dwelling. On the west there is a parsonage. The area is predominantly in agricultural use.

NOTEWORTHY LANDSCAPE FEATURES: Mature deciduous trees

NON-CONTRIBUTING FEATURES: Non-historic parsonage

RECORDED BY: Koler/Morrison
DATE: December 1991



CHURCH

DATE BUILT: 1892-1894
DATE OF MAJOR REMODEL: 1989
STYLE: Gothic Vernacular
PLAN/TYPE/SHAPE: T-plan
NO. OF STORIES: 1
FOUNDATION MATERIAL: Concrete
BASEMENT: Yes
ROOF FORM AND MATERIALS: Gable w/ composition shingles
WALL CONSTRUCTION/STRUCTURAL FRAME: Wood/stud
PRIMARY WINDOW TYPE: Pointed-arch fixed w/ plain surrounds
EXTERIOR SURFACING MATERIALS: Wide drop siding w/ cornerboards, rake boards and watertable; vertical boards
DECORATIVE FEATURES: None
OTHER: Paneled door; flush door w/ shed roof overhang; bell tower w/ lancet windows w/ architrave molding, four gables and decorative shingles
CONDITION: Good
EXTERIOR ALTERATIONS (DATE): Addition, s. elev. (1989); glass replaced in windows (1977-1978); front entrance added, n. elev. (1964-1965)

STATEMENT OF SIGNIFICANCE

Address: 10190 Macksburg Road

Historic Name: **MACKSBURG LUTHERAN CHURCH**

The Macksburg Church is located along Macksburg Road, an early 20th-century road, within the community of Macksburg. The church is located approximately four miles southeast of the Canby city limits. The resource may be evaluated as an example of the Gothic Vernacular style and for its role in the Macksburg community.

SUBJECT PROPERTY

OWNERSHIP

According to county records, The Evangelical Lutheran Zion Congregation of Macksburg, the original owner, purchased the subject property from Gustave Heinke and his wife in 1910. In 1920 the Church Building Board of the Evangelical Lutheran Joint Synod of Ohio sold the property to the trustees of the Evangelical Lutheran Zion Church. In that same year the trustees of the Zion Congregation of Macksburg sold the property to the Christian Congregation Evangelical Lutheran Church, who retained ownership for five years until they sold to Ford J. Kraxberger. Otto Kraxberger, Jr. and others retained ownership until 1956.

HISTORICAL INFORMATION

The first Lutheran service in the Macksburg area was held in the home of Albert Klebe in the fall of 1890. Subsequent services were held in the Macksburg school house until the Macksburg Lutheran Church was built. Rev. C. Buechler of Portland came to the area once every three weeks to preach to the parish. The original trustees of the church were Chris Lorenz, Franz Kraxberger and Albert Klebe.

In the early 1890's services were held in homes or the Macksburg school, a survey indicated that 20 to 25 families in favor of building a church. The Rev. C. Buechler and officers of the congregation contacted the various families for contributions toward building the church and parsonage.

Johann and Rosina Kraxberger were one of the original families in the effort to build a church. The design of the church follows that of a similar church in the Kraxberger's native Austria. Construction of the Macksburg Lutheran Church was begun in late 1892 by volunteer Mennonite carpenters from the Needy area and dedicated November 11, 1894. The original church cost \$237, with much of the construction work donated. The church drew together the German Lutheran families who settled in the area in the 1880s. Church services were in German, and some of the services continued in German until the early 1940s. The original parsonage, no longer extant, was not built until 1896.

SITE PLAN

Address: 10190 Macksburg Road

Historic Name: MACKSBURG LUTHERAN CHURCH

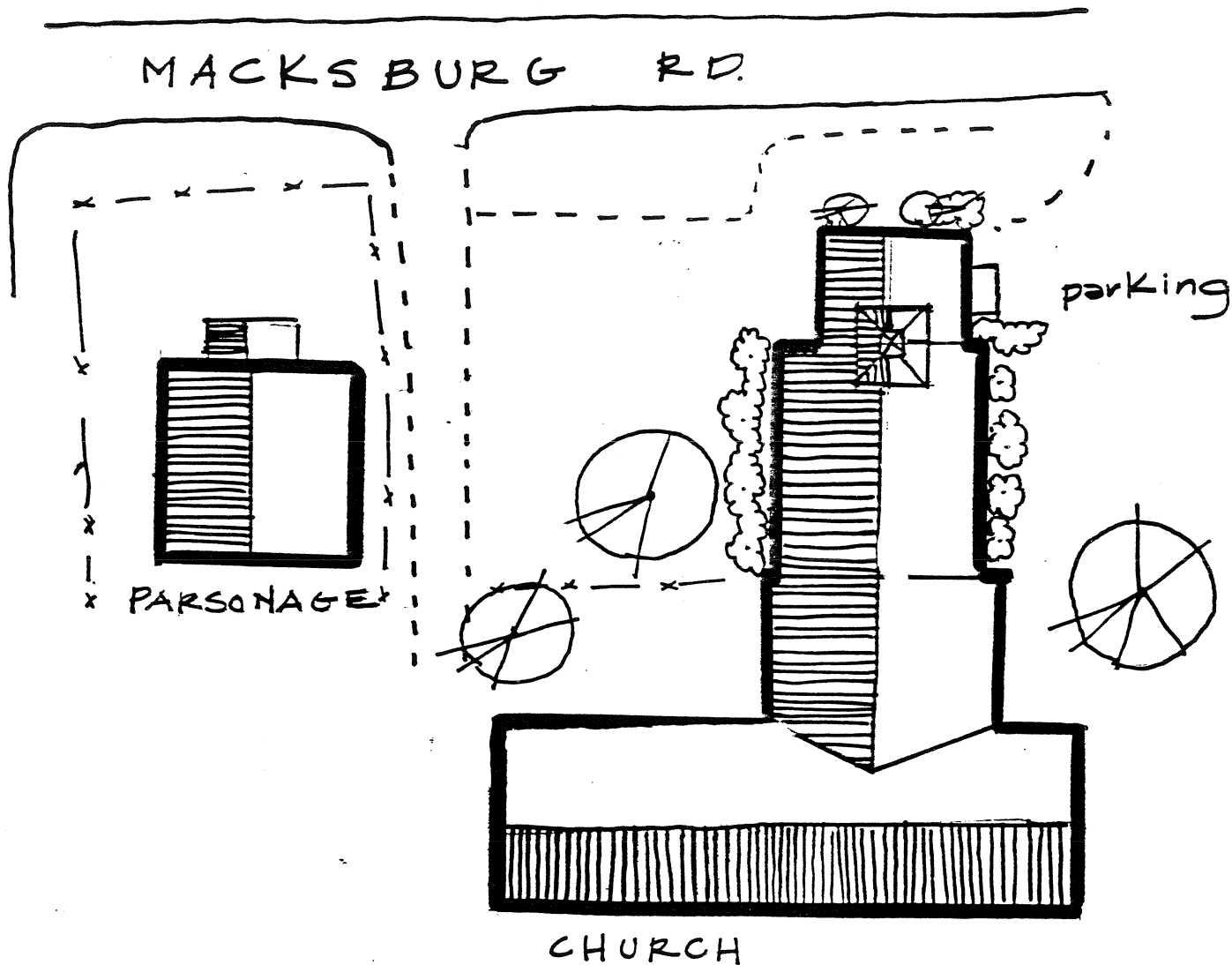

STATE OF OREGON INVENTORY
OF HISTORIC PROPERTIES
State Historic Preservation Office
Oregon State Parks, Salem, OR 97310



Macksburg Lutheran Church
1966

County Clackamas
Theme _____
Name
(Common) Macksburg Lutheran Church
(Historic) Same
Address 10210 S. Macksburg Road
Canby, Oregon 97013
Present Owner Macksburg Lutheran Church
Address 10210 S. Macksburg Road, Canby, Ore. 97013
Original Use Church Services
Date of Construction 1892 - 1894

Physical description of property and statement of historical significance:

Macksburg Lutheran Church has been in constant use as a place of worship since being completed in 1894. The building, still with its original rustic siding exterior finish, has been kept in good repair over the years and added onto but the original style (Carpenter's Gothic) and rectangular shape have not been changed.

The spired belfrey, which has housed the bell donated by a real estate man and on hand before the construction began in 1892, is a landmark in the area. The Church continues to hold to the tradition of tolling the bell when a church member dies, the number of tolls determined by the age of the deceased.

This Church magnifies the pride and desire of the original members, who were homesteaders in the Macksburg area from Germany and Austria, and of the Lutheran faith, to have a place of worship of their own in this country. Through the many years of hard work on the surrounding farms, the wars, and depressions, the original worshipers, their descendants, and new members

continue on back if necessary

Recorded by Mrs. F. O. Kraxberger Date April 6, 1981
Macksburg Garden Club

Sources consulted (continue on back if necessary):

Please enclose map. Township 4 N 1 E Section 23
S W

have continued the traditions, established new ones, and maintained the building with loving care to make it an attractive, meaningful historic attraction.

YODER QUADRANGLE
 OREGON
 7.5 MINUTE SERIES (TOPOGRAPHIC)
 NW 4 MOLLALA 15' QUADRANGLE

AMS 1474 II NW
 OREGON CITY

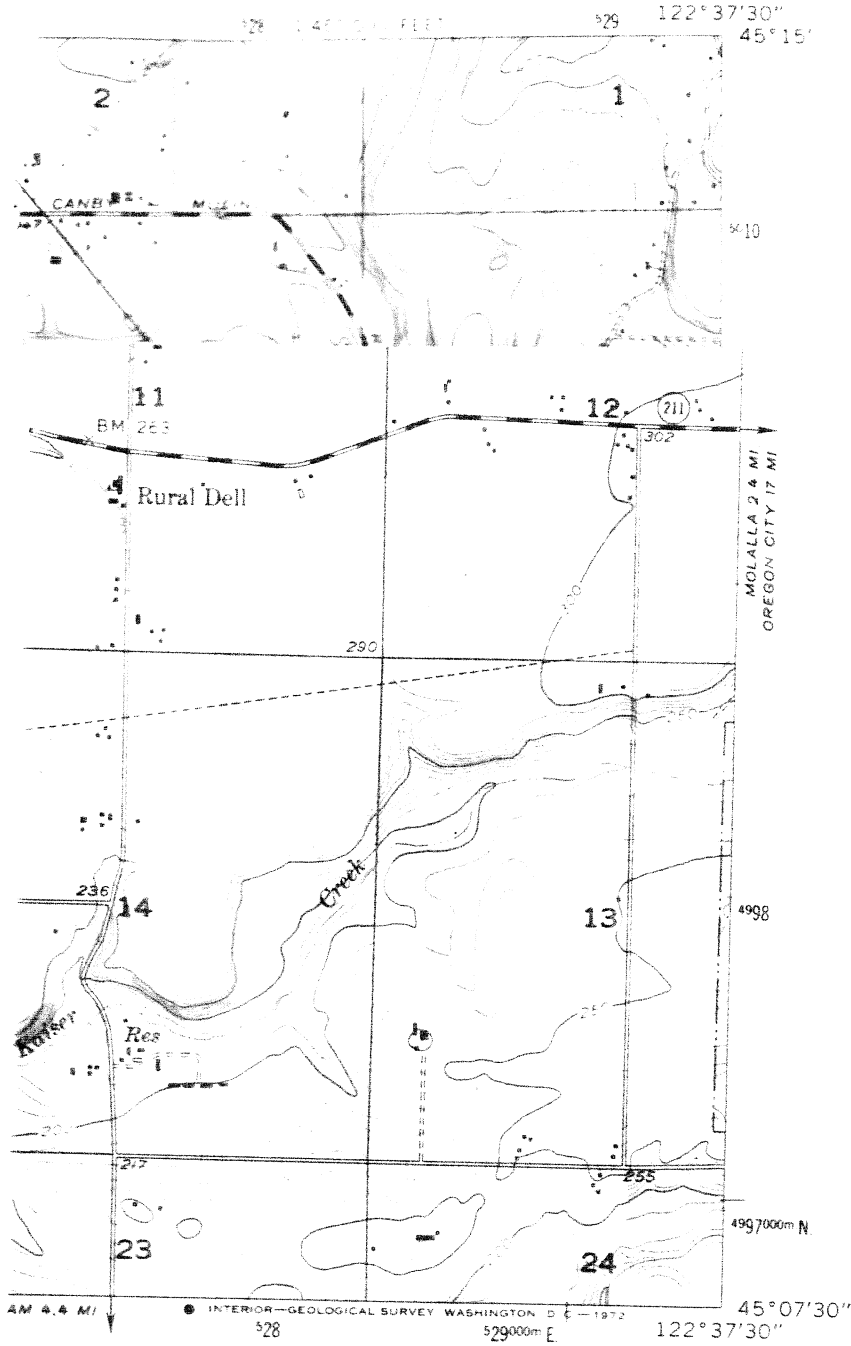

ROAD CLASSIFICATION

Heavy-duty Light-duty
 Medium-duty Unimproved dirt

U. S. Route State Route

MACKSBURG LUTHERAN CHURCH
 YODER, OREG.

NW 4 MOLLALA 15' QUADRANGLE
 N4507.5—W12237.5/7.5

1955
 PHOTOREVISED 1970
 AMS 1474 II NW—SERIES V892

10/527045/5006525

(WILHOIT)
 1474 II SE

