

Cultural Resource Survey Form:

CLACKAMAS COUNTY

I. D. NUMBER _____

PHOTO INFORMATION:

ROLL: LVII
FRAME: 20

STUDY AREA: Yoder/Marquam
LEGAL: T. 6S R. 1E SEC. 11
TAX (LOTS): 400
ZONE _____ SIZE 178
NATIONAL REGISTER: Yes

IDENTIFICATION:

COMMON/HISTORICAL NAME: ALBRIGHT FARM
ADDRESS: 38111 S. Nowlens Bridge Road AREA: Marquam
CURRENT OWNER: FRED KASER USE: Residence
OWNER'S ADDRESS: Same Molalla 97038
ORIGINAL OWNER: DANIEL ALBRIGHT USE: Residence
AREA OF SIGNIFICANCE: TOWN: _____ COUNTY: X CITY: _____ NATION: _____

HISTORIC INTEREST:

THEME: Architecture - 19th Century DATE: 1865
DESCRIPTION: _____

(Please see attached National Register Form)

ARCHITECTURAL INTEREST:

STYLE: _____ STORIES: _____
DATE: _____ CONDITION: _____ ARCHITECT: _____
SIDING: _____
ROOF: _____
DOORS: _____
WINDOWS: _____

MAIN ENTRANCE: _____

NOTES: _____



BIBLIOGRAPHY: _____

DATE: May 1984
RECORDER: Borge/Pinger
758

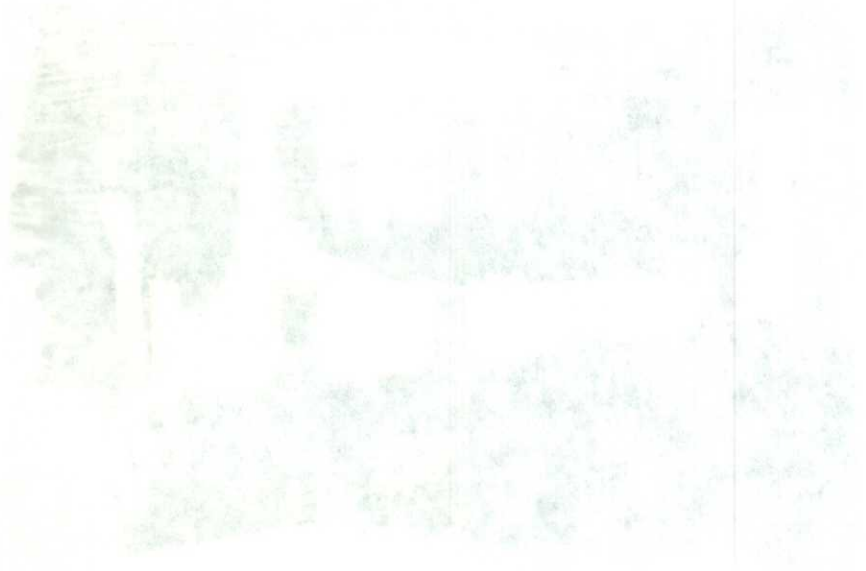

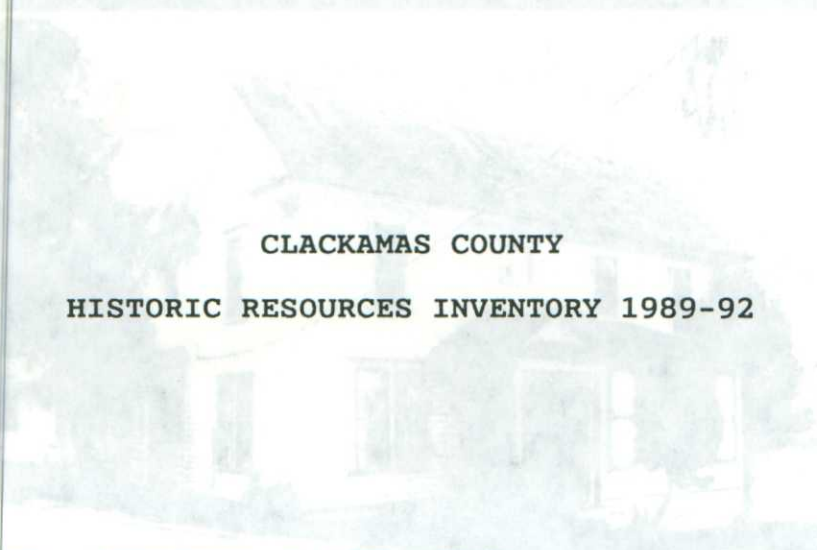

CLACKAMAS COUNTY
HISTORIC RESOURCES INVENTORY 1989-92

HISTORIC NAME: ALBRIGHT, DANIEL, FARM
COMMON NAME:
PROPERTY ADDRESS: 9912 S. Wildcat Road, Molalla OR 97038
OWNER: Regan Brothers
OWNER ADDRESS: 672 South N Street, Livermore, CA 94550
RESOURCE TYPE: Buildings
PRESENT USE: Farm Complex
ORIGINAL USE: Farm Complex
THEME: Culture: architecture; Agriculture
ARCHITECT/BUILDER: Hendershott, Cyrus, builder of barn
COUNTY: Clackamas
QUAD: Scotts Mill
T/R/S: 6 1E 11
TAX LOT: 400
ADDITION: N/A
BLOCK: N/A
LOT: N/A
LOT SIZE: 177.72 Acres
ZONE: EFU-20/CR

SETTING: The Daniel Albright Farm is located on an unimproved road off of Wildcat Road, a quiet, two-lane thoroughfare. The house is set back from the road. The site is rolling with the house and outbuildings nestled at the foot of a gently sloping hill. The area is predominantly in agricultural use.

NOTEWORTHY LANDSCAPE FEATURES: Mature deciduous trees; mature coniferous trees

NON-CONTRIBUTING FEATURES: None

RECORDED BY: Koler/Morrison
DATE: March 1992



HOUSE

DATE BUILT: 1865

DATE OF MAJOR REMODEL: 1904

STYLE: Greek Revival

PLAN/TYPE/SHAPE: Asymmetrical

NO. OF STORIES: 2

FOUNDATION MATERIAL: Concrete

BASEMENT: Yes

ROOF FORM AND MATERIALS: Intersecting gable w/ partial returns and pedimented arch over door w/ wood shingles

WALL CONSTRUCTION/STRUCTURAL FRAME: Wood/unknown

PRIMARY WINDOW TYPE: Double-hung sash w/ some architrave molding

EXTERIOR SURFACING MATERIALS: Wide drop siding; tongue-and-groove siding; cornerboards w/ caps, rake boards and watertable

DECORATIVE FEATURES: Turned posts; balustrade; ornate door; frieze

OTHER: Single-bay porch w/ gable roof, n. elev.; paneled-and-glazed door; gable roof ell and shed roof ell, s. elev.; shed roof ell, s.e. elev.; interior chimney; interior end-wall chimney

CONDITION: Good

EXTERIOR ALTERATIONS (DATE): Raised to two stories from 1 1/2 (1904); windows replaced w/ one-over-one double-hung sash (1904); bay window enlarged (1904); porch partially enclosed, n. elev. (1904); partially resided (n.d.); window cut and filled at gable, e. elev. (n.d.); porch enclosed in two phases (n.d.); ells added, s. and e. elev. (n.d.)



BARN

DATE BUILT: 1901

STYLE: Western

PLAN/TYPE/SHAPE: Rectangular

NO. OF STORIES: 2

FOUNDATION MATERIAL: Hewn frame on stone

BASEMENT: No

ROOF FORM AND MATERIALS: Gable w/ sheet metal

WALL CONSTRUCTION/STRUCTURAL FRAME: Wood/unknown

PRIMARY WINDOW TYPE: Six-light fixed

EXTERIOR SURFACING MATERIALS: Board-and-batten, s. and w. elev.

DECORATIVE FEATURES: None

OTHER: End-wall overhead sliding door; lean-to, n. and e. elev.;
hay hood

CONDITION: Good

EXTERIOR ALTERATIONS (DATE): Sheet metal roof added (1971); hay
door boarded (n.d.); overhead sliding door replaced w/ sheet
metal (n.d.)



GRANARY

DATE BUILT: 1870
STYLE: Vernacular
PLAN/TYPE/SHAPE: Rectangular
NO. OF STORIES: 2
FOUNDATION MATERIAL: Hewn frame on stone
BASEMENT: No
ROOF FORM AND MATERIALS: Gable w/ wood shingle
WALL CONSTRUCTION/STRUCTURAL FRAME: Wood/unknown
PRIMARY WINDOW TYPE: None
EXTERIOR SURFACING MATERIALS: Vertical boards
DECORATIVE FEATURES: None
OTHER: Hinged doors, some pairs; lean-to, w. and e. elev.
CONDITION: Fair
EXTERIOR ALTERATIONS (DATE): Lean-tos added, w. & e. elev.
(n.d.)



GARAGE

ESTIMATED DATE BUILT: c. 1900
STYLE: Vernacular
PLAN/TYPE/SHAPE: Rectangular
NO. OF STORIES: 1
FOUNDATION MATERIAL: Post-and-beam
BASEMENT: No
ROOF FORM AND MATERIALS: Gable w/ wood shingles
WALL CONSTRUCTION/STRUCTURAL FRAME: Wood/unknown
PRIMARY WINDOW TYPE: None
EXTERIOR SURFACING MATERIALS: Board-and-batten
DECORATIVE FEATURES: None
OTHER: Paned hinged doors; shed roof lean-to, w. elev.
CONDITION: Good
EXTERIOR ALTERATIONS (DATE): Lean-to added, w. elev. (n.d.)



SMOKEHOUSE

ESTIMATED DATE BUILT: c. 1900
STYLE: Vernacular
PLAN/TYPE/SHAPE: Rectangular
NO. OF STORIES: 1
FOUNDATION MATERIAL: Concrete
BASEMENT: No
ROOF FORM AND MATERIALS: Gable w/ wood shingles
WALL CONSTRUCTION/STRUCTURAL FRAME: Wood/unknown
PRIMARY WINDOW TYPE: None
EXTERIOR SURFACING MATERIALS: Board-and-batten
DECORATIVE FEATURES: None
OTHER: Four paneled door
CONDITION: Good
EXTERIOR ALTERATIONS (DATE): Unknown



WELL HOUSE

ESTIMATED DATE BUILT: c. 1870
STYLE: Vernacular
PLAN/TYPE/SHAPE: Square
NO. OF STORIES: 1
FOUNDATION MATERIAL: Concrete block
BASEMENT: No
ROOF FORM AND MATERIALS: Hip w/ wood shingles
WALL CONSTRUCTION/STRUCTURAL FRAME: Masonry/posts
PRIMARY WINDOW TYPE: None
EXTERIOR SURFACING MATERIALS: Concrete block
DECORATIVE FEATURES: None
OTHER: None
CONDITION: Good
EXTERIOR ALTERATIONS (DATE): Concrete block added (n.d.)



CHICKEN COOP

ESTIMATED DATE BUILT: c. 1900
STYLE: Vernacular
PLAN/TYPE/SHAPE: Rectangular
NO. OF STORIES: 1
FOUNDATION MATERIAL: Post-and-beam
BASEMENT: No
ROOF FORM AND MATERIALS: Gable w/ wood shingles
WALL CONSTRUCTION/STRUCTURAL FRAME: Wood/unknown
PRIMARY WINDOW TYPE: Unglazed
EXTERIOR SURFACING MATERIALS: Board-and-batten
DECORATIVE FEATURES: None
OTHER: Hinged
CONDITION: Fair
EXTERIOR ALTERATIONS (DATE): Unknown

STATEMENT OF SIGNIFICANCE

Address: 9912 S. Wildcat Road
Historic Name: ALBRIGHT, DANIEL, FARM

The Daniel Albright Farm is located approximately one mile east of Marquam within the Sylvester Nicholson donation land claim. The resource may be evaluated as an example of a 19th century farm complex.

HISTORIC BACKGROUND

SUBJECT PROPERTY

OWNERSHIP

According to county records Daniel Albright purchased the subject property in 1862 from George W. and Sarah Hungate. In 1893 George W. and Sarah Hungate gave a quit claim deed to Alva W. and Edward B. Albright. In that same year Francis E. and Annette Albright are listed giving a quit claim deed to Alva and Edward as well. In 1899 A.W. Albright and his wife are listed selling the property to E.B. and N.P. Albright. The subject property remained in the Albright family through to the 1970s.

HISTORICAL INFORMATION

The following is an excerpt from the "National Register of Historic Places Inventory Nomination Form":

Albright heritage in Oregon goes back to John Albright's arrival from Ohio in 1845 with his wife Sarah and his son Daniel. He settled a claim near Teague Creek (Molalla, Oregon) and established one of the early brick foundries in the Willamette Valley. This trade wasn't new to John, as the brick masons trade had been in the Albright family for several generations. In 1857, Daniel purchased a half of the Nicholson donation land claim and a small parcel of railroad land south of this [donation land claim] which constitute the present farm totaling 600 acres. In 1861, Daniel took as his wife Mary Jane Marquam. She was a niece of Judge Marquam, for whom Marquam Hills and Bridge in Portland are named. In 1892, Daniel died and his second son, Wallace, inherited the farmstead. Wallace was responsible for the construction of the 1901 barn and the 1904 house remodel as his family grew. The farmstead remained in the Albright family up to the death of Kreta Albright, Wallace's daughter, in 1973.

According to the owner in 1984 Daniel Albright (1832-1892), was the original owner of the subject property. Daniel Albright, a native of New Libson, Columbiana County, Ohio, was the son of John Albright and Sarah Baker Albright. The family moved from Ohio to Iowa when Daniel was 14-years-old. In 1852, when Daniel

was 21 years old, the family crossed the plains to Oregon. In 1845 Daniel purchased a quarter section of land in the Marquam area, adding to it over time. The subject property was part of this farm. Albright engaged in general farming and stock raising. Daniel Albright was a member of the Republican party, the Grange and the Methodist Episcopal Church.

Daniel Albright's wife, Mary J. Marquam, was the daughter of Olive Burbage Marquam and Alfred Marquam, the community's namesake. Mary and Daniel had five children, three of whom lived into adulthood: Francis Elmer, Alva Wallace and Edward B.. George W. and Asa died as children.

ARCHITECTURAL/PHYSICAL INFORMATION

The following is an excerpt from the "National Register of Historic Places Inventory Nomination Form":

The Daniel Albright farm group, located east of Marquam, Oregon in Clackamas County, stand today on its original 600-acre section of farmland. The remaining building consist of a Greek Revival farmhouse (1865), a hewnframe granary (1870), a hewnframe barn (1901), a chicken coop, and a smokehouse. The only known builder is Cyrus Hendershott, a cousin of the Albright family, who built the 1901....

The earliest remaining building, the Greek Revival house, was built in 1865. It was built as a 1 1/2-story house, which remodeling in 1904 raised to a full two stories. The house faces west and the entrance is flanked by two large oak trees. Several small cedars are situated in close proximity to the house on the south and west sides. The Greek Revival style was brought west with the pioneers and was used extensively in the early farm houses of the Willamette Valley. The house is of box construction of butt-jointed vertical plank walls which were cheese-clothed and papered over on the interiors, with horizontal clapboard siding used on the exterior....

In 1904, the house underwent several changes which provided more room for the expanding family and incorporated the new plumbing and electrical services available at that time...The significant changes made in 1904 were as follows: the roof was raised about four feet to create a full second story, and a new single-pane, double-hung sash windows were added. To be consistent, these new windows were installed throughout the house. The bay window in the west living room wall was doubled in length, and as a result, the double door entrance porch was narrowed to one door. The earth was excavated under the north end of the house to make way for a concrete basement and furnace. ...

The primary significance of the Daniel Albright farmstead is that it is one of the few remaining farm groups with several

existing hewn frame buildings from the late 1800s. The Albright farm group, consisting of four log, three hewn and four rough sawn buildings, was constructed by the Albright family between 1857 and 1901. Of the original farm group, only the log buildings have vanished with time.

Two of the farm buildings are unusually fine examples of their kind. Both appear to be superior to anything like them in western Oregon. The 1901 barn is a very late example of mortis/tenoned, hewn frame construction. Two or three other 20th-century hewn frame barns have been encountered, but the quality of construction was poor and spatial systems of little interest. Heavy sawn frames would have superseded hewn frames as the means of barn frame construction on most Oregon farms by the 1880s. The Albright granary also is in contrast to the unusual [sic] granary building, which was standardized from farm to farm: plain structures with a one-level scheme of a central drive flanked by bins. Among Oregon granaries the Albright granary is unique. Both the barn and the granary are far above ordinary... execution of the frame, in finish detail and in the ingenuity of their spatial arrangement.

The 1871 and the 1901 barn are good examples of how early farmers put strong emphasis on the particular siting needs of their various buildings. The 1871 granary uses a structural system base on the amount of volume needed to store given amounts of grain (four and eight hundred bushels). It also took advantage of the gently sloping hill. The north end floor of the granary was lowered so grain could be removed from the "upper granary" by means of a gravity feed system. The 1901 hewn frame barn, built by Cyrus Hendershott, is a fine example of the type of barn which came into use near the end of the 1880s. The type utilized a hay forklift located under the roof peak hood to lift hay to the second floor storage area, also a new addition to the function of barns. Both of these buildings have survived the ravages of time and remain today in fine condition.

The four remaining outbuildings are good examples of the kinds of structures and construction techniques in use during the early 1900s. These four buildings are also in fine condition, and, as with all buildings on the farm, remain in use today.

The four buildings which haven't survived the passage of time include the 1857 log cabin, the 1857 log barn which stood until 1976, and the 1859 small log feeding barn, and the 1860 three level hillside barn. Although the earliest buildings have not survived, the remaining group is a fine example of early Oregon pioneer Vernacular architecture....

The other remaining buildings include a typical smokehouse (9x9') of vertical plank construction and a concrete floor,

the well--which is part of the original farmstead, its use discontinued in 1904 with the addition of running water, and the two remaining buildings--the chicken coup and garage--which exemplify turn-of-the-century farm architecture.

SIGNIFICANCE

The Daniel Albright Farm Group is listed on the National Register of Historic Places and is significant as an excellent example of a 19th century farm complex. The house is significant as an excellent and singular example of the Greek Revival style listed on the Clackamas County Cultural Resource Inventory for the study South County/Yoder/Marquam study area.

Bibliography: Chapman Publishing Company, Portrait and Biographical Record of Portland and the Vicinity, 1903, Chicago, p. 353-354.
Clackamas County Cultural Resource Inventory, 1984.
Clackamas County Tax Assessor records, Oregon City, OR.
Daniel Albright Farm Group, "National Register of Historic Places Inventory Nomination Form", 1974.
TICOR Title Company, Oregon City, OR.

SITE PLAN

Address: 9912 S. Wildcat Road
Historic Name: ALBRIGHT, DANIEL, FARM

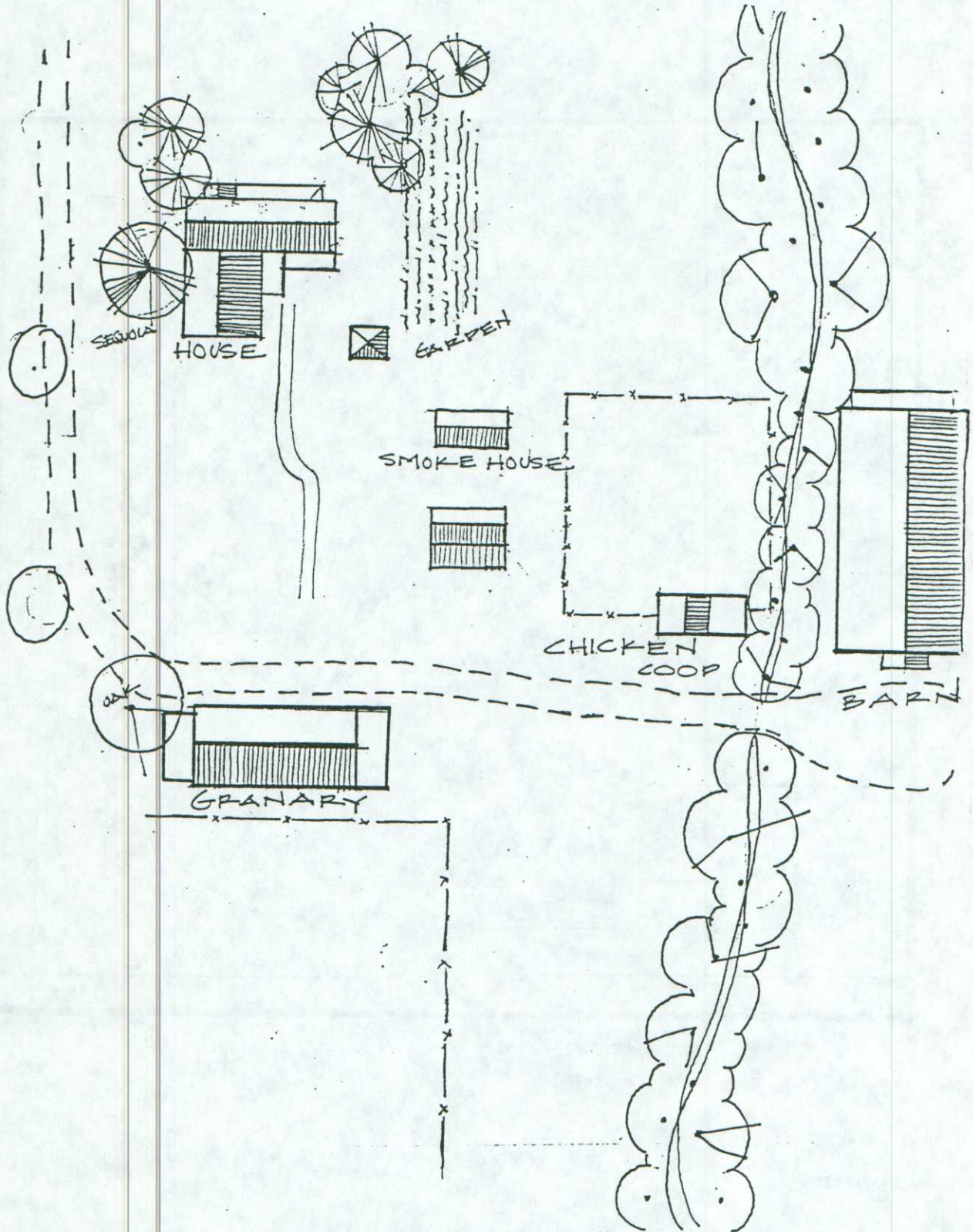

VICINITY MAP

Address: 9912 S. Wildcat Road
Historic Name: ALBRIGHT, DANIEL, FARM

