

BENTON COUNTY CULTURAL RESOURCES SURVEY II
1984 - 1985

COUNTY AREA: Corvallis 1

RESOURCE #: 136

PHOTO #: I 28

PROP. CLASS: 502

ORIGINAL USE: Residence

SIZE: 17.21 acres

PRESENT USE: Residence

PROPERTY ADDRESS: 2900 NE Pinkington, Corvallis, Oregon 97330

T 11S R 4W S 19 1/4 SE

TAX LOT: 801

COMMON NAME: The Kraft House

HISTORIC NAME: The Woodcock House

PRESENT OWNER: Walter and Rose Allen Kraft

OWNER'S ADDRESS: 2900 NE Pilkington, Corvallis, Oregon 97330

ORIGINAL OWNER: Milton Sherman Woodcock

ARCHITECT:

BUILDER:

THEME: Culture; 19th Century Architecture

PERIOD/ DATE: Railroad Era/ c. 1880

ARCHITECTURAL DESIGNATION/ TYPE: Italianate House

* * * * *

ARCHITECTURAL DESCRIPTION

Plan type/shape: Square

No. of Stories: Two

Foundation material: Brick

Basement (y/n): Yes

Roof form & materials: Flat with overhanging eaves and flat soffit.

Wall construction: Wood

Structural frame: Wood

Primary window type: One over one double hung sash windows with heavy cornice-style moldings

Primary exterior surfacing materials: Horizontal shiplap siding with cornerboards and wide frieze

Outstanding decorative features: Frieze is embellished with panels. Eaves are bracketed by pendant brackets. Architrave is embellished by a repeating semicircular pattern. Projecting slant bays on main facade have molded, recessed panels above and below windows. Architrave detail and pendant brackets also on bay. Rectangular bay on east and west elevations. Marble sinks in the corner of each bedroom on the interior. Colored lights used in the top sash of several windows.

Exterior alterations/additions (dated): Second story railing is not original. A door was once centrally located on the second story main facade. Today there is a window in that location. Entry porch was originally recessed between the two bays on the main facade. This area was filled in and a new entry door with transom and sidelights was

installed sometime in the early 20th Century. Current porch is not original but detailing matches original detail of house. Some porch elements were fabricated recently.

Condition: Excellent (Excellent, Good, Fair, Deteriorated, Moved-Date)

GEOGRAPHICAL LOCATION AND IMMEDIATE SETTING

The Woodcock House was originally located at 140 N. 5th Street in Corvallis. Moved in 1975 to make room for the Law Enforcement Building, the house today is located on the south side of Pilkington Ave. approximately two-tenths of a mile east of the Highway 20 intersection. The house is set back from the road and is accessed by a long, gravel drive. Situated on a terrace of the Willamette River, the house fronts northwest. Behind the house is Stewart Slough, a former channel of the Willamette River.

NOTEWORTHY LANDSCAPE FEATURES

None noted.

HISTORICAL BACKGROUND AND SIGNIFICANCE

Although moved from its original site, the M.S. Woodcock House is architecturally significant as one of Benton County's best examples of the Italianate style of architecture. Perhaps more important is the house's association with M.S. Woodcock, a very prominent resident of Benton County.

The M.S. Woodcock House was built in c. 1880 for M.S. Woodcock. That same year, M.S. Woodcock married Emma Simpson. Mr. Woodcock began his law practice in Corvallis in the mid 1870's. In 1887, he established the Benton County Bank in Corvallis. Three years later he organized the First National Bank of Corvallis serving as president of this institution until his death in 1925. M.S. Woodcock was also owner and editor-in-chief of the Corvallis Gazette from 1881 to 1908. From 1901 to 1903, he served as the Mayor of Corvallis.

After his death in 1925, Mrs. Woodcock continued to live in the house until 1936 when she took up occupancy at the Corvallis Hotel. At this time, her son, M.E. Woodcock, and his wife moved into the house. The Woodcock Family occupied the house until the 1970's.

In 1975 the house was purchased by Rose Kraft. The house was sold in an oral bid with the stipulation that the house be moved because the Law Enforcement building was to be built on this site. Rose and Walter Kraft had the house moved to their land on Pilkington Ave. north of Corvallis. The Kraft Family continues to occupy the house today.

SOURCES CONSULTED

Anon, Portrait and Biographical Record of the Willamette Valley, Oregon, Chapman Publishing Co., Chicago, Illinois, 1903.

Gazette-Times, Corvallis, Oregon, March 3, 1925.

Fagan, David D., History of Benton County, Oregon, David D. Fagan and A.G. Walling, Portland, Oregon, 1885.

"Stately Woodcock Home is Corvallis Landmark," Gazette-Times, Corvallis,
Oregon, Feb. 27, 1968.

"Woodcock House Leaves Town," Gazette-Times, Corvallis, Oregon, August
14, 1975.

Recorded by: Mary Kathryn Weber
Kathy Schutt

Date: March 31, 1985

BENTON COUNTY HISTORICAL MUSEUM

* * * * *



Photo No. 128

View to southwest

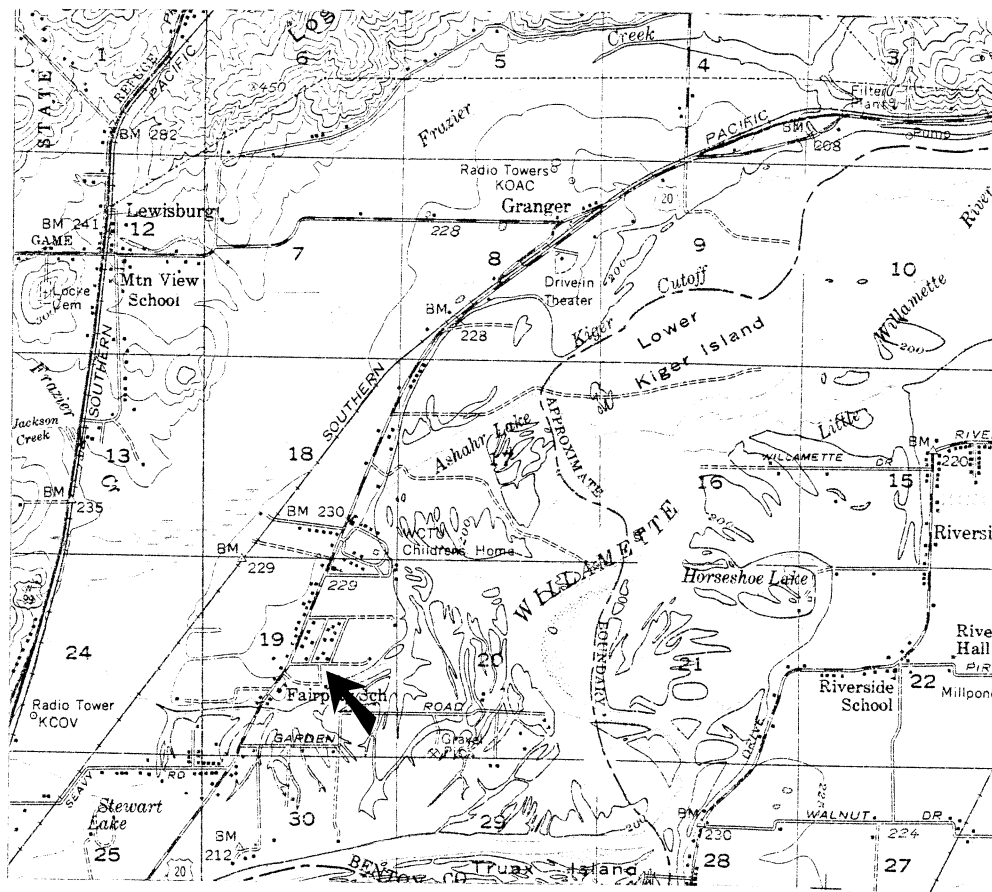

ALBANY QUADRANGLE

T 11 R 4 S 19

#136

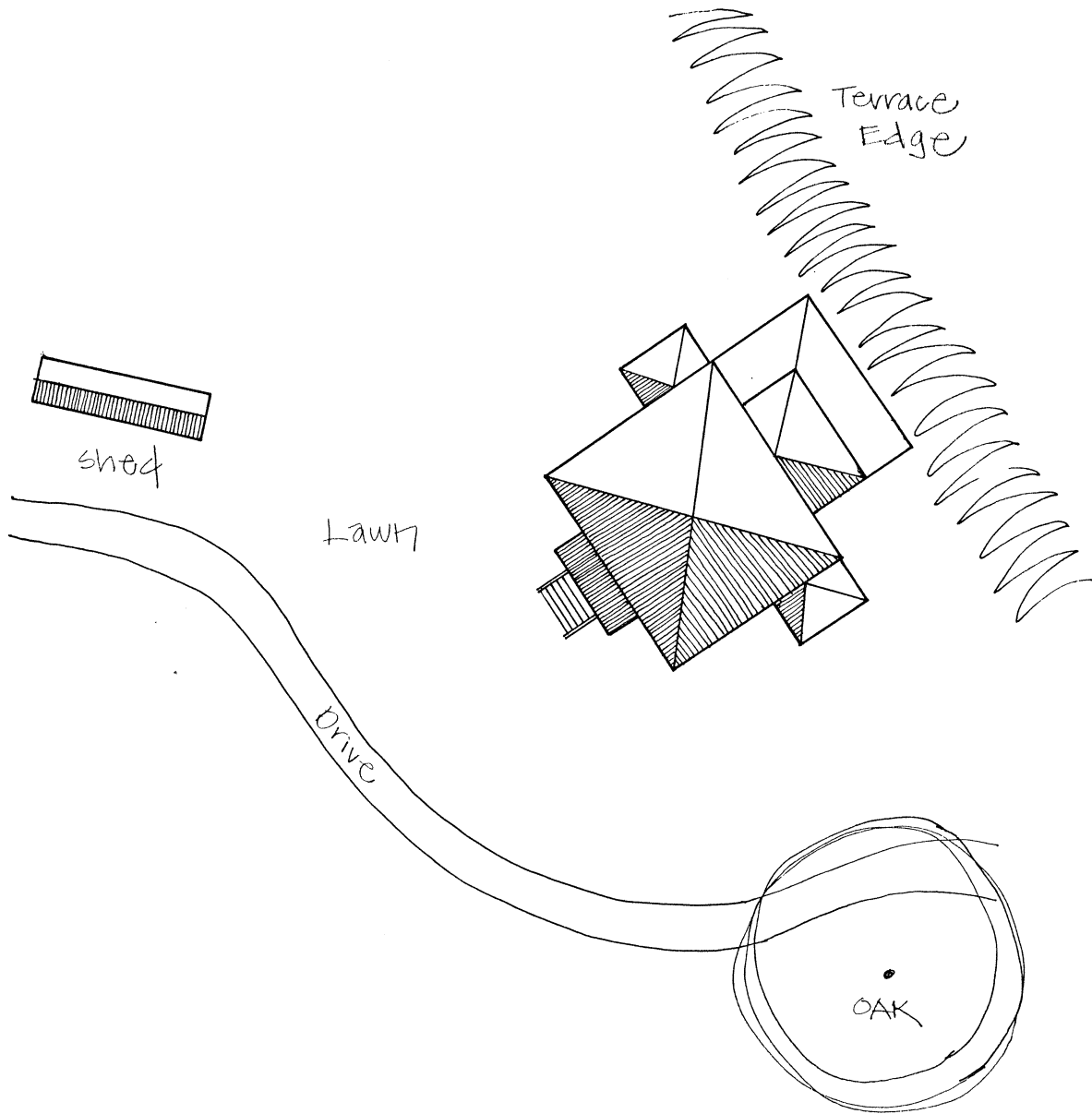

↑
N NO SCALE

BENTON COUNTY CULTURAL AND HISTORIC RESOURCE SURVEY 1983



INVENTORY NUMBER 136

AREA: Fairplay

T 11S R 4W SECTION 19

TAX LOT # 00900

Address: 2900 Pilkington Lane

Owner: Ed and Rose Kraft

753-9876

Historic Name: Woodcock

Theme: Architecture/History

Construction Date: 1880

Type/Use: Residence

Style: Italianate

Recorded by: R. Clark

Date: May 5, 1983

Rating: 1

Condition/ 10

Excel (10), Fair (5), deteriorated (1)

 Roll I # 28 west side
 Story 2 Frame wood
 Roof very low hip Eaves overhang, enclosed Frieze wide, paneled with brackets
 Basic shape square Additions 1 story in back (east)
 Interior Chimney 2 brick corbeled Exterior Chimney _____
 Dormers _____ Bays octagonal bay in front (west), rectangular bay on side (north)
 Siding shiplap Cornerboards medium
 Typical Windows 1 over 1 double hung with classic moldings
 Porch Roof flat, top railing Posts grouped in 3's Placement 1/2 of front facade
 Foundation brick, different colors Other Structures _____
 Notable Elements brackets, panels and molding under eaves, front door with transom and sidelights, porch railing with criss cross pattern.
 Alterations _____
 Comments/Historic Significance moved to this site from present location of the Justice Center Building of Benton County. Moved 1979.

more info. in 1986 inventory