

United States Department of the Interior  
National Park Service

National Register of Historic Places  
Inventory—Nomination Form

For NPS use only

received

JAN 7 1987

date entered

FEB 10 1987

See instructions in *How to Complete National Register Forms*  
Type all entries—complete applicable sections

1. Name

historic Pleasant Grove Presbyterian Church (preferred) No. of contributing features: 1  
and/or common Condit Church No. of non-contributing features: 0

2. Location

street & number 1313 Mill Street SE N/A not for publication  
city, town Salem N/A vicinity of Fifth Congressional District  
state Oregon code 41 county Marion code 047

3. Classification

<b>Category</b>	<b>Ownership</b>	<b>Status</b>	<b>Present Use</b>
<input type="checkbox"/> district	<input type="checkbox"/> public	<input checked="" type="checkbox"/> occupied	<input checked="" type="checkbox"/> museum
<input checked="" type="checkbox"/> building(s)	<input checked="" type="checkbox"/> private	<input type="checkbox"/> unoccupied	<input type="checkbox"/> park
<input type="checkbox"/> structure	<input type="checkbox"/> both	<input type="checkbox"/> work in progress	<input type="checkbox"/> private residence
<input type="checkbox"/> site	<b>Public Acquisition</b>	<b>Accessible</b>	<input type="checkbox"/> religious
<input type="checkbox"/> object	N/A in process	<input type="checkbox"/> yes: restricted	<input type="checkbox"/> scientific
	N/A being considered	<input checked="" type="checkbox"/> yes: unrestricted	<input type="checkbox"/> transportation
		<input type="checkbox"/> no	<input type="checkbox"/> other:

4. Owner of Property

name Mission Mill Museum Association  
street & number 1313 Mill Street SE  
city, town Salem N/A vicinity of state Oregon 97301

5. Location of Legal Description

courthouse, registry of deeds, etc. Marion County Courthouse  
street & number 100 High Street NE  
city, town Salem state Oregon 97301

6. Representation in Existing Surveys

title National Register of Historic Places has this property been determined eligible?  yes  no  
date August 7, 1974  federal  state  county  local  
depository for survey records National Park Service, 1100 L Street NW  
city, town Washington state D.C. 20013

## 7. Description

<b>Condition</b>		<b>Check one</b>	<b>Check one</b>	
<input type="checkbox"/> excellent	<input type="checkbox"/> deteriorated	<input type="checkbox"/> unaltered	<input type="checkbox"/> original site	
<input checked="" type="checkbox"/> good	<input type="checkbox"/> ruins	<input checked="" type="checkbox"/> altered	<input checked="" type="checkbox"/> moved	date <u>September 23, 1984</u>
<input type="checkbox"/> fair	<input type="checkbox"/> unexposed			

### Describe the present and original (if known) physical appearance

Pleasant Grove Presbyterian Church originally stood in the Santiam drainage, approximately one mile northwest of West Stayton. A small, single-story meeting house completed in 1858, it was situated on a prairie bordered by the Waldo Hills on the north and by the Salem Hills on the west. Oriented to the east, it stood on the north side of an east-west, gravel-surfaced market road and was shaded on its south elevation by a towering native oak. To the rear, or west, lay the church burying ground and a grove of firs. The church, along with its associated cemetery, together comprising a parcel of 2.6 acres, was listed in the National Register of Historic Places on August 7, 1974.

The church fell into disuse in the 1960s and as time went on suffered increasingly the effects of vandalism and deferred maintenance. Ten years after the church was listed in the National Register, the State Historic Preservation office arranged a meeting of interested parties, including church neighbors, heirs of members of the original congregation, Trustees of the Presbytery of the Cascades, representatives of the Marion County Historical Society, and others. It was determined that all reasonable means of safely maintaining the church at its original location had been explored and exhausted. Accordingly, on September 23, 1984, the church was moved 20 miles to Salem, where it was permanently sited and restored on the grounds of "Mission Mill Village," formerly known as Thomas Kay Historical Park, a 4.5-acre holding owned and maintained by the Mission Mill Museum Association. The church restoration was completed and dedicated on October 7, 1985.

As there are no compass-oriented thoroughways in the museum grounds, and owing to a varied topography, conditions of the original setting could not be reproduced in detail in the permanent resiting. However, a decided rural spirit has been captured in the relocation. The building is now situated on a rise of land which makes it visually discrete within the museum complex. It faces to the southwest and is backed up to the mill race of the Thomas Kay Woolen Mill. As was the case in the original setting, the church is dominated by a sheltering oak. At the new site, the oak stands at the bottom of the slope, near the building's southeast corner. The knoll on which the church is presently situated was, in part, artificially created at the time the diversion channel was excavated for the mill race. No archeological values were disturbed in the resiting process.

Despite removal and reconstruction of its gable roof, Pleasant Grove Presbyterian Church survived the relocation to Salem without loss of its essential architectural integrity. The simple vernacular building is of frame construction. According to tradition, its lumber was hauled from a mill at Oregon City and planed at the building site. Framing members and rafters were rough-hewn from native firs. It has been observed that the floor joists were joined by oak pegs.

The one-story, one-room building measures 30 feet square and presently rests on a concrete foundation, which closely approximates the height above grade of the original pier foundation. The waterskirt of vertical tongue and groove millwork matches historic material. The building has a shingle-clad gable roof of medium pitch and boxed eaves with cornice returns. The frieze boards and corner boards

**United States Department of the Interior  
National Park Service**

**National Register of Historic Places  
Inventory—Nomination Form**



Continuation sheet PLEASANT GROVE  
PRESBYTERIAN CHURCH Item number 7 Page 2

are plain, unadorned. Exterior elevations are clad with lapped weatherboards showing 6 inches to the weather. Window and door frames are without architraves. Window openings are formally placed, three in either side elevation, and are fitted with double-hung sash with twelve lights over twelve.

Originally, the rear gable end was blind. As the building now is used as a wedding chapel and for assemblies of various kinds, a doorway was cut near the west corner of this face to satisfy fire and life safety codes. On the rear elevation also is exterior ducting for the heating-ventilating system, which is otherwise fully concealed in the attic and crawl space.

The principal facade is distinguished by its two formally placed doors and a 7 x 24-foot porch having a hipped roof supported by four slender chamfered posts. Whereas, originally, three steps at either end gave access to the porch, the sloping grade and circulation requirements of a wedding chapel dictated two flights of steps aligned with either entrance. A railing consisting of square balusters between top and bottom rails also was added in consideration of the building code. The doors are two-panel doors with a single central stile, and they bear the distinctive signs of their hand workmanship.

The interior is simply finished with wide floor boards, ceiling, and plain, horizontal wall boards laid flush. The original, hand-hewn box pews and centrally-placed, broad pulpit with its paneled front are intact. Before its abandonment in the 1960s, the church had been wired for overhead electrical lighting. The church's wood stove, which was vented by stovepipe and a brick chimney which straddled the roof ridge at the center, was taken from the building after its abandonment, as was an organ acquired by the church ladies in 1915. However, the cabinet bookcase fashioned by Cyrenus Condit, son of the church founder, is an historical case piece which has remained in the church since construction was completed in 1858. It stands to one side of the pulpit and originally contained the congregation's bible, and hymnals and communion pieces.

## 8. Significance

Period	Areas of Significance—Check and justify below			
<input type="checkbox"/> prehistoric	<input type="checkbox"/> archeology-prehistoric	<input type="checkbox"/> community planning	<input type="checkbox"/> landscape architecture	<input checked="" type="checkbox"/> religion
<input type="checkbox"/> 1400-1499	<input type="checkbox"/> archeology-historic	<input type="checkbox"/> conservation	<input type="checkbox"/> law	<input type="checkbox"/> science
<input type="checkbox"/> 1500-1599	<input type="checkbox"/> agriculture	<input type="checkbox"/> economics	<input type="checkbox"/> literature	<input type="checkbox"/> sculpture
<input type="checkbox"/> 1600-1699	<input checked="" type="checkbox"/> architecture	<input type="checkbox"/> education	<input type="checkbox"/> military	<input type="checkbox"/> social/ humanitarian
<input type="checkbox"/> 1700-1799	<input type="checkbox"/> art	<input type="checkbox"/> engineering	<input type="checkbox"/> music	<input type="checkbox"/> theater
<input checked="" type="checkbox"/> 1800-1899	<input type="checkbox"/> commerce	<input type="checkbox"/> exploration/settlement	<input type="checkbox"/> philosophy	<input type="checkbox"/> transportation
<input type="checkbox"/> 1900-	<input type="checkbox"/> communications	<input type="checkbox"/> industry	<input type="checkbox"/> politics/government	<input type="checkbox"/> other (specify)
		<input type="checkbox"/> invention		

**Specific dates** 1857-1858 **Builder/Architect** Unknown

### Statement of Significance (in one paragraph)

Pleasant Grove Presbyterian Church meets National Register criterion "c" as one of an important group of small churches in the meeting house tradition built in the Willamette Valley in the 1850s. Whereas the type was more numerous in the early settlement period, in pre-Territorial days, there are no more than four standing today. Each, including the Pleasant Grove Church, has been entered into the National Register. This nomination document seeks to establish that because of its rarity and essential architectural integrity, the building should remain in Register listings notwithstanding its relocation from the Aumsville/West Stayton area to Salem in 1984. The other remaining buildings of comparable character are West Union Baptist Church (1853), Rock Creek Methodist Church (1854), and Mt. Pleasant Presbyterian Church (c. 1854). Though similar in style and feeling to each of these but West Union Baptist Church, Miller Cemetery Church in the vicinity of Silverton, in Marion County, was not constructed until 1882. Pleasant Grove Presbyterian is not only among the oldest churches in the state, it is generally believed to be the oldest standing Presbyterian church of documented date in the Pacific Northwest.

The Presbyterian Church was among the first Protestant denominations active in the Oregon Country. Marcus Whitman, a missionary doctor sent to the Indians of the Pacific Northwest by the American Board of Commissioners for Foreign Missions, was an ordained minister and organized the first Presbyterian church in the region at Wailatpu on the Walla Walla River in 1838. The first Presbyterian church in what ultimately became the state of Oregon was organized on the coast, at Clatsop Plains, at the home of Dr. William H. Gray, a former member of the Whitman Mission, in 1846.

While the Presbytery of Oregon was formed as early as 1851, there were not more than half a dozen formally organized Presbyterian churches--those at Clatsop Plains, Lafayette, Corvallis, Portland, Brownsville and Eugene, when the Reverend Philip Condit established his church in the Santiam drainage east of Salem in 1856.

The Reverend Philip Condit, with his sons Sylvanus and Cyrenus, arrived in Marion County in 1854. While plans for the forming of a congregation may have begun in 1855, the dates of September 27 or September 28, 1856 are given for the official founding of the Pleasant Grove Church. Reverend Condit died shortly thereafter of Rocky Mountain fever. The date of death given on his headstone in the church burying ground is November 21, 1856. Condit's son, Sylvanus, was appointed ruling elder, and it was he who, with his brother, carried out his father's plans for the church building in 1857 and 1858.

# 9. Major Bibliographical References

Please see continuation sheet

# 10. Geographical Data

Acreeage of nominated property 0.14

Quadrangle name Salem, Oregon

Quadrangle scale 1:62500

### UTM References

A 

1	0	4	9	8	0	7	10	4	9	7	6	5	10	10
Zone			Easting					Northing						

B 

Zone			Easting					Northing						

C 

Zone			Easting					Northing						

D 

Zone			Easting					Northing						

E 

Zone			Easting					Northing						

F 

Zone			Easting					Northing						

G 

Zone			Easting					Northing						

H 

Zone			Easting					Northing						

**Verbal boundary description and justification** As permanently resited, Pleasant Grove Presbyterian Church occupies the south half of Lot 6, Block 35, University Addition to Salem, in Marion County, Oregon. The nominated area is 79.55 x 78.35 feet, or 0.14 acres in extent. Its setting is a visually discrete rise on the grounds of the Mission Mill Museum.

### List all states and counties for properties overlapping state or county boundaries

state N/A code county code

state N/A code county code

# 11. Form Prepared By

name/title Bruce Wulf, Director (with assistance of State Historic Preservation Office)

organization Mission Mill Museum Association date October, 1986

street & number 1313 Mill Street SE telephone (503) 585-7012

city or town Salem state Oregon 97301

# 12. State Historic Preservation Officer Certification

The evaluated significance of this property within the state is:

national  state  local

As the designated State Historic Preservation Officer for the National Historic Preservation Act of 1966 (Public Law 89-665), I hereby nominate this property for inclusion in the National Register and certify that it has been evaluated according to the criteria and procedures set forth by the National Park Service.

State Historic Preservation Officer signature 

title Deputy State Historic Preservation Officer date December 15, 1986

### For NPS use only

I hereby certify that this property is included in the National Register

William B. Bushong date 2/10/87  
Keeper of the National Register

Attest: \_\_\_\_\_ date \_\_\_\_\_

Chief of Registration

**United States Department of the Interior  
National Park Service**

**National Register of Historic Places  
Inventory—Nomination Form**



Continuation sheet PLEASANT GROVE PRESBYTERIAN CHURCH Item number 8 Page 2

A 40-acre site was chosen for the church on the claim of Cyrenus Condit which lay between the present towns of Aumsville and West Stayton. In early days, Aumsville was called Hoggum for the many pigs raised in the area. The latter place name was used until July 10, 1863, when Cyrenus became the first postmaster of the community and the name was changed to Condit. The Condits and their descendents were elders of the rural Presbyterian church for a long as it remained active.

Pleasant Grove Presbyterian Church was in continuous use until the outbreak of the Second World War. For a time, the building deteriorated through neglect and vandalism. In the late 1940s descendents of the Condit family, members of the congregation and neighbors in the farming community cooperated in restoring the structure to a serviceable condition. The roof was replaced, and new glazing provided for the window sash. In 1961 the Presbytery of Willamette voted to sell all but 2.6 acres of the 40-acre Pleasant Grove tract. The remaining parcel encompassed the church, cemetery and a grove of fir trees. The church was used on a limited basis, for special occasions only. Eventually, however, it was abandoned and suffered increasingly the effects of vandalism and lack of maintenance. On September 23, 1984, the church was relocated to Salem, where a site had been prepared for it on the grounds of the Mission Mill Museum.

While moving the church 20 miles from its original setting in an effort to preserve it is in one sense extreme, the relocation to Salem is historically appropriate. Administratively, the church established by the Condits was linked to the First Presbyterian Church of Salem from 1866 onward. When, in 1961, most of the Pleasant Grove tract was sold and the church was no longer used on a regular basis, the Condits' silver ewer and communion cup were placed with the Salem congregation for safekeeping.

**United States Department of the Interior  
National Park Service**

**National Register of Historic Places  
Inventory—Nomination Form**



PLEASANT GROVE  
PRESBYTERIAN CHURCH

Continuation sheet

Item number

9

Page 1

Corning, Howard McKinley, Dictionary of Oregon History (Portland: Binfords and Mort, 1956), p. 204.

"Homecoming at Pioneer Church Attracts Many," Capital Journal (August 21, 1928), p. 2.

"Pioneer Church Making Ready to Observe 80th Date of its Founding," Capital Journal, (July 17, 1936), p. 3.

McKay, Floyd, "Old Church to Remain, But Land Around it Being Sold," Oregon Statesman (April 22, 1961), p. 5.

"Descendant Proud of Church History," The Stayton Mail (July 8, 1976), p. 11.

"Church to be Moved to Mission Mill," Statesman-Journal (April 26, 1984), B-2.

"Old Church Takes to the Road for New Lease on Life," Statesman-Journal (September 24, 1984).

ORIGINAL LOCATION OF THE  
 PARSONAGE OF THE METHODIST  
 MISSION IN OREGON

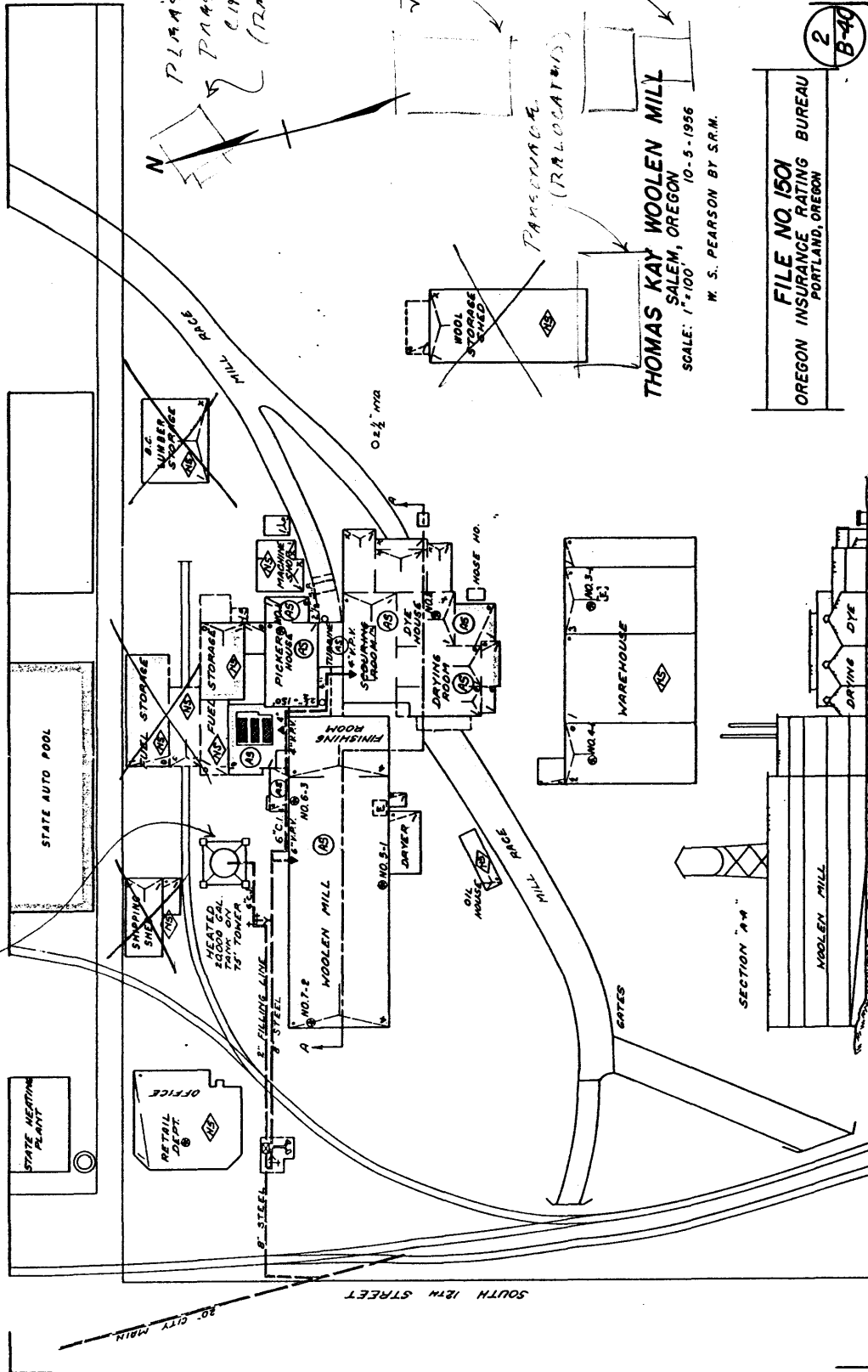



**NATIONAL REGISTER OF HISTORIC PLACES  
INVENTORY - NOMINATION FORM**

(Type all entries - complete applicable sections)

STATE: <b>Oregon</b>
COUNTY: <b>Marion</b>
FOR NPS USE ONLY
ENTRY DATE <b>AUG 7 1974</b>

**1. NAME**

COMMON:  
**Pleasant Grove Presbyterian Church**

AND/OR HISTORIC:

**2. LOCATION**

STREET AND NUMBER:  
**1 mile N.W. of West Stayton - Oregon Second Congressional District**

CITY OR TOWN:  
**West Stayton vicinity 97325**

CONGRESSIONAL DISTRICT:  
**Representative Al Ullman**

STATE <b>Oregon</b>	CODE <b>41</b>	COUNTY: <b>Marion</b>	CODE <b>047</b>
------------------------	-------------------	--------------------------	--------------------

**3. CLASSIFICATION**

CATEGORY (Check One)	OWNERSHIP	STATUS	ACCESSIBLE TO THE PUBLIC
<input type="checkbox"/> District <input type="checkbox"/> Site <input type="checkbox"/> Object <input checked="" type="checkbox"/> Building <input type="checkbox"/> Structure	<input type="checkbox"/> Public <input checked="" type="checkbox"/> Private <input type="checkbox"/> Both	Public Acquisition: <input type="checkbox"/> In Process <input type="checkbox"/> Being Considered <input checked="" type="checkbox"/> Occupied <input type="checkbox"/> Unoccupied <input type="checkbox"/> Preservation work in progress	Yes: <input checked="" type="checkbox"/> Restricted <input type="checkbox"/> Unrestricted <input type="checkbox"/> No
PRESENT USE (Check One or More as Appropriate)			
<input type="checkbox"/> Agricultural <input type="checkbox"/> Commercial <input type="checkbox"/> Educational <input type="checkbox"/> Entertainment	<input type="checkbox"/> Government <input type="checkbox"/> Industrial <input type="checkbox"/> Military <input type="checkbox"/> Museum	<input type="checkbox"/> Park <input type="checkbox"/> Private Residence <input checked="" type="checkbox"/> Religious <input type="checkbox"/> Scientific	<input type="checkbox"/> Transportation <input type="checkbox"/> Other (Specify) <input type="checkbox"/> Comments

**4. OWNER OF PROPERTY**

OWNER'S NAME:  
**Trustees of the Presbytery of Willamette** (Owners notified of proposed nomination 11/7/72)

STREET AND NUMBER:  
**c/o Presbyterian Synod Office - 0245 S.W. Bancroft**

CITY OR TOWN:  
**Portland**

STATE:  
**Oregon**

CODE:  
**41**

**5. LOCATION OF LEGAL DESCRIPTION**

COURTHOUSE, REGISTRY OF DEEDS, ETC.:  
**Marion County Courthouse**

STREET AND NUMBER:

CITY OR TOWN:  
**Salem**

STATE:  
**Oregon**

CODE:  
**97301**

**6. REPRESENTATION IN EXISTING SURVEYS**

TITLE OF SURVEY:  
**Statewide Inventory of Historic Sites and Buildings**

DATE OF SURVEY:  
 Federal  State  County

DEPOSITORY FOR SURVEY RECORDS:  
**Parks and Recreation Section**

STREET AND NUMBER:  
**Oregon State Highway Building**

CITY OR TOWN:  
**Salem**

STATE:  
**Oregon**

CODE:  
**97310**

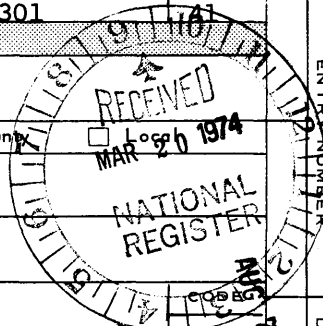

SEE INSTRUCTIONS

STATE: Oregon  
COUNTY: Marion  
ENTRY NUMBER:  
DATE:

FOR NPS USE ONLY

7. DESCRIPTION

CONDITION	(Check One)					
	<input type="checkbox"/> Excellent	<input checked="" type="checkbox"/> Good	<input type="checkbox"/> Fair	<input type="checkbox"/> Deteriorated	<input type="checkbox"/> Ruins	<input type="checkbox"/> Unexposed
	(Check One)			(Check One)		
	<input type="checkbox"/> Altered	<input checked="" type="checkbox"/> Unaltered	<input type="checkbox"/> Moved	<input checked="" type="checkbox"/> Original Site		

DESCRIBE THE PRESENT AND ORIGINAL (if known) PHYSICAL APPEARANCE

Pleasant Grove Presbyterian Church is located in Section 11, T.9S., R.2W., of the Willamette Meridian, in Marion County, Oregon. It is situated in the West Stayton vicinity, one mile west of Stayton, on a prairie surrounded by the Waldo Hills on the north, and the Salem Hills on the west.

The church was finished in 1858 by followers of the Presbyterian Minister Philip Condit. A single-story meeting house type in the vernacular tradition, the church has a nearly square plan measuring approximately 24 by 28 feet. The shingled gable roof has a medium pitch, and a brick stove flue straddles the ridge at the center. The eaves are finished with a plain boxed cornice with returns on the east and west gable ends, and a plain frieze. Clapboards forming the exterior wall cover show six inches to the weather. Plain corner boards were used. There are no windows in the gable ends, but there are three windows in either side elevation. The openings have plain surrounds and are covered with plain wooden shutters when the building is not in use. The building rests on wooden piers which are not exposed to view, being covered by a water skirt of vertical boards. A porch extends nearly the length of the east face. The hipped porch roof is supported by four chamfered posts and shelters two formally arranged two-panel doors on either side of the facade.

A wood stove heats the building, and the interior is equipped with electric lighting. The church and its cemetery are shaded by a grove of mature oak trees. The property is maintained by members of the congregation and the Presbyterian Church.



SEE INSTRUCTIONS

**8. SIGNIFICANCE**

PERIOD (Check One or More as Appropriate)

- |  |                                       |  |                                       |
|--|---------------------------------------|--|---------------------------------------|
| <input type="checkbox"/> Pre-Columbian | <input type="checkbox"/> 16th Century | <input type="checkbox"/> 18th Century            | <input type="checkbox"/> 20th Century |
| <input type="checkbox"/> 15th Century  | <input type="checkbox"/> 17th Century | <input checked="" type="checkbox"/> 19th Century |                                       |

SPECIFIC DATE(S) (If Applicable and Known) **1857 -1858**

AREAS OF SIGNIFICANCE (Check One or More as Appropriate)

- |  |   |   |  |
|--|---|---|--|
| <input type="checkbox"/> Aboriginal              | <input type="checkbox"/> Education              | <input type="checkbox"/> Political                      | <input type="checkbox"/> Urban Planning        |
| <input type="checkbox"/> Prehistoric             | <input type="checkbox"/> Engineering            | <input checked="" type="checkbox"/> Religion/Philosophy | <input type="checkbox"/> Other (Specify) _____ |
| <input type="checkbox"/> Historic                | <input type="checkbox"/> Industry               | <input type="checkbox"/> Science                        | _____  |
| <input type="checkbox"/> Agriculture             | <input type="checkbox"/> Invention              | <input type="checkbox"/> Sculpture                      | _____  |
| <input checked="" type="checkbox"/> Architecture | <input type="checkbox"/> Landscape Architecture | <input type="checkbox"/> Social/Humanitarian            | _____  |
| <input type="checkbox"/> Art                     | <input type="checkbox"/> Literature             | <input type="checkbox"/> Theater                        | _____  |
| <input type="checkbox"/> Commerce                | <input type="checkbox"/> Military               | <input type="checkbox"/> Transportation                 | _____  |
| <input type="checkbox"/> Communications          | <input type="checkbox"/> Music                  |   |  |
| <input type="checkbox"/> Conservation            |   |   |  |

STATEMENT OF SIGNIFICANCE

Pleasant Grove Presbyterian Church is one of an important group of small churches in the meeting house tradition dating from the 1850s still standing in the Willamette Valley. No more than half a dozen examples of the type have been identified to date, whereas they are believed to have been numerous in pre-Territorial days. It is one of the oldest, if not the oldest Presbyterian church extant in Oregon. If the attributed date of 1854 is correct, only Mt. Pleasant Presbyterian Church southeast of Stayton is older.

The Reverend Philip Condit, with sons Sylvanus and Cyranus, arrived in Marion County in 1854. While plans for the formation of a Presbyterian congregation may have begun in 1855, the dates of September 27 or September 28, 1856 are given as the official founding of the Pleasant Grove Church. Reverend Condit died shortly thereafter of Rocky Mountain fever. (The date of death given on his headstone in the adjacent cemetery is November 21, 1856.) Condit's son Sylvanus was appointed ruling elder, and it was he who, with his brother, carried out his father's plans for the church building.

A 40-acre site was chosen on the claim of Cyranus Condit between the present towns of Aumsville and West Stayton. In early days, Aumsville was called Hoggum for the many pigs to be found in the area. The quaint place name was used until July 10, 1863, when Cyranus became the first postmaster of the community and the name was changed to Condit.

According to local tradition, all the rafters and timbers were hand-hewn from native fir. The rough lumber was hauled by ox team from Oregon City and planed on the site. Construction was carried out between the spring of 1857 and 1858.

Pleasant Grove Presbyterian Church was in continuous use until the outbreak of the Second World War. For a time the building deteriorated through neglect and vandalism. In the late 1940s descendants of the Condit family, members of the congregation and friends cooperated in restoring the structure to a serviceable condition. The roof was replaced, and new glazing provided for the window sash. In 1961 the Presbytery of Willamette voted to sell all but 2.6 of the 40-acre Pleasant Grove tract. The church, cemetery and a grove of oaks are situated on the remaining parcel. The church is used for special occasions, including weddings and funerals. According to a marker on the church grounds, it is "the oldest church building erected by Presbyterians on the Pacific Coast."

SEE INSTRUCTIONS

**9. MAJOR BIBLIOGRAPHICAL REFERENCES**

Corning, Howard McKinley, Dictionary of Oregon History (Portland: Binford and Mort, 1956), 204.

"Homecoming at Pioneer Church Attracts Many," Capital Journal (August 21, 1928), 2.

"Pioneer Church Making Ready to Observe 80th Date of its Founding," Capital Journal (July 17, 1936), 3.

HR  
10/508870  
4960540

**10. GEOGRAPHICAL DATA**

LATITUDE AND LONGITUDE COORDINATES DEFINING A RECTANGLE LOCATING THE PROPERTY			O R	LATITUDE AND LONGITUDE COORDINATES DEFINING THE CENTER POINT OF A PROPERTY OF LESS THAN TEN ACRES		
CORNER	LATITUDE	LONGITUDE		LATITUDE	LONGITUDE	
	Degrees Minutes Seconds	Degrees Minutes Seconds		Degrees Minutes Seconds	Degrees Minutes Seconds	
NW	0 ' "	0 ' "		44 ° 48 ' 01 "	122 ° 53 ' 16 "	
NE	0 ' "	0 ' "				
SE	0 ' "	0 ' "				
SW	0 ' "	0 ' "				

APPROXIMATE ACREAGE OF NOMINATED PROPERTY: **2.6 acres**

LIST ALL STATES AND COUNTIES FOR PROPERTIES OVERLAPPING STATE OR COUNTY BOUNDARIES

STATE:	CODE	COUNTY	CODE
STATE:	CODE	COUNTY:	CODE
STATE:	CODE	COUNTY:	CODE
STATE:	CODE	COUNTY:	CODE

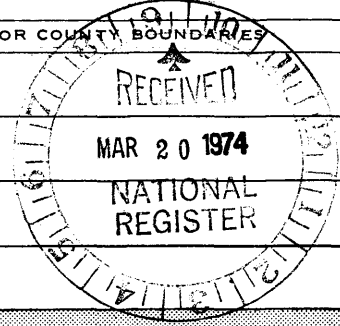

SEE INSTRUCTIONS

**11. FORM PREPARED BY**

NAME AND TITLE: **Paul B. Hartwig, Assistant Park Historian**

ORGANIZATION: **Oregon State Highway Division** DATE: **January 1974**

STREET AND NUMBER: **State Highway Building**

CITY OR TOWN: **Salem** STATE: **Oregon** CODE: **41**

**12. STATE LIAISON OFFICER CERTIFICATION**

As the designated State Liaison Officer for the National Historic Preservation Act of 1966 (Public Law 89-665), I hereby nominate this property for inclusion in the National Register and certify that it has been evaluated according to the criteria and procedures set forth by the National Park Service. The recommended level of significance of this nomination is:

National  State  Local

Name: *Denise Felber*

Title: State Parks Superintendent

Date: 3/15/74

**NATIONAL REGISTER VERIFICATION**

I hereby certify that this property is included in the National Register.

*A. R. Hartwig*  
Director, Office of Archeology and Historic Preservation

Date: 3/17/74

ATTEST:  
*W. J. ...*  
Keeper of The National Register

Date: 3-1-74

United States Department of the Interior  
National Park Service

1/1/87

# National Register of Historic Places Continuation Sheet

Section number \_\_\_\_\_ Page \_\_\_\_\_

Pleasant Grove Presbyterian Church  
Marion Co., OR

---

Date/Signature

REMOVAL - Automatically removed due  
to move in 9/23/84

Keeper *Armond Byrum* 9/23/84



PLEASANT GROVE PRESBYTERIAN CHURCH

ORIGINAL SETTING

WEST STAYTON VICINITY

MANION COUNTY, OREGON

SUPPLEMENTAL SERIES 1 OF 4

0450

MELISSA WILSON PHOTO, 1971

SOUTH ALBUQUERQUE





PLACANT GROVE PRESBYTERIAN CHURCH

ORIGINAL SETTING

WEST STAYTON VICINITY

MARION COUNTY, OREGON

0450

SUPPLEMENTAL SERIES 2 OF 4

ELISABETH WALTON PHOTO, 1971

WEST END AND SOUTH ELEVATION



PLEASANT GROVE PRESBYTERIAN CHURCH  
ORIGINAL SETTING  
WEST STAYTON VICINITY  
MARION COUNTY, OREGON

0560

SUPPLEMENTAL SERIES 3 OF 4

ALISA BETH WALTON PHOTO, 1971

SOUTH ELEVATION AND EAST END

## FLEASANT GROVE

PRESBYTERIAN CHURCH  
BEGAN WITH THE ARRIVAL  
OF THE REVEREND PHILIP  
CONDIT IN SEPTEMBER 1854.  
THE CONGREGATION WAS OR-  
GANIZED JANUARY 1, 1855.  
THE BUILDING WAS COMPLET-  
ED IN 1858. IT IS THE OLDEST  
CHURCH BUILDING ERECTED  
BY PRESBYTERIANS ON THE  
PACIFIC COAST.

PLEASANT GROVE PRESBYTERIAN CHURCH  
ORIGINAL SETTING  
WEST STAYTON VICINITY  
MARION COUNTY, OREGON

0450

SUPPLEMENTAL SERIES 4 OF 4

ELIZABETH WALTON PIKORO, 1971

HISTORICAL MANUAL, SOUTH PLACEMENT



UNITED STATES DEPARTMENT OF THE INTERIOR  
NATIONAL PARK SERVICE

NATIONAL REGISTER OF HISTORIC PLACES  
PROPERTY PHOTOGRAPH FORM

(Type all entries - attach to or enclose with photograph)

STATE Oregon	
COUNTY Marion	
FOR NPS USE ONLY	
ENTRY NUMBER	DATE

AUG 7 1974

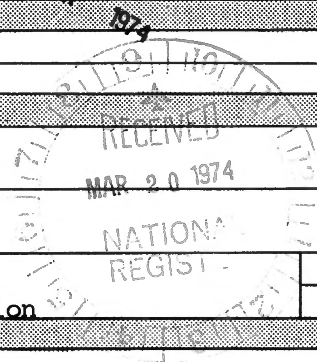

LOCATION: Pleasant Grove Presbyterian Church

OR HISTORIC:

DESCRIPTION:

SET AND NUMBER:

1 mile N.W. of West Stayton

OR TOWN:

West Stayton vicinity

STATE: Oregon

CODE 41	COUNTY: Marion	CODE 047
------------	-------------------	-------------

NO REFERENCE

TO CREDIT: Oregon State Highway Division

DATE OF PHOTO: 1971

PHOTO FILED AT:

Parks and Recreation Section, State Highway Building, Salem, Oregon 97310

IDENTIFICATION

DESCRIBE VIEW, DIRECTION, ETC.

Southeast view from gravel-surfaced road.





Pleasant Grove Presbyterian Church  
1313 Mill Street SE  
Salem, Marion County, Oregon

Mission Mill photo, 1986  
(Harry Brevoort)  
1313 Mill SE, Salem, OR 97301

1 of 6

Looking northeasterly at principal  
facade.



Pleasant Grove Presbyterian Church  
1313 Mill Street SE  
Salem, Marion County, Oregon

Mission Mill photo, 1986  
(Harry Brevoort)

1313 Mill SE, Salem, OR 97301

2 of 6

Northwest and southwest elevations.



Pleasant Grove Presbyterian Church  
1313 Mill Street SE  
Salem, Marion County, Oregon

Mission Mill photo, 1986  
(Harry Brevoort)  
1313 Mill SE, Salem, OR 97301

3 of 6

Northeast and northwest elevations.

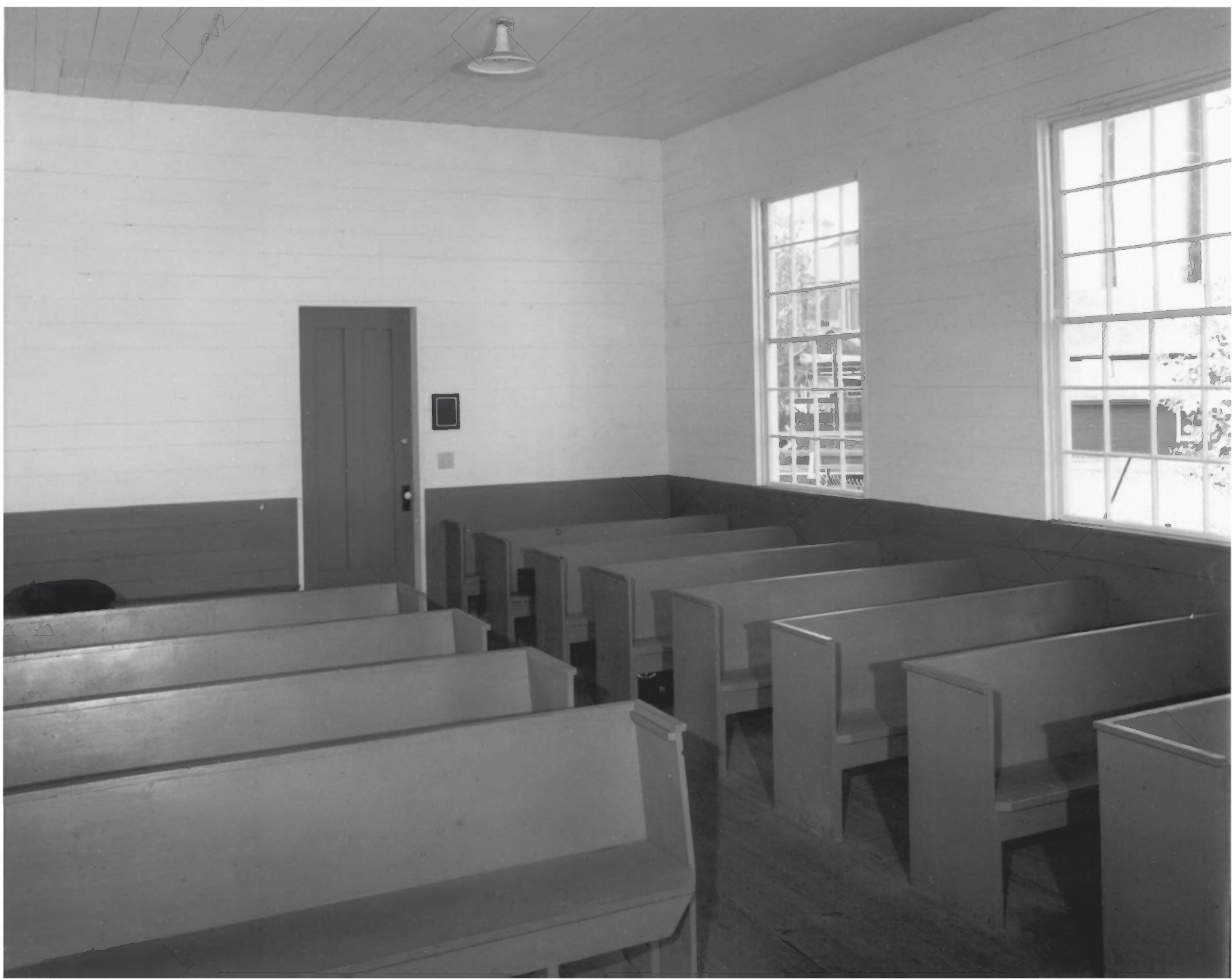

Pleasant Grove Presbyterian Church  
1313 Mill Street SE  
Salem, Marion County, Oregon

Mission Mill photo, 1986  
(Harry Brevoort)

1313 Mill SE, Salem, OR 97301

4 of 6

Interior view, looking westerly at  
one of front entrances.





Pleasant Grove Presbyterian Church  
1313 Mill Street SE  
Salem, Marion County, Oregon

Mission Mill photo, 1986  
(Harry Brevoort)

1313 Mill SE, Salem, OR 97301

5 of 6

Interior view, looking northeasterly.  
Box pews, pulpit and cabinet bookcase  
are hand-crafted pieces, original

church furniture. Exit doorway is  
recent intrusion.



Pleasant Grove Presbyterian Church  
1313 Mill Street SE  
Salem, Marion County, Oregon

Mission Mill photo, 1986  
(Harry Brevoort)  
1313 Mill SE, Salem, OR 97301

6 of 6

Interior view, looking northeasterly  
toward cabinet bookcase created by  
Cyrenus Condit, son of church  
founder.