

ASHLAND CULTURAL RESOURCE INVENTORY
SURVEY FORM
COUNTY: JACKSON

IDENTIFICATION:

Hist. Name Patrick, W.A. House Date of Construction: 1903
Common Name: _____ Original Use: Residence
Address: 219 Almond Street Present Use: Residence
Ashland, Oregon Architect: _____
Owner: Estes, James W./ Shirley Builder: _____
219 Almond Street Style: Queen Anne Shingle
Ashland, Oregon Bldg. _____ Struc. _____ Dist. _____ Obj. _____
T/R/S: 39S RIE 8 Ranking: Secondary
Map No: 8AA Tax Lot: 6600
Addition: _____
Block: _____ Lot: _____ Quad: Ashland

THEME:

Statewide Inventory of Historic Properties Theme: 6d
 Archaeology Industry Mining
 Agriculture Military Social/Education
 Commerce Politics/Government Transportation
 Exploration and Settlement Religion Other

DESCRIPTION:

Plan Type/Shape: T-Shaped No. of Stories: One-and-a-half
Foundation Material: Stone Basement (Y/N): Crawl space
Roof Form and Material: Gable; jerkinhead, intersecting ridge;
composition shingle
Wall Construction: Frame Structural Frame: _____
Primary Window Type: One-over-one double hung sash
Exterior Surfacing Materials: Horizontal 'V' joint shiplap;
wood shingle, regular cut
Decorative Features: Recessed archway, second level exterior
wall plane
Other: _____

Condition: Excellent Good Fair Poor Moved (Date) _____

Exterior Alterations/Additions (Dated) _____

Noteworthy Landscape Features: _____

Associated Structures: Detached garage

Known Archaeological Features: _____

Negative No: Roll 9-11 Recorded By: Clay/Atwood

Slide No: _____ Date: 1984/ 22 June 1990

SHPO Inventory No: 1202

ASHLAND CULTURAL RESOURCE INVENTORY
SURVEY FORM

Name: Patrick. W.A. House T/R/S: 39S RIE 8
 Address: 219 Almond Street Map No: 8AA Tax Lot: 6600
Ashland, Oregon Quadrangle: Ashland (1953)



Negative No.: Roll 9-11 Slide No.: _____

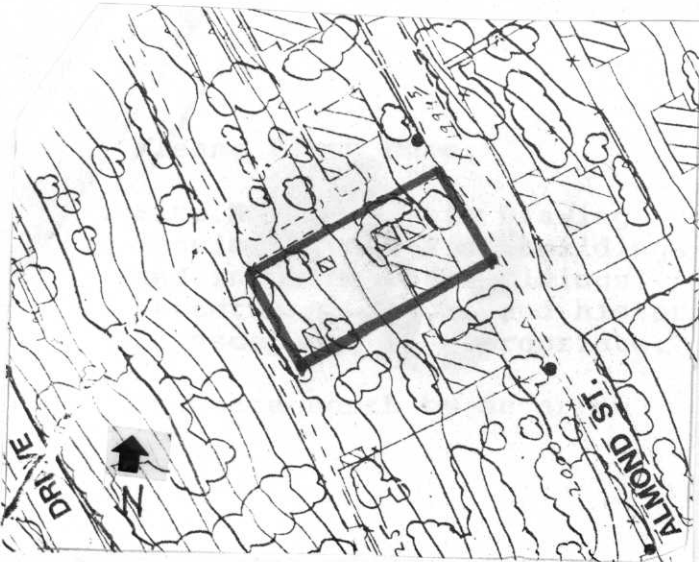

Graphic and Photo Sources: City of Ashland Topographic Map;
Jackson County Assessor Map

SHPO Inventory No.: 1202

OREGON INVENTORY OF HISTORIC PROPERTIES
HISTORIC RESOURCE SURVEY SHEET



* Historic Name: _____
 * _____
 * Common Name: _____
 * _____
 * Address: 219 Almond Street
Ashland, Oregon
 * Owner: Estes, James w/
Shirley
 * Address: 219 Almond Street
Ashland, Oregon
 * Lot Block
 * Addition Unknown
 * Plat T39, R1E, S8AA
 * Tax Lot 6600

Date of Construction Prior to 1911; 1901 estimated
 Present use/function Residence Original use/function: Residence
 Area of significance/study theme: Architecture
 Architectural style: St. Queen Anne/Shingle style Arch./Bldr., if known _____

Plan type/shape: T-shaped No. of stories: One and a half
 Foundation material: Stone Basement (y/n): Crawl Space
 Roof form & materials: Gable; jerkinhead, intersecting ridge; composition shingle
 Wall construction: Frame Structural frame: _____
 Primary window type: One over one double hung sash
 Primary exterior surfacing materials: Horizontal 'V' joint shiplap; wood shingle, regularly cut
 Outstanding decorative features: Recessed archway, second level eithon wall plane

Condition: ___ Excellent Good ___ Fair ___ Deteriorated ___ Moved ___ (date) _____
 Associated Structures: Detached garage
 Exterior alterations/additions (dated): _____
 Known archeological features of site: _____
 Noteworthy landscape features: _____

Recorded by: _____ Date: _____
 Negative No.: Roll 9-11 Slide No.: _____
(4-16-1984)

State Inventory No. 1202

OREGON INVENTORY OF HISTORIC PROPERTIES
HISTORIC RESOURCE SURVEY SHEET-TWO

Describe geographic location & immediate setting This one and a half story, wood frame dwelling is situated on the uphill (southwest) side of Almond Street, on the southwest corner of Almond and Laurel Streets.

Statement of Significance (Historical and/or architectural importance, dates, events, persons, contexts): The subject site and general area was not included on insurance maps of the Sanborn Map Company until June, 1911, at that time this structure was shown.

Assessment records maintained by Jackson County list 1901 as the year of construction.

Quadrangle name: Ashland (1953)
Township 39 Range 1E Section 8AA Tax Lot 0600

PLEASE PLACE HERE:

Site map schematic drawing showing inventoried bldg. (s) and including outbuildings, structures, roads, and historic landscaping, if appropriate. Indicate north by an arrow.

PLEASE PLACE HERE:

Town map with cross streets for urban areas or section of USGS map for rural areas.

Sources:

Insurance maps of Ashland, Sanborn Map Co. 1911
Jackson County Assessment Records