

JACKSON COUNTY CULTURAL AND HISTORICAL RESOURCE SURVEY

1990 ADDENDUM FORM



T 39S R 1E S 13D TL 2000
 Theme Settlement; Architecture; Agric
 Common Name _____
 Historic Name Dunn, Patrick House
 Address 4224 Highway 66
Ashland, Oregon 97520
 Present Owner Provost, Dom
 Address 351 East Main Street
Ashland, Oregon 97520
 Original Use Farmstead/Residence
 Present Use Residence
 Date of Construction 1860
 Ranking: Primary

Date of Photo 25 March 1992 National Register Yes Date _____
 Negative No. KI: 25 Determination of Eligibility Yes Date _____
 Slide No. KA:11 Statewide Inventory Yes

Recorded by Clay/Atwood Date 1979/1991

Sources Consulted:

1992 Field Check: Addition on rear elevation

SHPO No. 3

JC No. 402

JACKSON COUNTY CULTURAL AND HISTORICAL RESOURCE SURVEY

NAME: Dunn, Patrick House

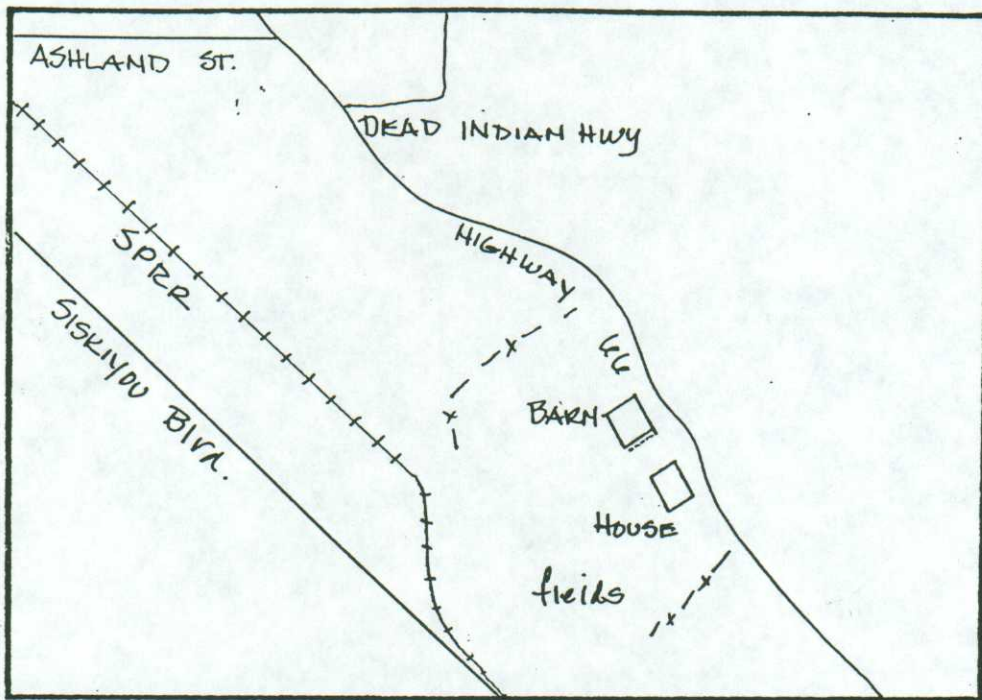

VIEW: _____

DATE OF PHOTO: _____

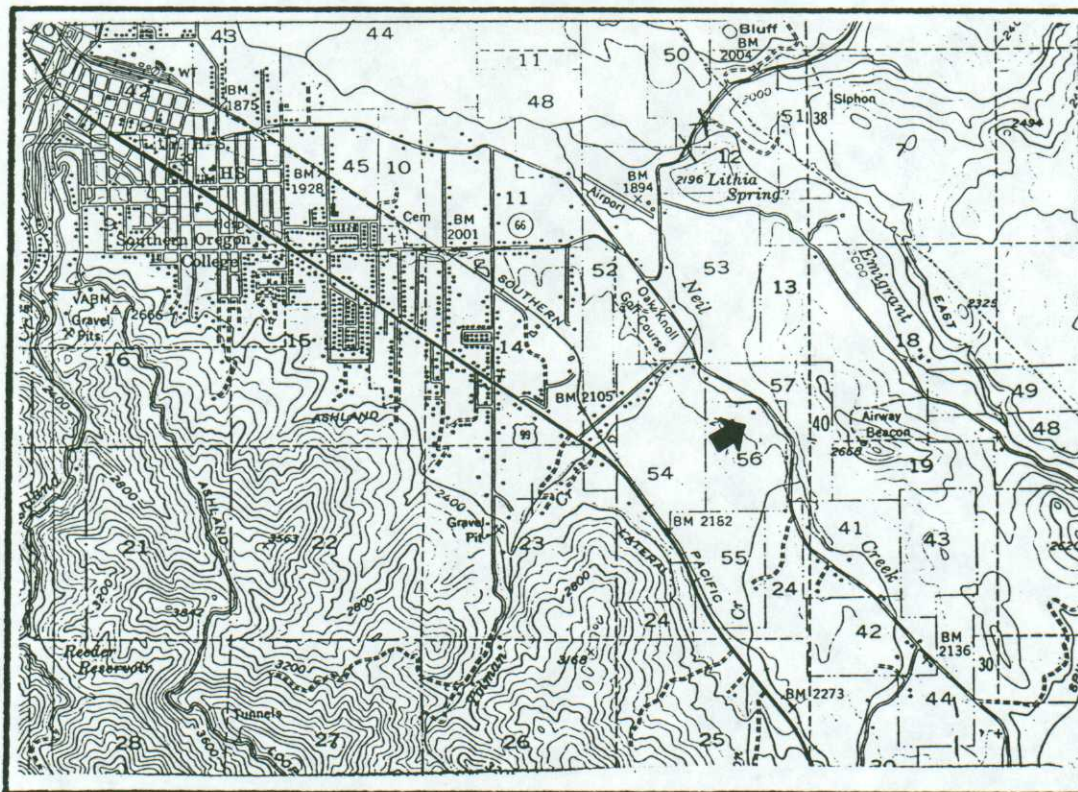

QUADRANGLE: Ashland: 1954

SHPO NO _____

JC NO 402

JACKSON COUNTY CULTURAL AND HISTORICAL RESOURCE SURVEY

1990 ADDENDUM FORM



T 39S R 1E S 14 TL 101
 Theme Agriculture
 Common Name Dunn, Patrick Barn
 Historic Name Dunn, Patrick Barn
 Address 4224 Highway 66
Ashland, Oregon 97520
 Present Owner Provost, Dom
 Address 351 East Main Street
Ashland, Oregon 97520
 Original Use Barn
 Present Use Barn
 Date of Construction ca. 1870
 Ranking: Primary

Date of Photo 28 March 1992 National Register (Y) Yes Date 1978
 Negative No. KI:26 Determination of Eligibility () Yes Date _____
 Slide No. KA:12 Statewide Inventory (X) Yes

The Patrick Dunn Barn, like the Dunn residence, is situated southeast of Ashland along Highway 66 near Emigrant Creek. The hewn frame structure is long and rectangular in size and is sheathed in vertical plank siding. The side-opening barn, constructed about 1870, has a corrugated metal roof.

Patrick Dunn was born March 24, 1824 in Ireland. He emigrated to the United States with his parents and was educated in Philadelphia. His parents later located in Illinois. In 1850 Patrick Dunn came to California to the Salmon River mines and in 1851 settled on this ranch near Ashland Oregon. He married Mary M. Hill and the couple raised five children. In 1854-1855 Dunn served in the territorial legislature. In 1864 he was county assessor and in 1872 was elected county clerk. Dunn also served as a Jackson County Commissioner. He died July 29, 1901. Mary Dunn, daughter of Isaac and Elizabeth Dunn, along with her sisters, were long prominent in Ashland cultural and social life. The Patrick Dunn farmstead, listed in the National Register of Historic Places, is an extremely significant example of early Jackson County settlement. Its integrity of setting has been maintained to date, although development pressures continue to exist.

Recorded by Clay/Atwood Date 1979/1991

Sources Consulted:
 "Mrs. Mary (Hill) Dunn." Portrait and Biographical Record of Western Oregon. Chicago: Chapman Publishing Company, 1904, pp. 663-664.

SHPO No. 2273

JC No. 525

JACKSON COUNTY CULTURAL AND HISTORICAL RESOURCE SURVEY

NAME: Dunn, Patrick Barn

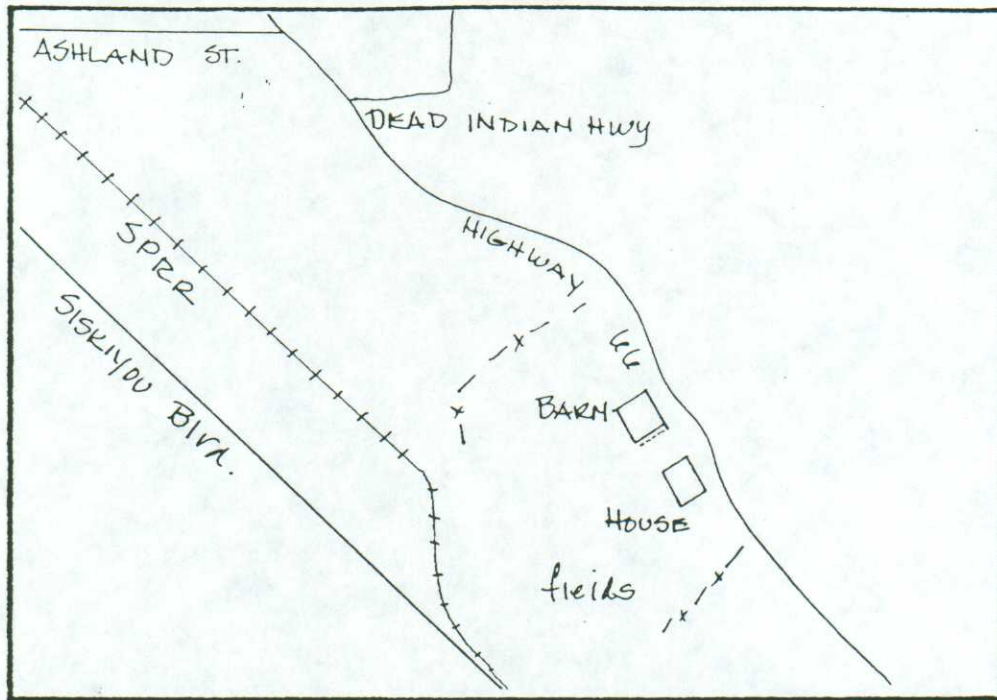

VIEW: _____

DATE OF PHOTO: _____

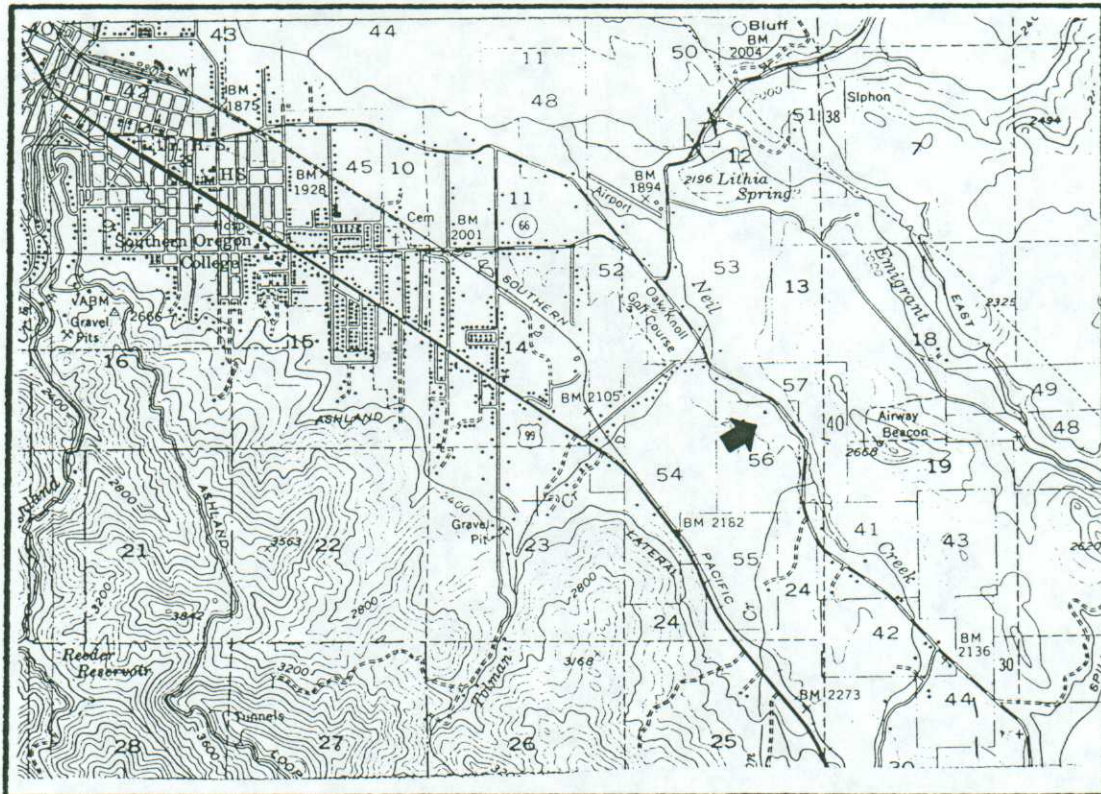

QUADRANGLE: Ashland: 1954

SHPO NO _____

JC NO 525

STATE OF OREGON INVENTORY
 HISTORIC SITES AND BUILDINGS
 State Historic Preservation Office
 Oregon State Parks, Salem 97310



County Jackson
 Theme 10-A
 Name
 (Common) Dunn (Patrick) House
 (Historic) (same)
 Address 4224 Highway 66
Ashland, Oregon
 Present Owner Al & Margaret Meyer
4224 Highway 66
 Address Ashland, Oregon
 Original Use Residence
 Date of Construction c. 1858-62

Physical description of property and statement of historical significance:

The Patrick Dunn house is a two story, wood frame building the Classical Revival Style. This house stands southeast of Ashland in the watershed of Emigrant Creek and is on the old route of the Oregon-California Trail. The house has six-over-six, double hung sash windows, clapboard siding, and has a low gable roof. The front porch, like the nearby John P. Walker house (see file sheet), has vertical board and batten siding. A verandah reaches across the front elevation. The house has boxed eaves, wide frieze boards, and partial eave returns on the gable ends. A two story addition is attached on the rear elevation. This house has a stone foundation. The building was undergoing complete restoration in the summer of 1976.

Patrick Dunn was born March 24, 1824, in County Wexford, Ireland, and was the son of Patrick and Jane (Toole) Dunn. He emigrated to the United States with his parents and was educated in Philadelphia. His parents later located in Illinois. In 1850 Patrick Dunn rushed to California to the Salmon River mines and in 1851 settled on this ranch near Ashland, Oregon. He was wounded in the Rogue River Indian War. Patrick Dunn married Mary M. Hill. The Dunns had five children. In 1854-55 Dunn served in the territorial legislature; in 1864 he was county assessor; and in 1872 was elected county clerk. He also served as a county commissioner. Patrick Dunn died July 29, 1901.

(over)

continue on back if necessary

Recorded by Stephen Dow Beckham Date 29 August 1976

For Oregon State Historic Preservation Office Sources Consulted:

Please enclose map Township 39^S 1^N 24^E Section 24 "Mrs. Mary Minerva (Hill) Dunn." Portrait and Biographical Record of Western Oregon.
 Chicago: Chapman Publishing Company, 1904, pp. 663-664.

Mrs. Dunn emigrated to Oregon with her parents in 1849. Her father was Isaac Hill. Martha (Hill) Gillette, a sister, wrote an autobiography of her experiences in the west which was published in the 1960's. Another sister, Ann Haseltine Russell, was a well-known marble cutter and sculptor and worked in Ashland, Oregon, in the late 19th century.

1849

Martha (Hill) Gillette
Ann Haseltine Russell



Isaac Hill
Martha (Hill) Gillette
Ann Haseltine Russell

Martha (Hill) Gillette
Ann Haseltine Russell

Martha (Hill) Gillette
Ann Haseltine Russell

STATE OF OREGON INVENTORY
HISTORIC SITES AND BUILDINGS
State Historic Preservation Office
Oregon State Parks, Salem 97310

County Jackson
Theme Architecture/Pioneer Settlement
Name
(Common) Dunn House
(Historic) Patrick Dunn Ranch
Address 4224 Highway 66
Ashland, OR. 97520
Present Owner Mr. and Mrs. Albert Meyer
Address 4224 Highway 66, Ashland, OR.
Original Use residence
Date of Construction 1860

Place Photo Here

(please see photographs on reverse)

Physical description of property and statement of historical significance:

Site: House sits on 270 acre working farm. House faces east and is rectangular in plan with the long axis oriented east-west.

Foundation: rubble sandstone ashlar; laid dry.

Structure: wood frame; two storey. Style: vernacular farm house.

Walls: wood clapboard with 6" face on eastern wing of house; 4 1/2" face clapboard on rest of house. A 10" board covers the sill above stone foundation/ vertical plain trim at corners/ the wall sheathing of east wall (porch wall) is board and batten. The vertical trim at the porch wall corners also differs from trim elsewhere in that it employs a recessed panel design which exists from sill to frieze.

Windows: French windows on either side of central entry door open to covered front (east) porch. Other windows are either square with 6 lites or rectangular and double hung with lites in 6/6 arrangement. Square windows are found in the mid section of the house while rectangular windows are found throughout the house facade. The sun room, formerly the screened-in porch, is enclosed with fixed windows employing 10 lites.

Roof: sheathed with wood shakes throughout. porch roof (east end) is a low hipped affair/ house roof and adjacent root cellar employ gabled structure/ sun room has a flat roof. gable ends feature projecting verges/ boxed cornice with wide frieze below at eaves.

continue on back if necessary

Recorded by Robert Fink Date May 6, 1977

For Mr. and Mrs. Albert Meyer

Sources Consulted: Interview with owners
-April, 1977

Please enclose map Township 39 ^N S ^{R1} W Section 24

Medford Mail Tribune, article, 3/6/66

(please reverse side for continuation)

SHPO 3

Historical Sketch: Patrick Dunn, a native of Ireland, arrived in the Rogue River Valley in 1851; after an unsuccessful attempt at mining in California. He married Mary Hill, daughter of another early valley settler, Isaac Hill in 1854. Dunn's first house was a log cabin, but he constructed the present house in 1860.

The home has remained in the Dunn family for over a century. Patrick's son George operated the farm after his father; followed by George's son, Edwin. Mrs. Edwin Dunn still owned the property when the Meyer's purchased the property in 1970.

Much local history is associated with the place. The Dunn House was a center of hospitality and political activity in southern Oregon. Patrick Dunn was elected to the First Territorial Legislature and several local positions, eg, county assessor, county clerk, and county commissioner. Later, Patrick's son, George, became a state senator.

The Dunn Ranch is also a designated Century Farm.

General Interior Description: interior spaces have been retained in much their original arrangement. The major alteration to the interior has been the addition of a bay window to the north wall of the kitchen. Also, wood beams have been added to the ceilings of the downstairs rooms as a device to help tie the structure together.

The entry door opens inward to a hall on the first level. To the north, the parlor door opened from the central hall; on the other side was a bedroom. Each room featured a French window. Stairs from the hall ascend, via 15 risers, to the second level. A second set of interior stairs connects the second floor with a first level, laundry room at the rear.

The house is furnished in antiques and contemporary decor. Of interest, one of the upstairs bedrooms retains its austere horizontal board wall, painted white, and wood ceiling; original textures which were once common to the upper rooms.

Note: Only the main house, its adjacent buildings, and five acres are specified for nomination to the state historic inventory. The auxiliary buildings are the hen house, the privy, the weighing station, the old wood shed, and the barn. The root cellar is considered as part of the main house as it is attached via the sun room.



3/4 VIEW OF HOUSE FRONT & SOUTH FACADE,
LOOKING TO NORTHWEST



VIEW OF NEW BAY WINDOW ADDITION,
NORTH FACADE (FRONT OF HOUSE TO LEFT)