

**OREGON INVENTORY OF HISTORIC PROPERTIES
HISTORIC RESOURCE SURVEY FORM
COUNTY: WASCO COUNTY**

HIST. NAME: Seufert Viaduct
COMMON NAME:
ADDRESS: Old Columbia River Highway
CITY: Near The Dalles, OR
OWNER: Wasco County Roads Department
2705 E. 2nd Street
The Dalles, Oregon 97058
T/R/S: T2N R14E S31 TAX LOT: NA
QUAD: Petersburg ZONE: Scenic Area

DATE OF CONSTRUCTION: 1920
ORIGINAL USE: Transportation: bridge
PRESENT USE: Transportation: bridge
ARCHITECT: Unknown
BUILDER: Colonial Building Company
THEME: Transportation
STYLE: Reinforced Concrete Deck Girder
RESOURCE TYPE: Bridge
RANK: Determined eligible for National Register (1985)

BLDG x STRUC DIST SITE OBJ

PLAN TYPE/SHAPE: Linear
FOUNDATION MATERIAL: Concrete
ROOF FORM & MATERIALS: NA
WALL CONSTRUCTION: Concrete
PRIMARY WINDOW TYPE: NA
EXTERIOR SURFACING MATERIALS: Concrete

NO. OF STORIES: NA
BASEMENT: NA

STRUCTURAL FRAME: Concrete

DECORATIVE FEATURES:

Parabolic arched fascia walls; ornate railing and brackets; curved pier caps; concrete fascia has panels of brush hammered or pebble dash texturing

CONDITION: x GOOD FAIR POOR MOVED (DATE)

EXTERIOR ALTERATIONS/ADDITIONS:

None

NOTEWORTHY LANDSCAPE FEATURES:

The bridge spans Fifteenmile Creek.

ASSOCIATED STRUCTURES:

Interstate 84, to the north, parallels the bridge.

SETTING:

The Seufert Viaduct spans Fifteenmile Creek near The Dalles. The bridge extends east-west and parallels I-84.

STATEMENT OF SIGNIFICANCE:

The reinforced concrete girder bridge derives its name, Seufert Viaduct, from a former train station named for two pioneer brothers who moved to Oregon in the early 1880s. Located on the route of the Old Columbia River Highway, the bridge was designed under the auspices of C.B. McCullough, and constructed by the State Highway Department. The bridge was built under contract in 1920 by the Colonial Building Company. Total length is 222 feet. It consists of one 22-foot span and five 40-foot spans. At one time Arthur Seufert kept the bridge lit with direct current from a Pelton wheel which he operated in connection with Seufert Brothers Cannery.

SOURCES: Wasco County Historical Inventory Form, 1988 (Gladys Seufert, recorder; Gladys Seufert and Francis Seufert, sources); ODOT, *Historic Highway Bridges of Oregon*; Wasco County Road Department, File #308 Dam View Road construction drawings

NEGATIVE NO.: Roll 2, nos. 20, 21
FIELD NO.: 119
SHPO INVENTORY NO.: 200

UPDATED BY: Donovan and Associates
DATE: January/February 1994

OREGON INVENTORY OF HISTORIC PROPERTIES
HISTORIC RESOURCE INVENTORY FORM
COUNTY: WASCO COUNTY

HISTORIC NAME: Seufert Viaduct

LEGAL DESCRIPTION: T2N R14E S31

ADDRESS: East of The Dalles along the State Road



NEGATIVE NO: Roll 2 #20

PHOTO SOURCE: Donovan and Associates

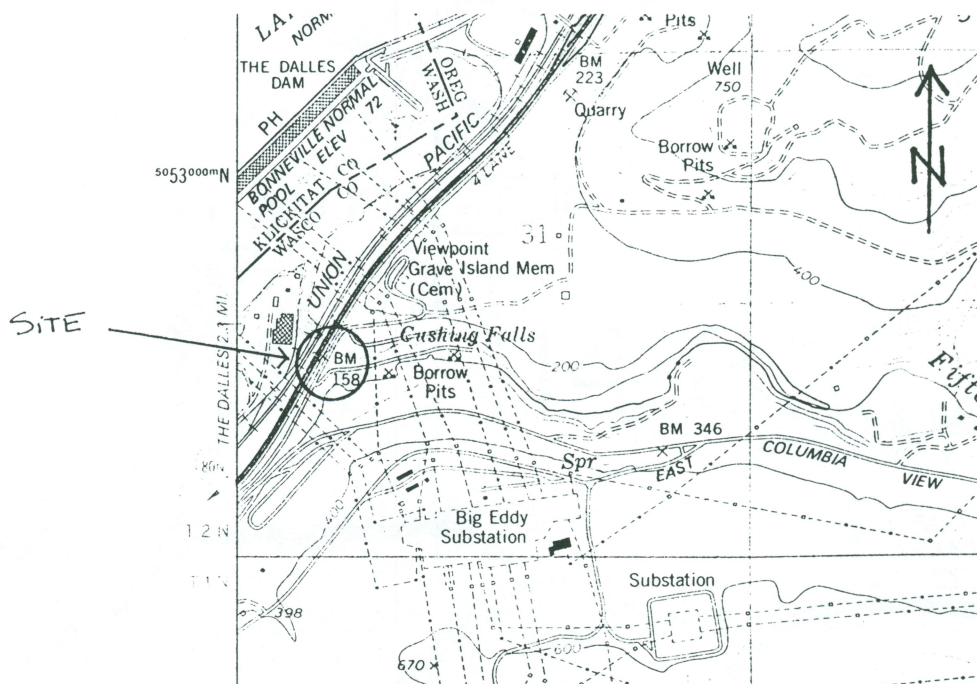

SHPO INVENTORY NO.: 200

FIELD NO: 119