

CITY OF LAKE OSWEGO
CULTURAL RESOURCES INVENTORY
FIELD FORM 1988-1989

HIST. NAME: Janzen Estate
DATE OF CONSTRUCTION: 1930
COMMON NAME: Halvorson House
ORIGINAL USE: Residence
ADDRESS: 1850 North Shore Road
OWNER: Gerald and Susan Stubblefield
PRESENT USE: Residence
ARCH./BLDR.: Charles Ertz
T/R/S: 2S 1E 9AC
TAX LOT: 1500

STYLE: English
Cottage
RESOURCE TYPE:
Building
THEME:
Architecture;
Commerce
ADDITION: Forest
Hills, Plat 3
BLOCK:
LOT: 188-194
QUAD: Lake Oswego
LOT SIZE: Approx. 4
Ac
ZONE: R-10

PLAN TYPE/SHAPE: Asymmetrical
NO. OF STORIES: 1 1/2
FOUNDATION MATERIAL: Concrete
BASEMENT: Unknown
ROOF FORM & MATERIALS: Multiple hip

WALL CONSTRUCTION: Masonry
STRUCTURAL FRAME: Unknown
PRIMARY WINDOW TYPE: Multi-light casement
EXTERIOR SURFACING MATERIALS: Coursed stone
DECORATIVE FEATURES: Two massive multi-flue chimneys; mock
half-timbering; polygonal window bays

OTHER: Hipped dormers; main entrance w/ wood lintel and
ornamental door

CONDITION: Good

EXTERIOR ALTERATIONS/ADDITIONS: Stone terraces and paths
added, 1989

NOTEWORTHY LANDSCAPE FEATURES: Mature deciduous and
coniferous trees; ornamental plant materials

ASSOCIATED STRUCTURES: Boat house and bridge; non-historic
garage and gazebo

SETTING: Located on an island in Oswego Lake; entered from
driveway over historic bridge from North Shore Road; in area
of mid-20th century residences.

NOTES:

RECORDER(S): Morrison

DATE: August, 1989

SHPO #: 1823

FIELD #:

CITY OF LAKE OSWEGO CULTURAL RESOURCES INVENTORY

ADDRESS 1850 NORTH SHORE ROAD
TAX MAP/LOT 2S 1E 9AC/1500
SHPO# 1823 ROLL/FRAME# _____

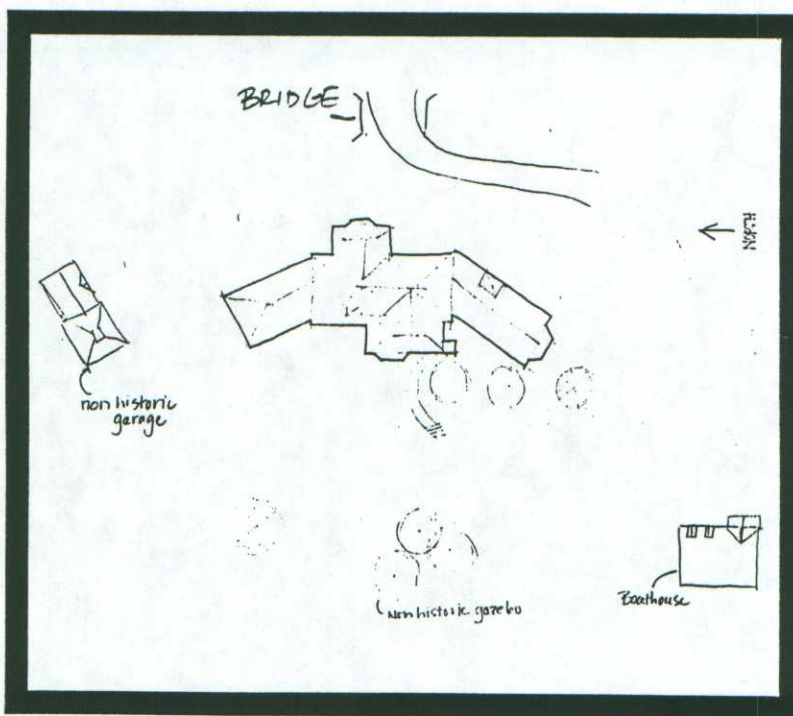

DATE: 1989

1823

CITY OF LAKE OSWEGO
CULTURAL RESOURCES INVENTORY
FIELD FORM 1988-1989

HIST. NAME: Jantzen, Carl, Boat House
DATE OF CONSTRUCTION: 1933
COMMON NAME: Jantzen Boat House
ORIGINAL USE: Boat house
ADDRESS: 1850 North Shore Road
OWNER: Stubblefield, Jerry & Susan
PRESENT USE: Boat house
ARCH./BLDR.: Richard Sundeleaf
T/R/S: 2S 1E 9AC
TAX LOT: 1500

STYLE: Gothic
RESOURCE TYPE:
Structure
THEME: Architecture
ADDITION: Forest
Hills Plat 3
BLOCK:
LOT: 189
QUAD: Lake Oswego
LOT SIZE:
ZONE: R-10

PLAN TYPE/SHAPE: L-Shaped
NO. OF STORIES: 1
FOUNDATION MATERIAL: Stone
BASEMENT: N/A
ROOF FORM & MATERIALS: Gable roof with round tower, slate shingles, dormer vents

WALL CONSTRUCTION: Stone
STRUCTURAL FRAME: Stone, wood rafters
PRIMARY WINDOW TYPE: Fixed
EXTERIOR SURFACING MATERIALS: Stone
DECORATIVE FEATURES: Iron gate, tower with vents

OTHER:
CONDITION: Unknown
EXTERIOR ALTERATIONS/ADDITIONS: None apparent
NOTEWORTHY LANDSCAPE FEATURES: Swimming dock, stone fireplace
ASSOCIATED STRUCTURES: See House and bridge

SETTING: On Jantzen Island facing onto Main lake
NOTES:

RECORDER(S): Mackenzie, Koler/Morrison DATE: February 1989
SHPO #: 1824 FIELD #:

1824

CITY OF LAKE OSWEGO CULTURAL RESOURCES INVENTORY

ADDRESS JANIZEN BOAT HOUSE (1850 NORTH SHORE ROAD)
TAX MAP/LOT 2S 1E 9AC/1500
SHPO# 1824 ROLL/FRAME# _____



SEE 1850 NA SHORE

DATE: AUG 1989

1824

STATEMENT OF SIGNIFICANCE

Address: 1850 North Shore Road
Historic Name: Jantzen, Carl, Estate

This island site was originally called Crazy Man's Island by early settlers. They chose this label because a mute hermit lived here and they concluded he was crazy. For several years after he was gone the land remained vacant. In 1929 Carl C. and Emma Jantzen purchased the five-acre parcel from Oregon Iron and Steel. Jantzen helped found Jantzen Knitwear, an internationally known garment manufacturer. The second owner of the property was Harry K. Coffey who, according to deed records, purchased the house in 1952, although his place of residence is listed on North Shore as early as 1947-48 according to the Clackamas County Directory. Coffey worked as an insurance agent for Mutual Benefit Health and Accident Association. (Coffey was the original owner of 408 Edgecliff, in the residential area north of the city limits.) Carl and Virginia Halvorsen, the longest owners of record, purchased the property in 1956.

Jantzen commissioned Ertz and Burns Architects to design the English country-style showplace which was completed in 1936. One of Jantzen's more flamboyant activities was to entertain large gatherings of people at his home with water-ski fashion showings of the bathing attire his company manufactured.

The 9,443 square foot house sits on a knoll facing the lake. Outbuildings include a Gothic style boathouse with half-bath, as well as equipment and garden sheds. A private bridge with hand-hewn logs, stone arches with turrets, and a wrought-iron gate leads from the mainland to a driveway that winds across the island to the three-car garage and residence. The boathouse and bridge were designed by prominent, local architect Richard Sundleaf.

The Estate is significant for its architectural elements, as well as for its association with Jantzen and Coffey.

Bibliography: Oregonian, "Oswego Lake's Island Home Sells For \$1.5 Million," 7/15/87.
Oregon's Iron Dream, Mary Goodall, 1958.
Stubblefield, Susan. Unrecorded interview w/ J. Heisler and J. Morrison, 4/89.
Ticor Title Company, Oregon City, OR.