

**CITY OF SHERIDAN INVENTORY OF HISTORIC PROPERTIES  
HISTORIC RESOURCE SURVEY FORM**

Name : Savage House  
Address: 147 NE Yamhill Street  
Resource #: 133

T/R/S: T 5 S., R.6 W. Sec. 35  
Map No.: 5 6 35BA Tax Lot: 5700  
Quadrangle: USGS Sheridan 7.5'

**Statement of Historical and Architectural Significance:**

The Savage House was placed on the National Register of Historic Places in 1982. Constructed in 1892, the house is in excellent condition and is one of the most recognized residences in Sheridan.

William Savage was born in Mexico, New York in 1826. He moved to Indiana and Missouri before emigrating to Oregon. He took a Donation Land Claim in 1847 in Polk County. He traveled to California for the gold rush, returned to Oregon to farm until 1867. Savage then ventured to Texas to drive cattle. In 1891 he established the Dallas City Bank and served as its president until he died in 1896. Savage married Sarah Brown[b. 1839 in Illinois] and they had eight children. In 1900 Sarah was operating a hotel out of the house.

Future ownership of the property is harder to follow, as Austin Savage, a son of Sarah and William, was living on Yamhill Street in 1910. Living next door was Joseph R. Mendenhall, who would later own the house. It is hard to determine which family was living in the house in 1910 by census records alone.

By 1920, Joe Mendenhall[b. 1841 in Tennessee], his wife Lucy[b. 1874 in Iowa], their son Frank and a boarder were living in the house. Lucy ran a hotel out of the house and Frank was attending college in 1920. The boarder, Isaac Daugherty, was serving as mayor of Sheridan in 1920. Daugherty was born in Iowa in 1853.

This vernacular interpretation of the Queen Anne style was constructed in 1892. It was run as a hotel for many years. The house is in good condition, with many Queen Anne decorative elements intact. The gable peak spindlework along with the original siding and windows are still extant. Simple versions of high style houses often appeared in small Oregon towns throughout the historic period. This house is a prime example of this, and as such, has been listed on the National Register of Historic Places.

Sources: Beckham, Statewide Inventory of Historic Sites and Buildings, 1976.  
US Census Bureau, 1900.  
US Census Bureau, 1910.  
US Census Bureau, 1920.

SHP#1668

**CITY OF SHERIDAN INVENTORY OF HISTORIC PROPERTIES  
HISTORIC RESOURCE SURVEY FORM**

**Name :** Savage House  
**Address:** 147 NE Yamhill Street  
**Resource #:** 133

**T/R/S:** T 5 S., R.6 W. Sec. 35  
**Map No.:** 5 6 35BA **Tax Lot:** 5700  
**Quadrangle:** USGS Sheridan 7.5'

\*\*\*\*\*



\*\*\*\*\*

**Negative No.:** Roll

**Slide No. :**

\*\*\*\*\*

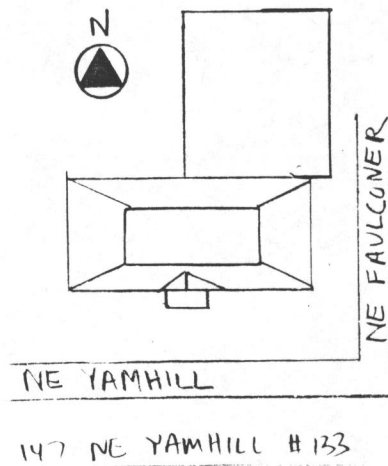
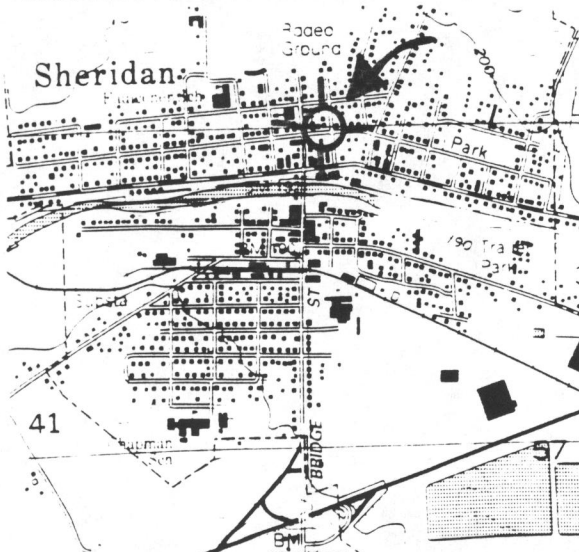

\*\*\*\*\*

**Graphic and Photo Sources:** Peter J. Edwards *CHR*

**SHPO Inventory No.:** 166B

**CITY OF SHERIDAN INVENTORY OF HISTORIC PROPERTIES  
HISTORIC RESOURCE SURVEY FORM  
YAMHILL COUNTY, OREGON**

**Historic Name:** William Savage House  
**Common Name:** Savage-Mendenhall-Seth House  
**Address:** 147 NE Yamhill Street  
**City:** Sheridan  
**Zoning:**  
**T/R/S:** T. 5S., R. 6 W. Sec. 35  
**Map No.:** 5 6 35 CA      **Tax Lot:** 5700  
**Addition:** Faulconer's Original Survey  
**Block:** 6      **Lot:** 8      **Quad:** USGS Sheridan 7.5'

**Date of Construction:** 1892  
**Original Use:** Hotel/Boarding House  
**Present Use:** Residence  
**Architect:**  
**Builder:**  
**Theme:** Culture: 19th C. Architecture  
**Style:** Queen Anne

**Building**  **Structure**  **Site**

**Plan Type/Shape:** Rectangular  
**Foundation Material:** Unknown  
**Roof Form and Materials:** with composition shingles  
**Wall Construction:** Wood  
**Primary Window Type:** 1/1 DHS  
**Exterior Surfacing Materials:** Shiplap with cornerboards  
**Decorative Features:** Decorative colored glass panes on S elevation; frieze; spindlework in gable end; turned posts; balustrade  
**Other :** Flat roof porch on S elevation  
**Condition:** Good  Fair  Poor  Moved \_\_\_\_ (Date):  
**Integrity:** Virtually Intact  Minor Alterations  Major Alterations

**Number of Stories:** 2  
**Basement (Y/N):** N  
**Structural Frame:** Stud

**Exterior Alterations/Additions (Dated):**

**Noteworthy Landscape Features:**

**Associated Structures:**

**Known Archaeological Features:**

**Setting:** The Savage House is located on the NW corner of Yamhill and Faulconer Streets. It is located in a prominent setting just one block north of Main Street, which is the busiest street in Sheridan.

**Negative No.:**  
**Slide No.:**

**Recorded By:** Peter J. Edwards, *Columbia Historical Research*  
**Date:** April 1994

**Resource #:** 133

**SHPO Inventory No.:** 1668

STATE OF OREGON INVENTORY  
HISTORIC SITES AND BUILDINGS  
State Historic Preservation Office  
Oregon State Parks, Salem, 97310



County Yamhill  
Theme 10-A  
Name  
(Common) Savage (William) House  
(Historic) (same)  
Address 147 N.E. Yamhill  
Sheridan, Ore.  
Present Owner Greg Dennis  
(Address) 147 N.E. Yamhill, Sheridan, Ore.  
Original Use Residence  
Date of Construction c. 1886

Physical

historical significance:

William Savage was born in Mexico, New York, on September 18, 1826. At the age of seventeen he moved to Indiana and in 1844 located in Missouri. In 1845 Savage journeyed overland to Oregon with John Ramage. In 1847 he took a Donation Land Claim in Polk County. He went to the California gold rush, returned to farm his land until 1867, then went to Texas to drive cattle to Montana. In 1891 Savage established the Dallas City Bank and served as its president until his death on Sept. 20, 1896. He married in 1852 to Sarah Brown, the daughter of James Brown who emigrated overland to Oregon in 1850. The Savages had eight children. He married Mary Lady in 1883 and had two additional children.

The house is a simple, two story, rectangular structure with elements of Queen Anne Style. It has colored glass panes surrounding the windows in its south (front) elevation. The house has a slightly disproportionate detailing on its eaves and has horizontal siding. It is well-maintained.

In the years prior to World War II this residence was known as the Emma (Ridgeway) Seth house.

Continue back if necessary

Recorded by Stephen Dow Beckham Date 10 Mar. 1976 Sources Consulted:

For Oregon State Historic Preservation Office

"William Savage." Portrait and Biographical Record of Willamette Valley, Oregon

Please enclose map Township 5 <sup>N</sup> <sub>S</sub> Range 6 <sup>E</sup> <sub>W</sub> Section 35

Chicago: Chapman Publishing Co., 1903,  
pp. 656-59.

(over)

48